

HIGH VOLTAGE DC RELAY

EVR-30



▶ 코일정격 (Magnet coil ratings)

| Nominal voltage(V) | Item | Nominal Coil current (mA) | Coil resistance (Ω) | Pick-up voltage (V)max. | Drop-out voltage (V)min. | Max. voltage (V)max. | Coil power(W) dissipation |
|--------------------|------|---------------------------|---------------------|-------------------------|--------------------------|----------------------|---------------------------|
| DC | 110 | 29 | 3,750 | 75% | 10% | 130% | 3 ~ 3.5 |
| | 72 | 45 | 1,600 | | | | |
| | 60 | 54 | 1,120 | | | | |
| | 48 | 66 | 730 | | | | |
| | 36 | 90 | 400 | | | | |
| | 24 | 133 | 180 | | | | |
| | 12 | 267 | 45 | | | | |
| | 6 | 545 | 11 | | | | |

- Notes : 1. Nominal current and coil resistance are measured at +20°C.
 2. Differences of coil resistance are ±10%.
 3. Performance characteristic coil temperature is measured at +20°C.

▶ 접점정격 (Contact ratings)

(450VDC기준)

| Item | Type | 1Pole Resistive load (L/R≤1ms) |
|--|------|--------------------------------|
| | | EVR30 |
| Max. switching current (wire size 6.0mm ²) | | 30A |
| Max. switching capacity | | 1200VDC 6A |
| Contact rating switching voltages | | 450VDC |
| Max. contact performance (wire size 6.0mm ²) | | 90A 30Sec. |
| | | 150A 10Sec. |
| Voltage drop across contacts per 30A | | 0.15V max. |
| Min. permissible load | | 12V DC 0.5A |
| Description | | S,P On/Off, (1a) |

▶ 주문방법 (Ordering information)

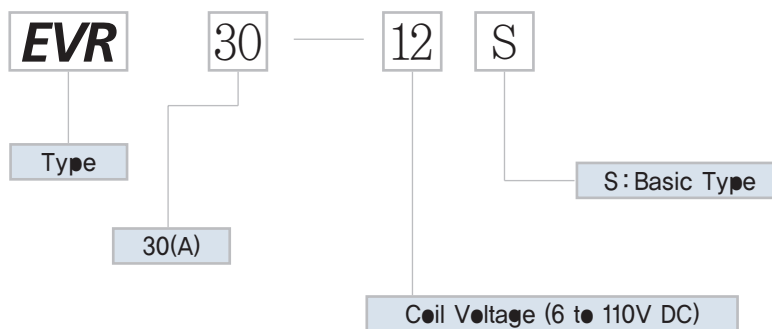

HIGH VOLTAGE DC RELAY

EVR-30



EVR30

▶ 성능 (Characteristics)

| | | |
|--|---------------------------|--------------------------------------|
| Initial insulation resistance | | Min. 100M Ω 500V DC |
| Expected life | Mechanical (Min.) | |
| | Electric (L/R \leq 1ms) | 450V DC 30A |
| | | 250V DC 30A |
| Initial breakdown voltage | Between open contacts | 2500V AC 1Min. 10mA |
| | Between contacts & coil | 2500V AC 1Min. 10mA |
| Operate time (at 20 $^{\circ}$ C) | | Max. 20ms |
| Release time (at 20 $^{\circ}$ C) | | Max. 5ms |
| Shock resistance | Functional | Min 196 % {20G},(10 μ s) |
| | Destructive | Min 490 % {50G} |
| Vibration resistance | Functional | 43 % {4.4G} 10 to 200Hz,(10 μ s) |
| | Destructive | 43 % {4.4G} 10 to 200Hz |
| Conditions for operation transport and storage | Ambient temperature | -40 $^{\circ}$ C to +85 $^{\circ}$ C |
| | Humidity | 5 to 85% R.H. |
| Unit weight | | 105g |

▶ 특성곡선 (Reference data)

- 온도상승곡선
- 통전시간의 최대치 Max, Current capacity
Max, Continous thermal current rating (amperes)

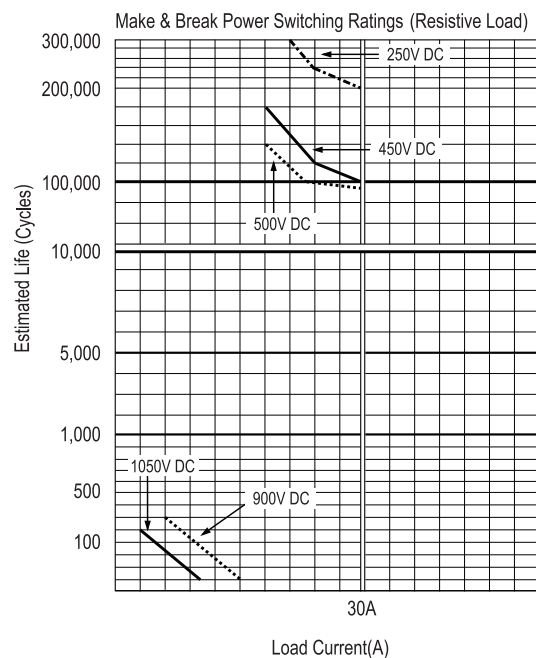
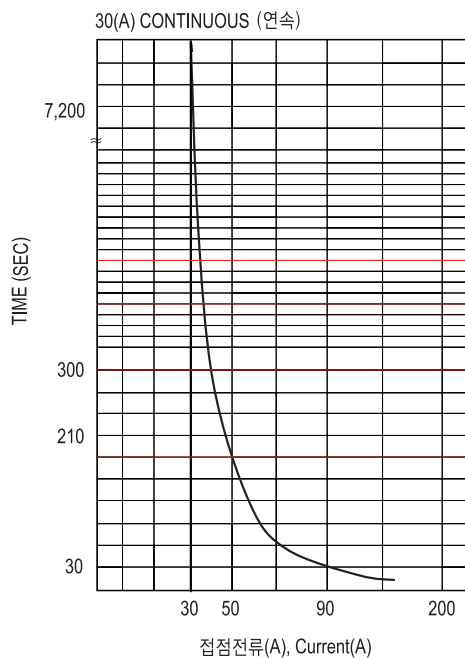

HIGH VOLTAGE DC RELAY

EVR-30



▶ 외형치수도 (Dimension in mm)

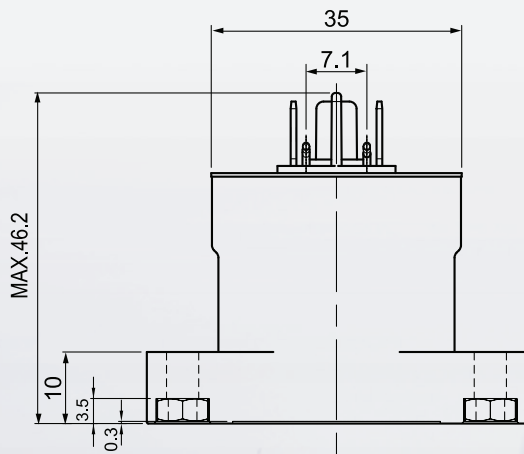
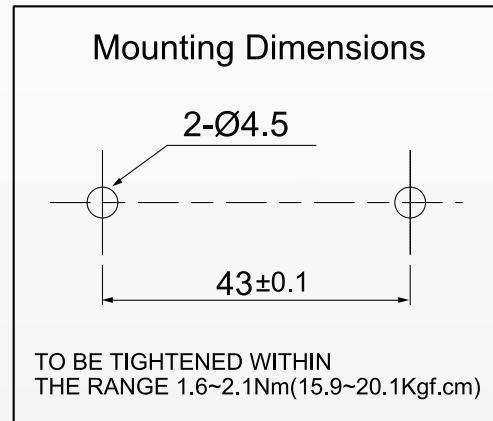
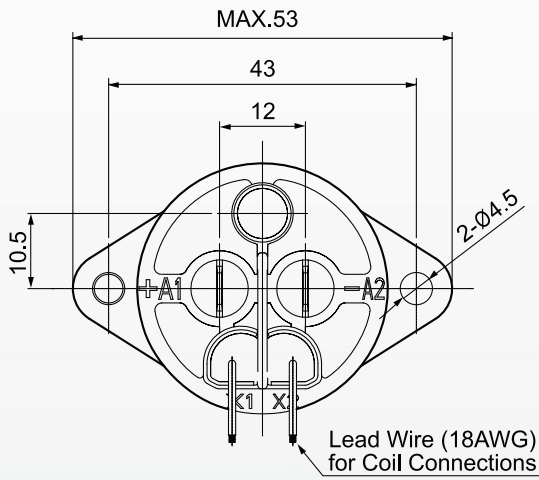

6.25mm SPADE MAIN TERMINALS

