

Data Sheet

Customer: _____

Product: SMD Aluminum Electrolytic Capacitors – EZV Series _____

Size : 4x5.5mm ~ 18x21.5mm _____

Issued Date: 07-Sep.-2017 _____

Edition: Ver. 2 _____

Record of change

Date	Ver.	Description	Page
15-May-2016	1		
07-Sep-2017	2	Added size G on some items	2

HITANO ENTERPRISE CORP.

7F-7, No. 3, Wu Chuan 1st Road, New Taipei Industrial Park,

New Taipei City, TAIWAN, R.O.C.

Tel: +886 2 2299 1331 (Rep.)

Fax: +886 2 2298 2466, 2298 2969

Prepared by	Checked by	Approved by	Accepted by (customer)
15-May-2016	15-May-2016	15-May-2016	
<i>Andy Hsu</i>	<i>Hwa Wu</i>	<i>Hwa Wu</i>	

- SMD Low Impedance Type. Reflow Soldering is available.
- 4~18φ, 105°C, 2000 ~ 5000 hours load life., Rohs compliant
- Available For High Density Mounting

Characteristics

Voltage Range	6.3 to 100 VDC								
Capacitance Range	1.0 to 6800uF								
Temperature Range	-55 to +105°C								
Capacitance Tolerance	+/-20% (at 20°C, 120Hz)								
Leakage Current	I≤0.01CV or 3uA, whichever is greater, 2 minutes after Rated Voltage applied, where C = Rated Capacitance, V = Rated DC working voltage								
Dissipation Factor (tanδ) Max (at 20°C, 120Hz)	Rated Voltage (V)	6.3	10	16	25	35	50	63	100
	D.F.(tanδ)	0.30	0.26	0.22	0.16	0.13	0.10	0.08	0.07
Stability at Low Temperature (at 120Hz)	Rated Voltage (V)	6.3	10	16	25	35	50	63	100
	Z-25°C/Z 20°C	4	3	2	2	2	2	2	2
	Z-55°C/Z 20°C	8	5	4	3	3	3	3	3
Load Life After the rated voltage has been applied for 2000~5000 hours at 105°C	2000hrs for D ≤ 6.3mm, 5000hrs for D ≥ 8mm	Capacitance change			Within ±30% of initial value				
		D.F. (tanδ)			300% or less of initial specified value				
		Leakage current			Less than initial specified value				
Shelf Life	After storage for 1000 hours at 105°C, with no voltage applied and being stabilized at +20°C, Capacitor shall meet the limit specified in load life.								

Diagram of dimensions

SIZE	Dφ	L	A	B	C	W	P±0.2
A	4	5.5±0.2	4.3	4.3	5.1	0.5~0.8	1.0
B	5	5.5±0.2	5.3	5.3	5.9	0.5~0.8	1.5
C	6.3	5.5±0.2	6.6	6.6	7.2	0.5~0.8	2.0
C8	6.3	7.7±0.3	6.6	6.6	7.2	0.5~0.8	2.0
D	8	6.5±0.3	8.4	8.4	9.0	0.5~0.8	2.3
E	8	10.5±0.3	8.4	8.4	9.0	0.7~1.1	3.1
F	10	10.5±0.3	10.4	10.4	11.0	0.7~1.3	4.5
G	12.5	14±0.3	13.5	13.5	15.0	1.1~1.4	4.5
H	12.5	16±0.3	13.0	13.0	15.0	1.1~1.4	4.5
I	16	16.5±0.5	17.0	17.0	18.0	1.1~1.4	6.4
J	16	21.5±0.5	17.0	17.0	18.0	1.1~1.4	6.4
K	18	16.5±0.5	19.0	19.0	20.0	1.1~1.4	6.4
L	18	21.5±0.5	19.0	19.0	20.0	1.1~1.4	6.4

Size A~F refer to Fig. 1

Size G~L refer to Fig. 2

Fig. 1

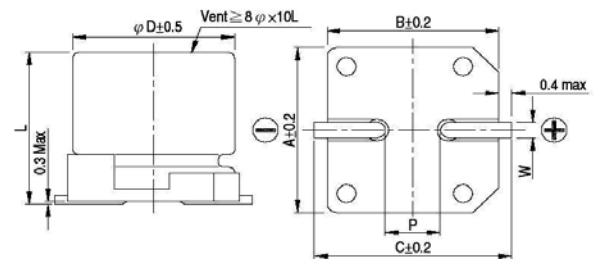
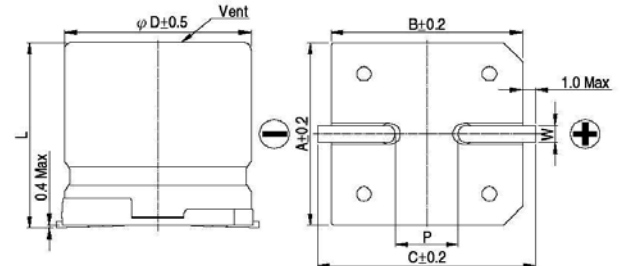

Fig. 2



Multiplier for Ripple Current vs Frequency

Frequency(Hz)	60(50)	120	1K	≥10K
Multiplier	0.60	0.70	0.85	1.00

Part Numbering System

EZV □ □ □ □ □ □ R □
Series Capacitance Tolerance Rated Voltage Package Case Size

