

PRIMARY CHARACTERISTICS	
V_{RRM}	40V,45V,60V,100V
I_O	5A
V_F	0.45V,0.55V,0.75V
$T_{J,Max}$	150°C

SMAF PACKAGE

Marking :

5L40,5L45,5L60,5L100



Ex : FM5L60-AHS



Pin1 cathode
Pin2 anode



FEATURES

- High current density schottky
- Very low profile typical height of 1.0 mm
- Ideal for automated placement
- Low power loss high efficiency
- Low forward voltage drop
- Moisture Sensitivity Level 1

MECHANICAL DATA

- Case : Molded plastic,SMAF
- Polarity : Shown above
- Terminals :Plated terminals, solderable per MIL-STD-750,Method 2026
- Epoxy : UL94-V0 rated flame retardant

MAXIMUM RATINGS (At TA = 25°C unless otherwise noted)

RATINGS	SYMBOL	FM5L40-AHS	FM5L45-AHS	FM5L60-AHS	FM5L100-AHS	UNITS
Maximum Recurrent Peak Reverse Voltage	V_{RRM}	40	45	60	100	Volts
Maximum RMS Volts	V_{RMS}	28	31.5	42	70	Volts
Maximum DC Blocking Voltage	V_{DC}	40	45	60	100	Volts
Maximum Average Forward Current	I_O	5.0				Amps
Non-repetitive peak forward surge current 1.0ms square-wave	I_{FSM}	150				Amps
Typical Thermal Resistance (Note 1)	$R_{\theta JA}$	63				°C/W
	$R_{\theta JC}$	33				
Operating Storage Temperature Range	T_J	-55~125		-55~150		°C
Storage Temperature Range	T_{STG}	-55~150				°C

ELECTRICAL CHARACTERISTICS (At TA = 25°C unless otherwise noted)

CHARACTERISTICS	SYMBOL	FM5L40-AHS	FM5L45-AHS	FM5L60-AHS	FM5L100-AHS	UNITS
Marking Code		5L40	5L45	5L60	5L100	
Maximum Forward Voltage at 5.0A DC	V_F	0.45		0.55	0.75	Volts
Maximum reverse leakage current at rated VR	@Tj = 25°C	0.5				mAmps
	@Tj = 100°C	20				

Notes: 1. Mounted on FR-4 PCB Copper, minimum recommended pad layout

Rating and characteristic curves

FIG.1-TYPICAL FORWARD CURRENT DERATING CURVE

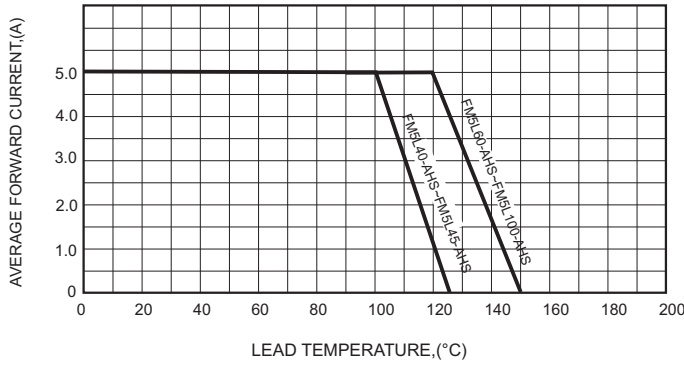

FIG.2-TYPICAL FORWARD CHARACTERISTICS

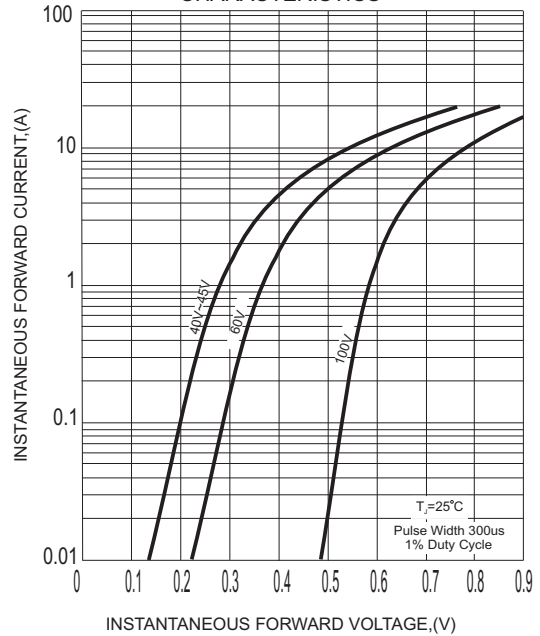

FIG.3-MAXIMUM NON-REPETITIVE FORWARD SURGE CURRENT

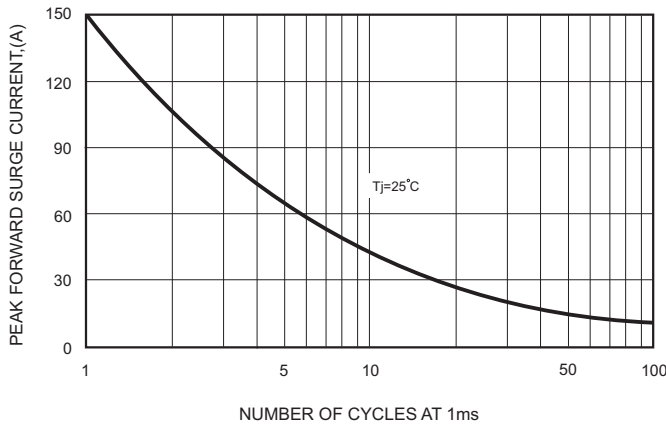
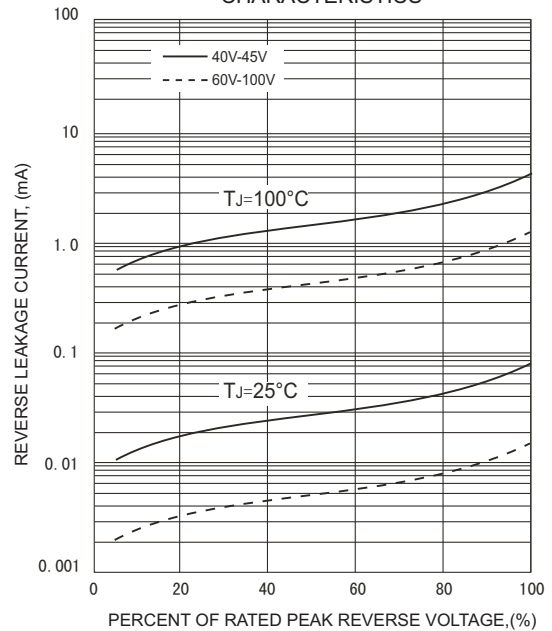
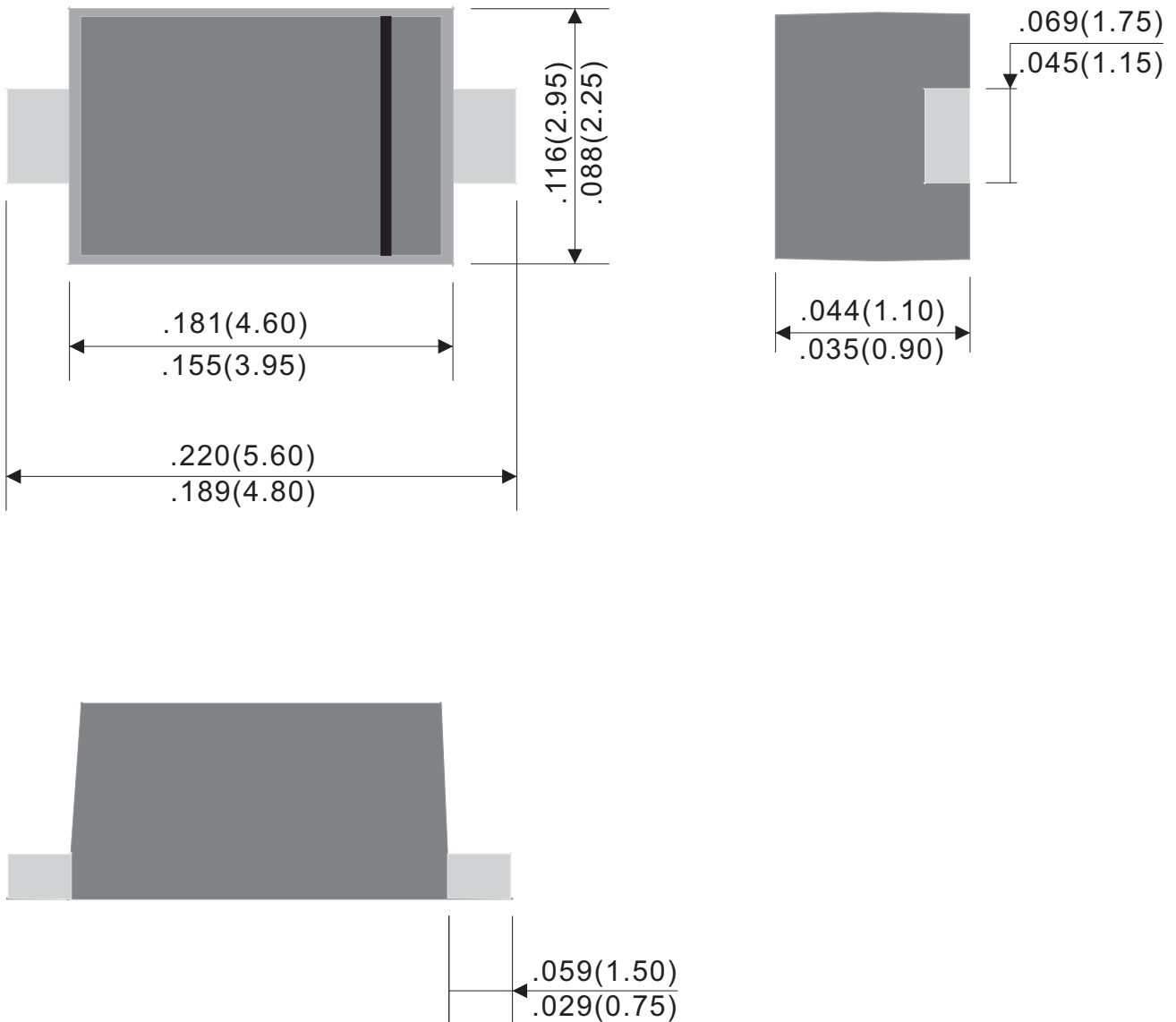

FIG.4 - TYPICAL REVERSE CHARACTERISTICS



Outline Drawing

SMAF(DO-221AC)



Dimensions in inches and (millimeters)

Rev.B

Packing information

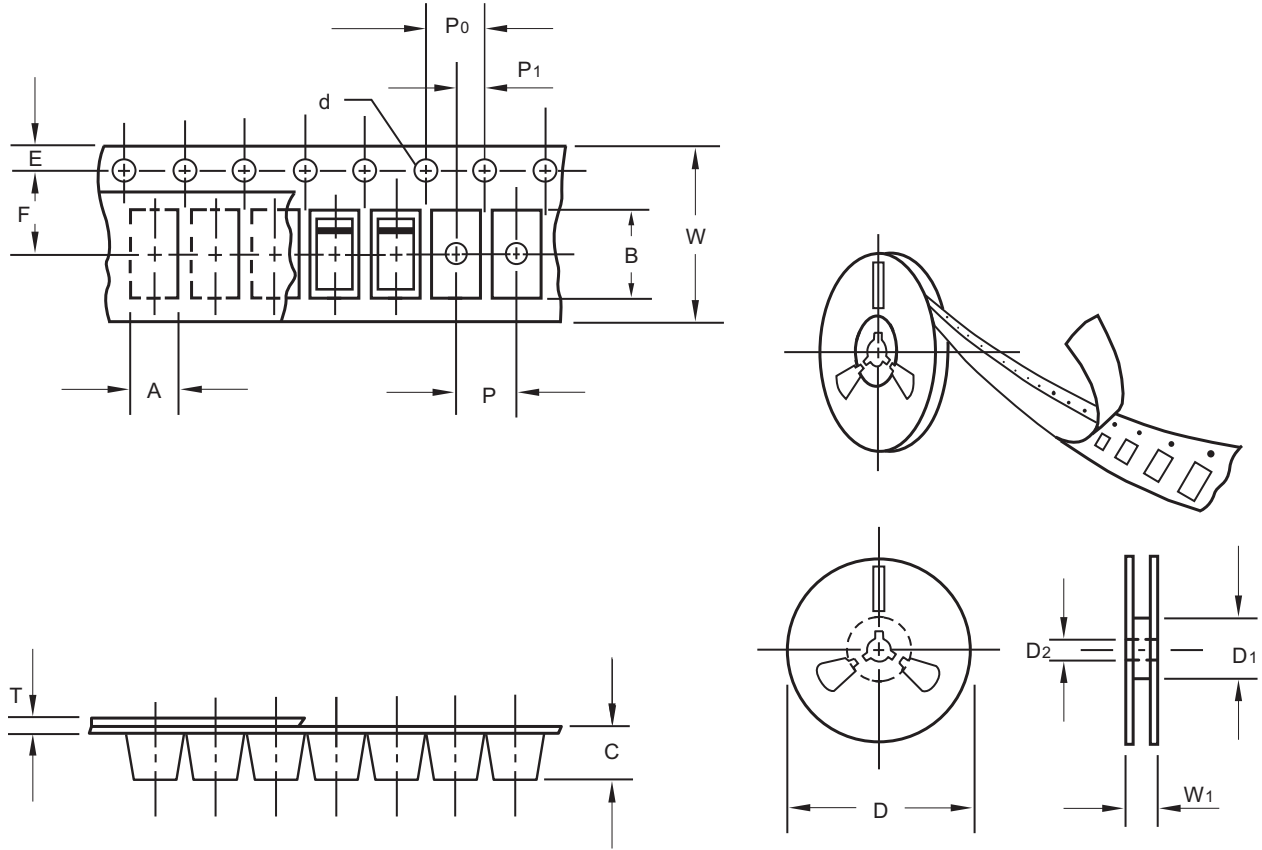

unit:mm

Item	Symbol	Tolerance	SMA-HS
Carrier width	A	0.1	3.00
Carrier length	B	0.1	5.50
Carrier depth	C	0.1	1.20
Sprocket hole	d	0.1	1.50
13" Reel outside diameter	D	2.0	330.00
13" Reel inner diameter	D ₁	min	50.00
7" Reel outside diameter	D	2.0	178.00
7" Reel inner diameter	D ₁	min	62.00
Feed hole diameter	D ₂	0.5	13.00
Sprocket hole position	E	0.1	1.75
Punch hole position	F	0.1	5.50
Punch hole pitch	P	0.1	4.00
Sprocket hole pitch	P ₀	0.1	4.00
Embossment center	P ₁	0.1	2.00
Overall tape thickness	T	0.1	0.25
Tape width	W	0.3	12.00
Reel width	W ₁	1.0	11.40

Note: Devices are packed in accordance with EIA standard RS-481-A and specifications listed above.

Ordering Information:

Device PN	Packing
Part Number -T ⁽¹⁾ H ⁽²⁾ -WS	Tape&Reel: 3 Kpcs/Reel

Note: (1) Packing code, Tape & Reel Packing

(2) Halogen free product for packing code suffix "H"

*****Disclaimer*****

WILLAS reserves the right to make changes without notice to any product specification herein, to make corrections, modifications, enhancements or other changes. WILLAS or anyone on its behalf assumes no responsibility or liability for any errors or inaccuracies. Data sheet specifications and its information contained are intended to provide a product description only. "Typical" parameters which may be included on WILLAS data sheets and/ or specifications can and do vary in different applications and actual performance may vary over time. WILLAS does not assume any liability arising out of the application or use of any product or circuit.

This is the preliminary specification. WILLAS products are not designed, intended or authorized for use in medical, life-saving implant or other applications intended for life-sustaining or other related applications where a failure or malfunction of component or circuitry may directly or indirectly cause injury or threaten a life without expressed written approval of WILLAS. Customers using or selling WILLAS components for use in such applications do so at their own risk and shall agree to fully indemnify WILLAS Inc and its subsidiaries harmless against all claims, damages and expenditures.