

# InGaAs PIN photodiodes

G12181 series

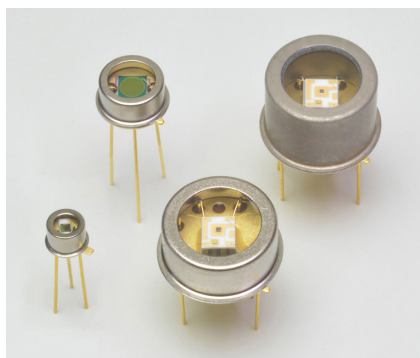

**Long wavelength type  
(cutoff wavelength: 1.85 to 1.9 μm)**

## Features

- Cutoff wavelength: 1.85 to 1.9 μm
- Low cost
- Photosensitive area: φ0.3 to φ3 mm
- Low noise
- High sensitivity
- High reliability
- High-speed response

## Applications

- Optical power meters
- Gas analyzers
- Moisture meters
- NIR (near infrared) photometry

## Options

- Amplifier for InGaAs PIN photodiode **C4159-03**
- Heatsink for one-stage TE-cooled type **A3179**
- Heatsink for two-stage TE-cooled type **A3179-01**
- Temperature controller for TE-cooled type **C1103-04**

## Structure

Type no.	Dimensional outline /Window material*1	Package	Cooling	Photosensitive area (mm)
G12181-003K	(1)/K	TO-18	Non-cooled	φ0.3
G12181-005K				φ0.5
G12181-010K				φ1
G12181-020K	(2)/K	TO-5		φ2
G12181-030K				φ3
G12181-103K				One-stage TE-cooled
G12181-105K	φ0.5			
G12181-110K	(3)/K	TO-8	φ1	
G12181-120K			φ2	
G12181-130K			φ3	
G12181-203K	(4)/K	TO-8	Two-stage TE-cooled	
G12181-205K				φ0.5
G12181-210K				φ1
G12181-220K				φ2
G12181-230K				φ3

\*1: K=Borosilicate glass

The G12181 series may be destroyed or deteriorated by electrostatic discharge, etc. Be carefull when using the G12181 series.

### ▣ Absolute maximum ratings (Ta=25 °C, unless otherwise noted)

Type no.	Thermister power dissipation Pd_th (mW)	TE-cooler allowable current ITE max (A)	TE-cooler allowable voltage VTE max (V)	Reverse voltage VR max (V)	Operating temperature*2 Topr (°C)	Storage temperature*2 Tstg (°C)
G12181-003K	-	-	-	-	-40 to +85	-55 to +125
G12181-005K						
G12181-010K						
G12181-020K						
G12181-030K						
G12181-103K	0.2	1.5	1.0	1	-40 to +70*3	-55 to +85
G12181-105K						
G12181-110K						
G12181-120K						
G12181-130K						
G12181-203K		1.0	1.2			
G12181-205K						
G12181-210K						
G12181-220K						
G12181-230K						

\*2: No dew condensation

When there is a temperature difference between a product and the surrounding area in high humidity environments, dew condensation may occur on the product surface. Dew condensation on the product may cause deterioration in characteristics and reliability.

\*3: Chip temperature and package temperature

Note: Exceeding the absolute maximum ratings even momentarily may cause a drop in product quality. Always be sure to use the product within the absolute maximum ratings.

### ▣ Electrical and optical characteristics (Typ. unless otherwise noted)

Type no.	Measurement Condition	Thermistor resistance (+25 °C) Rth (kΩ)	Thermistor B constant (-20/+25 °C) B (K)	Spectral response range λ (μm)	Peak sensitivity wavelength λp (μm)	Photo sensitivity S λ=λp		Dark current ID VR=0.5 V		Temp. coefficient of ID VR=0.5 V (times/°C)	
	Element temperature Tchip (°C)					Min. (A/W)	Typ. (A/W)	Typ. (nA)	Max. (nA)		
G12181-003K	25	-	-	0.9 to 1.9				1	10	1.07	
G12181-005K								3	30		
G12181-010K								10	100		
G12181-020K								50	500		
G12181-030K								100	1000		
G12181-103K	-10	9.0	3300	0.9 to 1.87	1.75	0.9	1.1	0.1	1		
G12181-105K								0.3	3		
G12181-110K								1	10		
G12181-120K								5	50		
G12181-130K								10	100		
G12181-203K	-20					0.9 to 1.85				0.05	0.5
G12181-205K										0.15	1.5
G12181-210K										0.5	5
G12181-220K										2.5	25
G12181-230K										5	50

Type no.	Measurement Condition	Cutoff frequency fc		Terminal capacitance Ct		Shunt resistance Rsh		Detectivity D*		Noise equivalent power NEP	
	Element temperature	VR=0 V RL=50 Ω		VR=0 V f=1 MHz		VR=10 mV		λ=λp		λ=λp	
	Tchip (°C)	Min. (MHz)	Typ. (MHz)	Typ. (pF)	Max. (pF)	Min. (MΩ)	Typ. (MΩ)	Min. (cm·Hz <sup>1/2</sup> /W)	Typ. (cm·Hz <sup>1/2</sup> /W)	Typ. (W/Hz <sup>1/2</sup> )	Max. (W/Hz <sup>1/2</sup> )
G12181-003K	25	40	90	25	50	10	50	3 × 10 <sup>11</sup>	1 × 10 <sup>12</sup>	2 × 10 <sup>-14</sup>	5 × 10 <sup>-14</sup>
G12181-005K		15	35	70	150	4	20			3 × 10 <sup>-14</sup>	8.5 × 10 <sup>-14</sup>
G12181-010K		5	10	230	500	1	5			6 × 10 <sup>-14</sup>	2 × 10 <sup>-13</sup>
G12181-020K		1.2	2.5	1000	2000	0.2	1			1.5 × 10 <sup>-13</sup>	4 × 10 <sup>-13</sup>
G12181-030K		1	1.5	2000	3000	0.1	0.5			2 × 10 <sup>-13</sup>	5 × 10 <sup>-13</sup>
G12181-103K	-10	40	140	22	50	130	650	2 × 10 <sup>12</sup>	5.5 × 10 <sup>12</sup>	5 × 10 <sup>-15</sup>	1.5 × 10 <sup>-14</sup>
G12181-105K		15	50	64	150	50	250			7 × 10 <sup>-15</sup>	2 × 10 <sup>-14</sup>
G12181-110K		5	16	200	500	13	65			1.5 × 10 <sup>-14</sup>	4 × 10 <sup>-14</sup>
G12181-120K		1.2	3.5	900	2000	2.8	14			3.5 × 10 <sup>-14</sup>	9 × 10 <sup>-14</sup>
G12181-130K		1	1.8	1800	3000	1.3	6.5			5 × 10 <sup>-14</sup>	1.5 × 10 <sup>-13</sup>
G12181-203K	-20	40	150	20	50	280	1400	3 × 10 <sup>12</sup>	8.5 × 10 <sup>12</sup>	3.5 × 10 <sup>-15</sup>	9 × 10 <sup>-15</sup>
G12181-205K		15	53	60	150	110	550			5 × 10 <sup>-15</sup>	1.5 × 10 <sup>-14</sup>
G12181-210K		5	17	195	500	28	150			1 × 10 <sup>-14</sup>	3 × 10 <sup>-14</sup>
G12181-220K		1.2	3.7	850	2000	5.5	28			2.5 × 10 <sup>-14</sup>	6.5 × 10 <sup>-14</sup>
G12181-230K		1	1.9	1700	3000	2.8	14			3.5 × 10 <sup>-14</sup>	9 × 10 <sup>-14</sup>

**Spectral response**

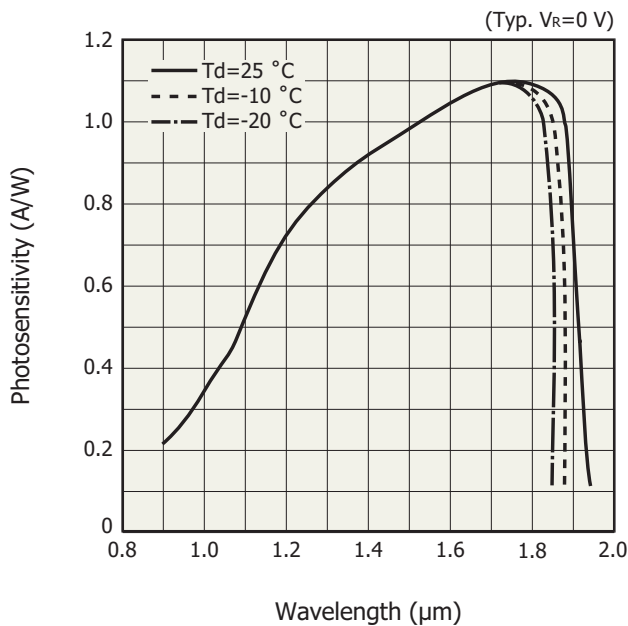

KIRD06483EC

**Spectral transmittance of window material**

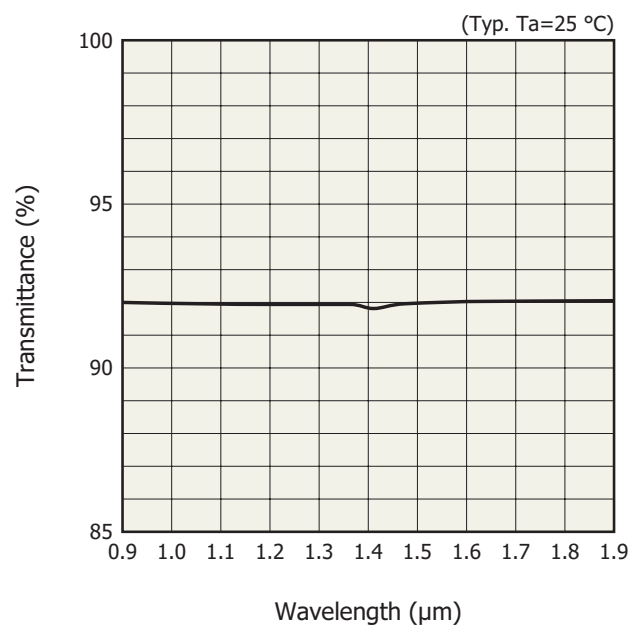

KIRD06037EA

Photosensitivity temperature characteristics

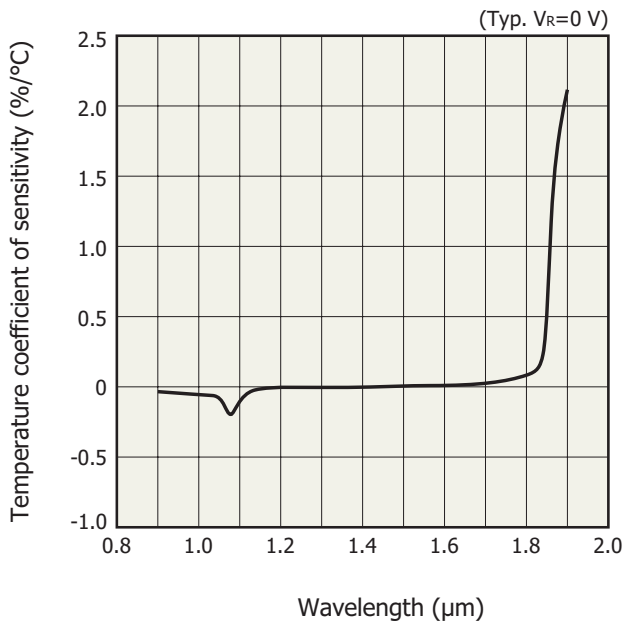

Linearity (G12181-010K)

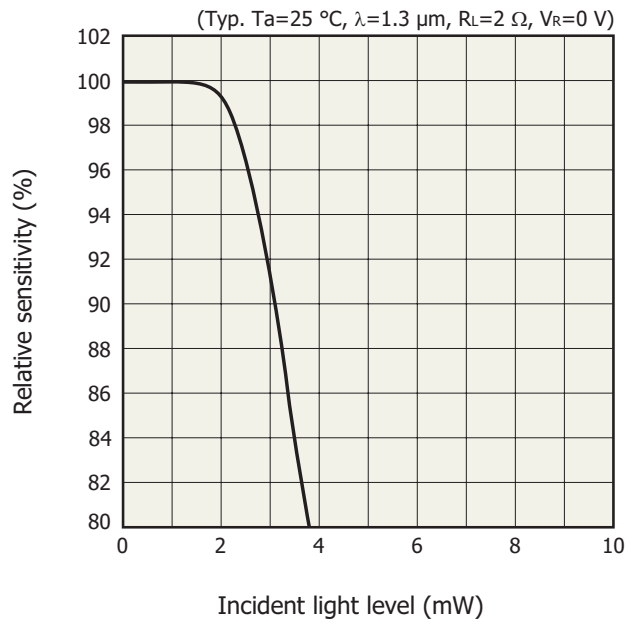

Dark current vs. reverse voltage

Non-cooled type

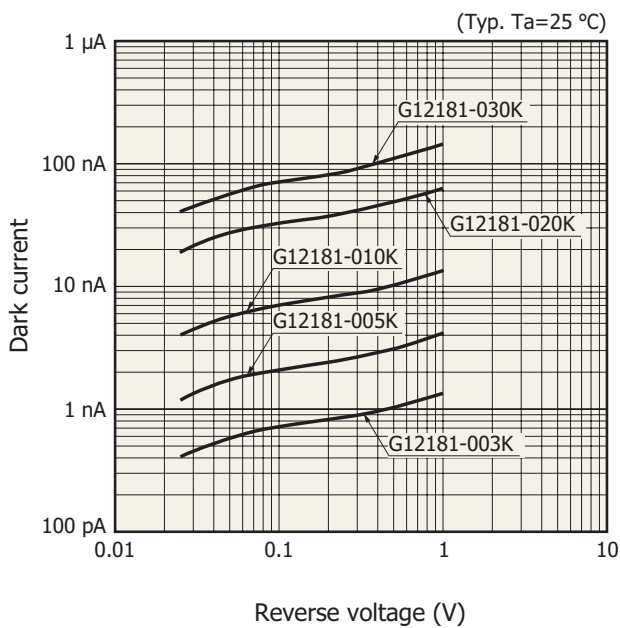

TE-cooled type

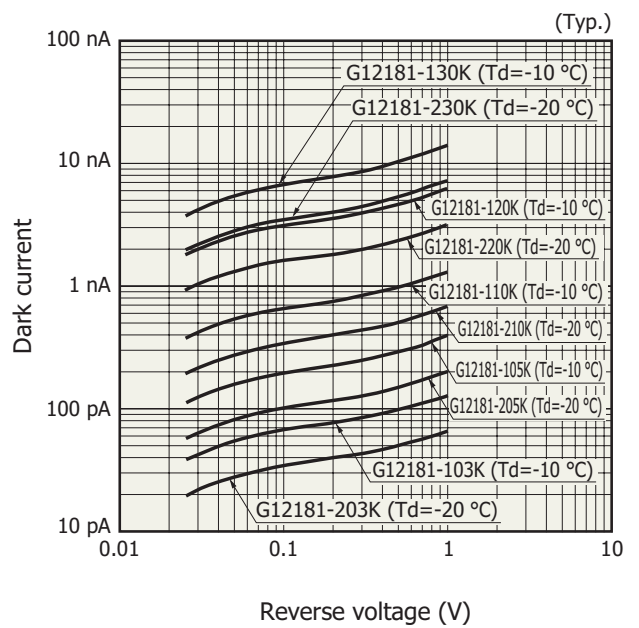

Terminal capacitance vs. reverse voltage

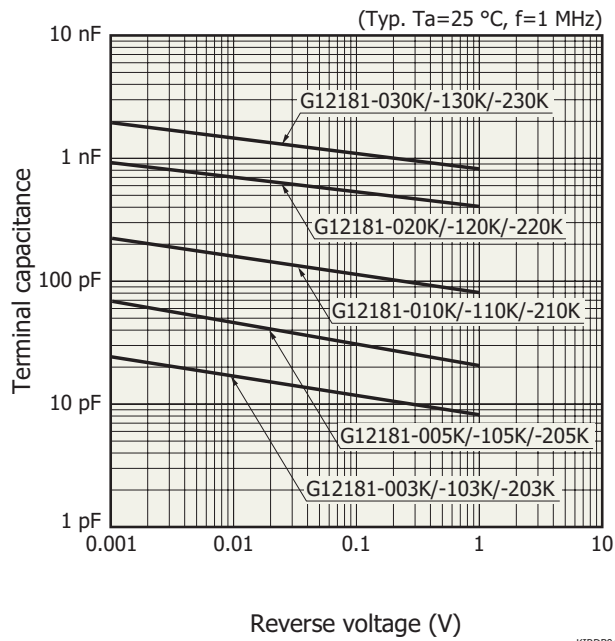

Shunt resistance vs. element temperature

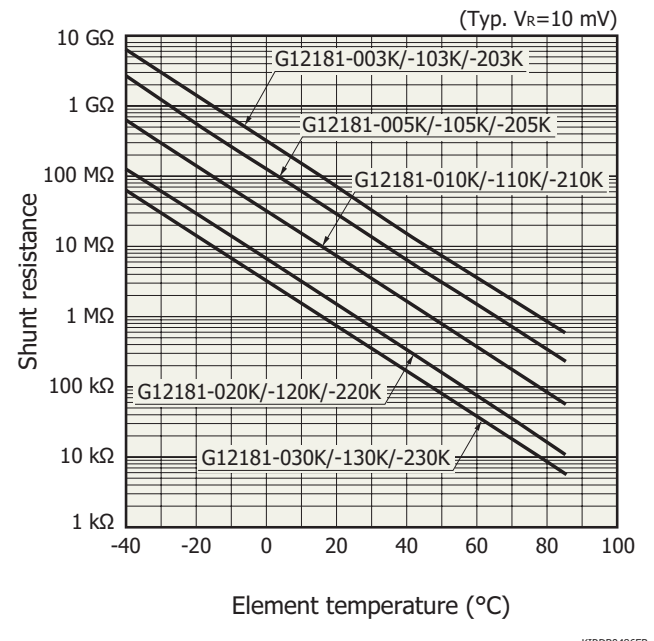

The operating temperature for one-stage and two-stage TE-cooled types is up to 70 °C.

Thermistor temperature characteristics

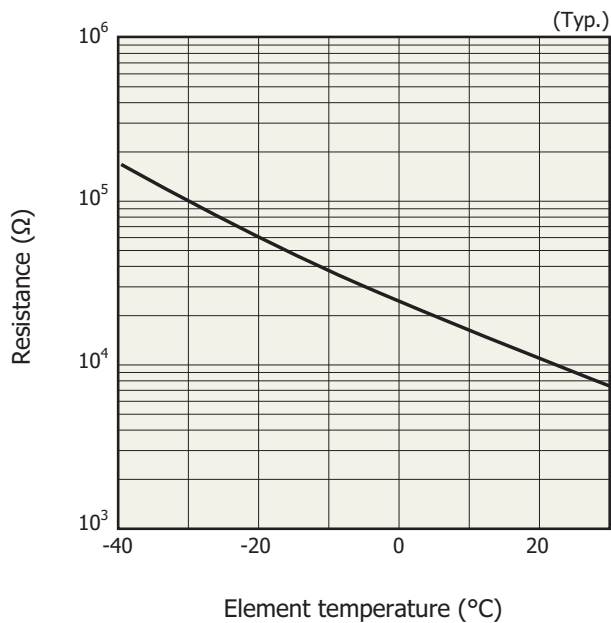

Cooling characteristics of TE-cooler

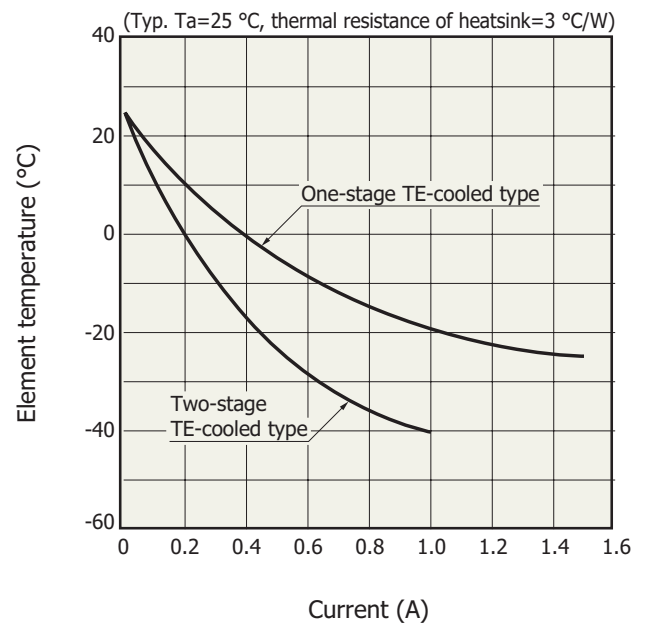

**Current vs. voltage (TE-cooler)**

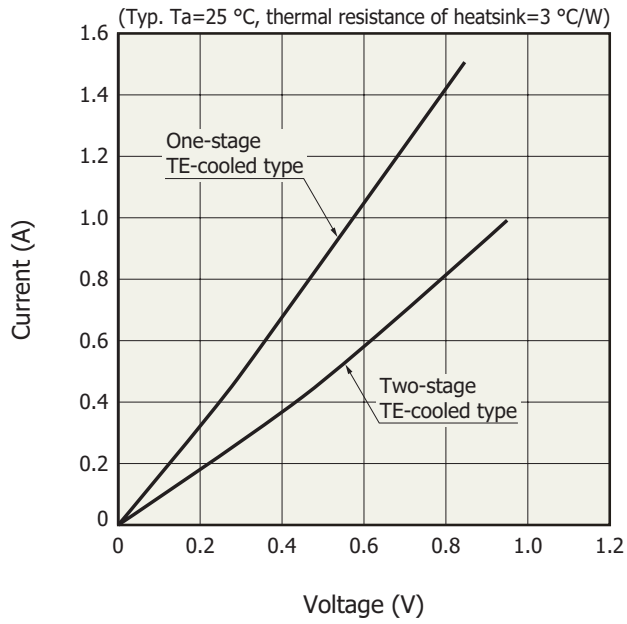

KIRDB0115EB

**Dimensional outlines (unit: mm)**

(1) G12181-003K/-005K/-010K

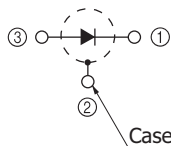
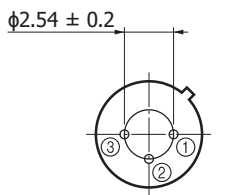
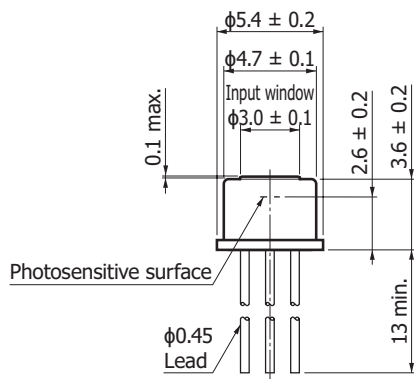

Distance from photosensitive area center to cap center

$$-0.2 \leq X \leq +0.2$$

$$-0.2 \leq Y \leq +0.2$$

(2) G12181-020K/-030K

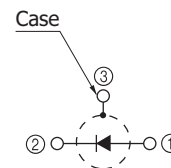
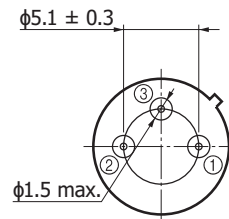
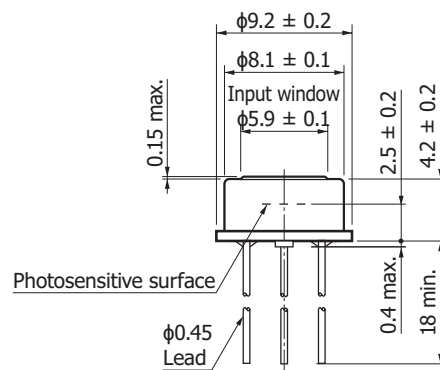

Distance from photosensitive area center to cap center

$$-0.2 \leq X \leq +0.2$$

$$-0.2 \leq Y \leq +0.2$$

KIRDA0220EA

KIRDA0221EA

(3) G12181-103K/-105K/-110K/-120K/-130K

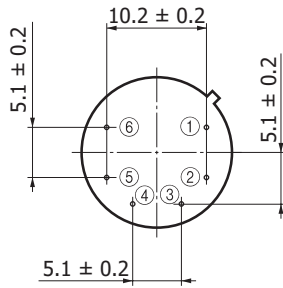
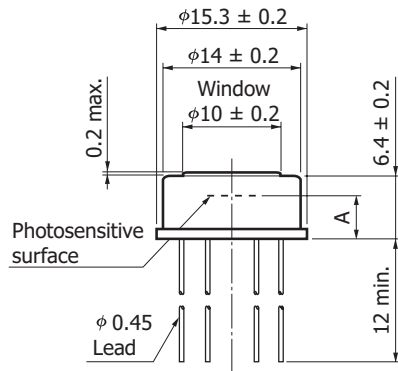

- ① Detector (anode)
- ② Detector (cathode)
- ③ TE-cooler (-)
- ④ TE-cooler (+)
- ⑤⑥ Thermistor

Distance from photosensitive area center to cap center  
 $-0.3 \leq X \leq +0.3$   
 $-0.3 \leq Y \leq +0.3$

	G12181-103K /-105K/-110K	G12181-120K /-130K
A	4.3 ± 0.2	4.4 ± 0.2

KIRDA0224EA

(4) G12181-203K/-205K/-210K/-220K/-230K

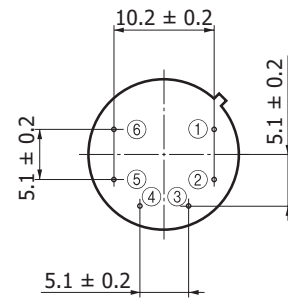
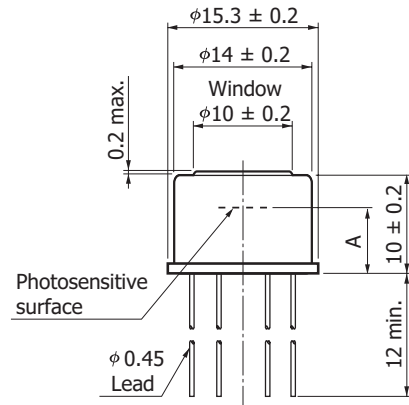

- ① Detector (anode)
- ② Detector (cathode)
- ③ TE-cooler (-)
- ④ TE-cooler (+)
- ⑤⑥ Thermistor

Distance from photosensitive area center to cap center  
 $-0.3 \leq X \leq +0.3$   
 $-0.3 \leq Y \leq +0.3$

	G12181-203K /-205K/-210K	G12181-220K /-230K
A	6.6 ± 0.2	6.7 ± 0.2

KIRDA0225EA

### Recommended soldering conditions

Solder temperature: 260 °C (10 s or less, once)

Solder the leads at a point at least 1 mm away from the package body.

Note: When you set soldering conditions, check that problems do not occur in the product by testing out the conditions in advance.

### Related information

[www.hamamatsu.com/sp/ssd/doc\\_en.html](http://www.hamamatsu.com/sp/ssd/doc_en.html)

#### ■ Precautions

- Disclaimer
- Safety consideration
- Compound opto-semiconductors (photosensors, light emitters)

Information described in this material is current as of January 2021.

Product specifications are subject to change without prior notice due to improvements or other reasons. This document has been carefully prepared and the information contained is believed to be accurate. In rare cases, however, there may be inaccuracies such as text errors. Before using these products, always contact us for the delivery specification sheet to check the latest specifications.

The product warranty is valid for one year after delivery and is limited to product repair or replacement for defects discovered and reported to us within that one year period. However, even if within the warranty period we accept absolutely no liability for any loss caused by natural disasters or improper product use. Copying or reprinting the contents described in this material in whole or in part is prohibited without our prior permission.

# HAMAMATSU

[www.hamamatsu.com](http://www.hamamatsu.com)

HAMAMATSU PHOTONICS K.K., Solid State Division

1126-1 Ichino-cho, Higashi-ku, Hamamatsu City, 435-8558 Japan, Telephone: (81)53-434-3311, Fax: (81)53-434-5184

U.S.A.: Hamamatsu Corporation: 360 Foothill Road, Bridgewater, N.J. 08807, U.S.A., Telephone: (1)908-231-0960, Fax: (1)908-231-1218, E-mail: [usa@hamamatsu.com](mailto:usa@hamamatsu.com)

Germany: Hamamatsu Photonics Deutschland GmbH: Arzbergerstr. 10, D-82211 Herrsching am Ammersee, Germany, Telephone: (49)8152-375-0, Fax: (49)8152-265-8, E-mail: [info@hamamatsu.de](mailto:info@hamamatsu.de)

France: Hamamatsu Photonics France S.A.R.L.: 19, Rue du Saule Trapu, Parc du Moulin de Massy, 91882 Massy Cedex, France, Telephone: (33)1 69 53 71 00, Fax: (33)1 69 53 71 10, E-mail: [infos@hamamatsu.fr](mailto:infos@hamamatsu.fr)

United Kingdom: Hamamatsu Photonics UK Limited: 2 Howard Court, 10 Tewin Road, Welwyn Garden City, Hertfordshire AL7 1BW, UK, Telephone: (44)1707-294888, Fax: (44)1707-325777, E-mail: [info@hamamatsu.co.uk](mailto:info@hamamatsu.co.uk)

North Europe: Hamamatsu Photonics Norden AB: Torshamnsgatan 35 16440 Kista, Sweden, Telephone: (46)8-509 031 00, Fax: (46)8-509 031 01, E-mail: [info@hamamatsu.se](mailto:info@hamamatsu.se)

Italy: Hamamatsu Photonics Italia S.r.l.: Strada della Moia, 1 int. 6, 20020 Arese (Milano), Italy, Telephone: (39)02-93 58 17 33, Fax: (39)02-93 58 17 41, E-mail: [info@hamamatsu.it](mailto:info@hamamatsu.it)

China: Hamamatsu Photonics (China) Co., Ltd.: 1201 Tower B, Jiaming Center, 27 Dongsanhuan Beilu, Chaoyang District, 100020 Beijing, P.R.China, Telephone: (86)10-6586-6006, Fax: (86)10-6586-2866, E-mail: [hpc@hamamatsu.com.cn](mailto:hpc@hamamatsu.com.cn)

Taiwan: Hamamatsu Photonics Taiwan Co., Ltd.: 8F-3, No. 158, Section2, Gongdao 5th Road, East District, Hsinchu, 300, Taiwan R.O.C. Telephone: (886)3-659-0080, Fax: (886)3-659-0081, E-mail: [info@hamamatsu.com.tw](mailto:info@hamamatsu.com.tw)