

G2SD655

Silicon NPN Epitaxial

Application

Low frequency power amplifier, Muting.

Package Dimensions

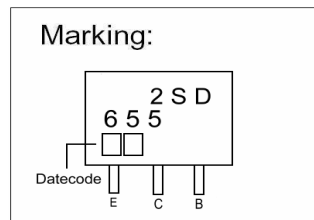
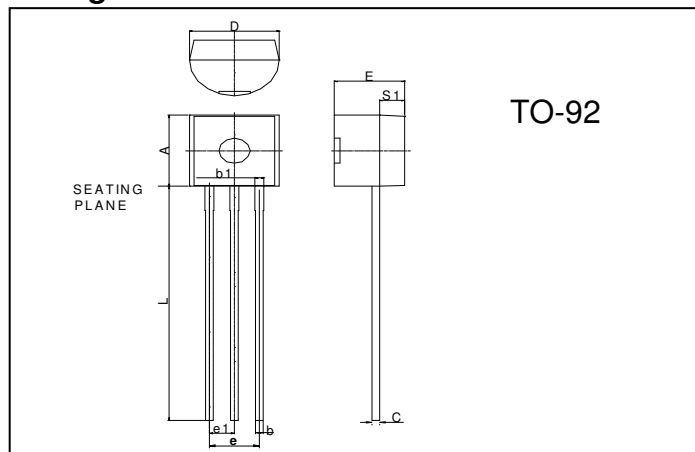

REF.	Millimeter		REF.	Millimeter	
	Min.	Max.		Min.	Max.
A	4.45	4.7	D	4.44	4.7
S1	1.02	-	E	3.30	3.81
b	0.36	0.51	L	12.70	-
b1	0.36	0.76	e1	1.150	1.390
C	0.36	0.51	e	2.42	2.66

Absolute Maximum Ratings (Ta = 25°C)

Parameter		Ratings	Unit
Collector to Base Voltage	VCBO	30	V
Collector to Emitter Voltage	VCEO	15	V
Emitter to Base Voltage	VEBO	5	V
Collect Current(DC)	IC	0.7	A
Collect peak current	IC(peak)	1.0	A
Junction Temperature	Tj	+150	°C
Storage Temperature Range	Tstg	-55 ~ +150	°C
Total Power Dissipation	PD	500	mW

Electrical Characteristics (Ta = 25°C)

Symbol	Min.	Typ.	Max.	Unit	Test Conditions
BV _{CB0}	30	-	-	V	IC=10uA, IE=0
BV _{CE0}	15	-	-	V	IC=1mA, RBE=∞
BV _{EB0}	5	-	-	V	IE=10uA, IC=0
IC _{B0}	-	-	1.0	uA	V _{CB} =20V, IE=0
V _{BE}	-	-	1.0	V	V _{CE} =1V, IC=150mA
V _{CE(sat)}	-	0.15	0.5	V	IC=500mA, IB=50mA *2
h _{FE1} *1	250	-	1200		V _{CE} =1V, IC=150mA *2
f _T	-	250	-	MHz	V _{CE} =1V, IC=150mA

Notes: 1. The G2SD655 is grouped by hFE as follows.
 2. Pulse test

Classification of Rank

Rank	D	E	F
Range	250-500	400-800	600-1200

Characteristics Curve

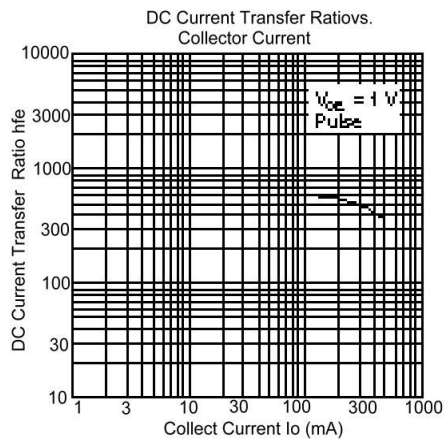
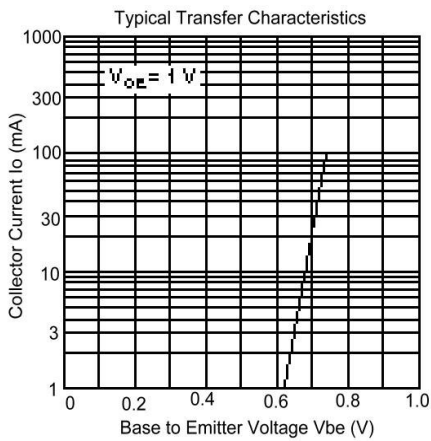
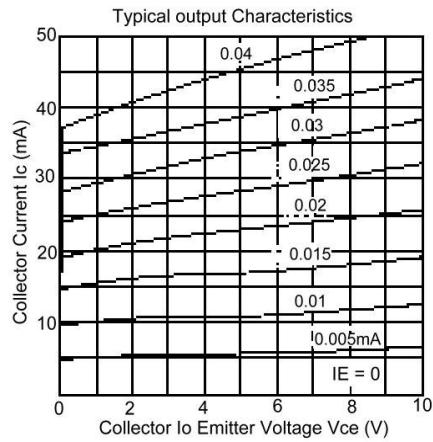
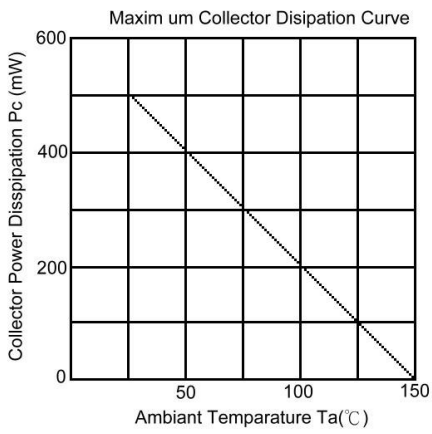

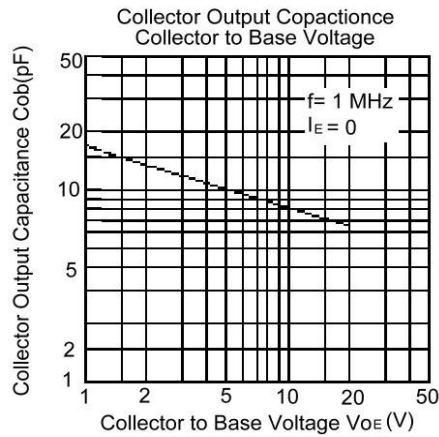
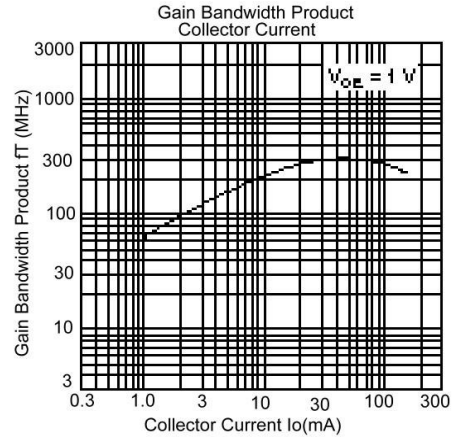
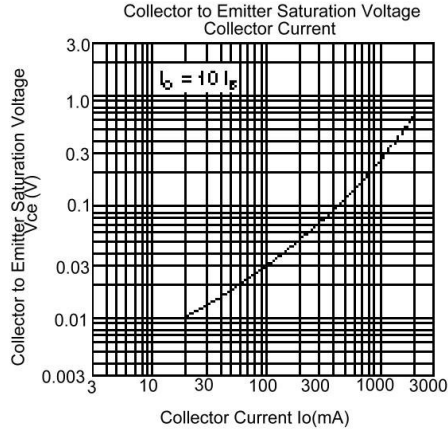

Important Notice:

- All rights are reserved. Reproduction in whole or in part is prohibited without the prior written approval of GTM.
- GTM reserves the right to make changes to its products without notice.
- GTM semiconductor products are not warranted to be suitable for use in life-support Applications, or systems.
- GTM assumes no liability for any consequence of customer product design, infringement of patents, or application assistance.

Head Office And Factory:

- **Taiwan:** No. 17-1 Tatung Rd. Fu Kou Hsin-Chu Industrial Park, Hsin-Chu, Taiwan, R. O. C.
- TEL : 886-3-597-7061 FAX : 886-3-597-9220, 597-0785
- **China:** (201203) No.255, Jang-Jiang Tsai-Lueng RD. , Pu-Dung-Hsin District, Shang-Hai City, China
- TEL : 86-21-5895-7671 ~ 4 FAX : 86-21-38950165