

## G6718

### NPN EPITAXIAL PLANAR TRANSISTOR

#### Description

The G6718 is designed for general purpose medium power amplifier and switching applications.

#### Features

- High Power: 850mW
- High Current: 1A

#### Package Dimensions

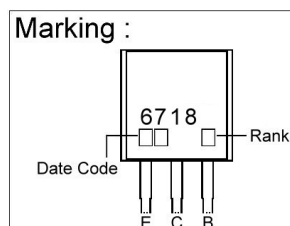
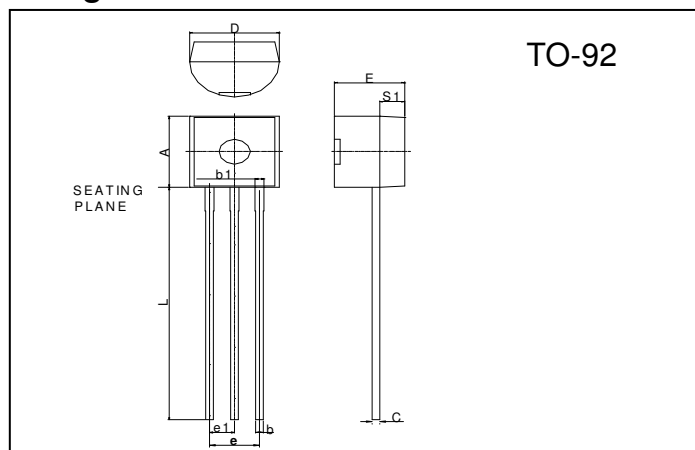

REF.	Millimeter		REF.	Millimeter	
	Min.	Max.		Min.	Max.
A	4.45	4.7	D	4.44	4.7
S1	1.02	-	E	3.30	3.81
b	0.36	0.51	L	12.70	-
b1	0.36	0.76	e1	1.150	1.390
C	0.36	0.51	e	2.42	2.66

#### Absolute Maximum Ratings (TA=25°C)

Parameter	Symbol	Ratings	Unit
Collector to Base Voltage	VCBO	100	V
Collector to Emitter Voltage	VCEO	100	V
Emitter to Base Voltage	VEBO	5	V
Collector Current (DC)	IC	1	A
Collector Current (Pulse)	IC	2	A
Base Current	IB	200	mA
Total Device Dissipation	PD	850	mW
Junction Temperature	TJ	150	°C
Storage Temperature	Tstg	-55 ~ +150	°C

#### Electrical Characteristics (TA = 25°C unless otherwise noted)

Symbol	Min.	Typ.	Max.	Unit	Test Conditions
BV <sub>CB0</sub>	100	-	-	V	IC=100uA, IE=0
BV <sub>CE0</sub>	100	-	-	V	IC=1mA, IB=0
BV <sub>EB0</sub>	5	-	-	V	IE=10uA, IC=0
IC <sub>B0</sub>	-	-	100	nA	V <sub>CB</sub> =80V, IE=0
*V <sub>CE(sat)</sub>	-	-	350	mV	IC=350mA, IB=35mA
*h <sub>FE1</sub>	80	-	-		V <sub>CE</sub> =1V, IC=50mA
*h <sub>FE2</sub>	50	-	300		V <sub>CE</sub> =1V, IC=250mA
*h <sub>FE3</sub>	20	-	-		V <sub>CE</sub> =1V, IC=500mA
f <sub>T</sub>	50	-	-	MHz	V <sub>CE</sub> =10V, IE=50mA, f=100MHz
C <sub>ob</sub>	-	-	20	pF	V <sub>CB</sub> =10V, IE=0, f=1MHz

\*Pulse Test: Pulse Width ≤ 380μs, Duty Cycle ≤ 2%

#### Classification Of h<sub>FE2</sub>

Rank	A	B
Range	50 ~ 115	95 ~ 300

## Characteristics Curve

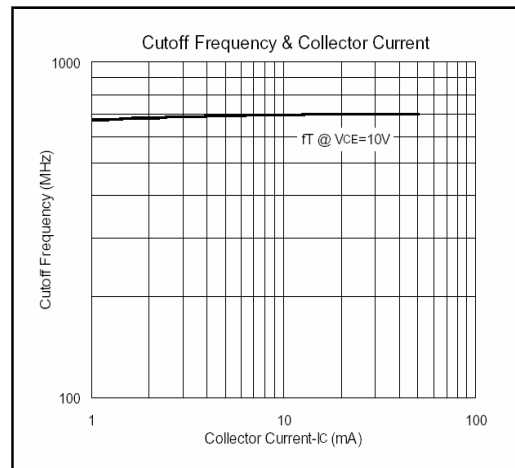
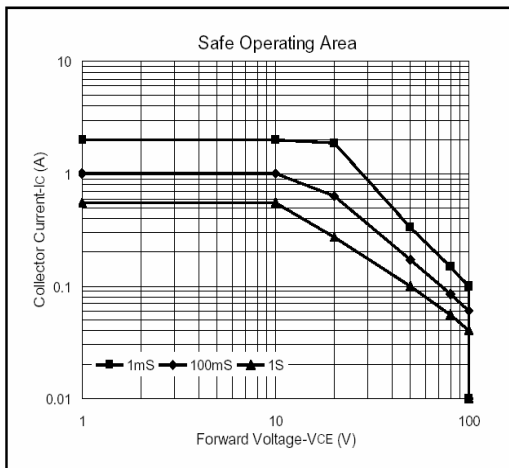
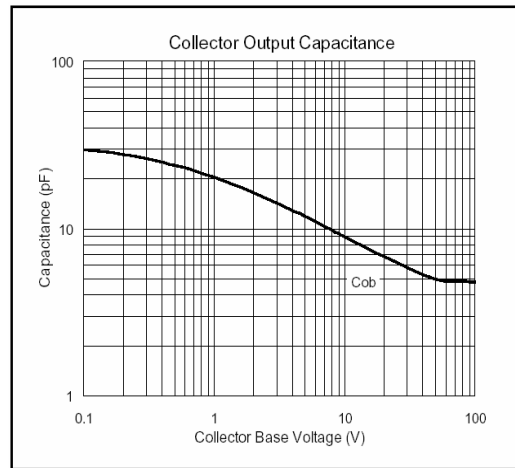
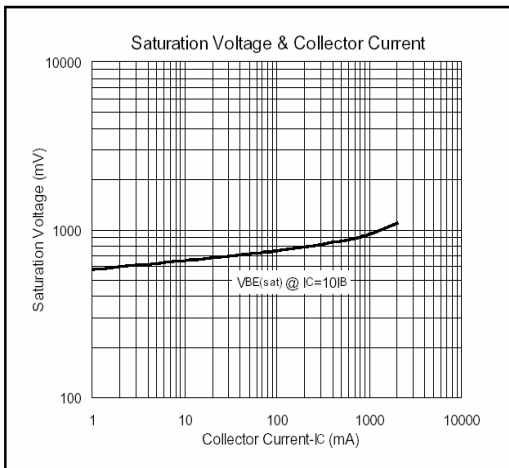
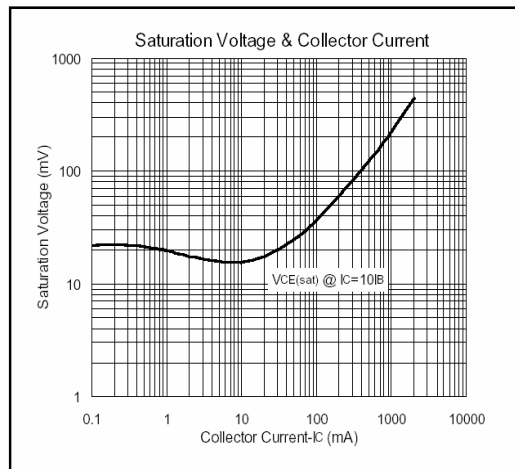
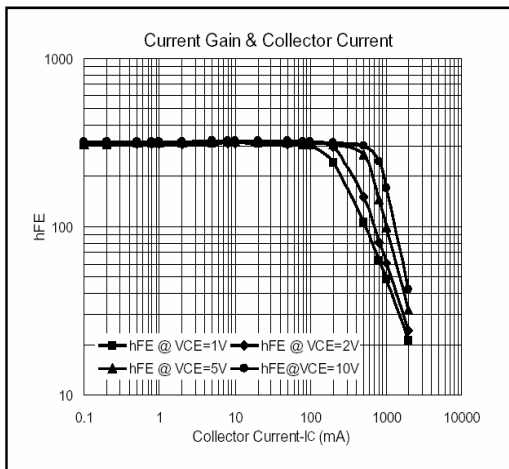

**Important Notice:**

- All rights are reserved. Reproduction in whole or in part is prohibited without the prior written approval of GTM.
- GTM reserves the right to make changes to its products without notice.
- GTM semiconductor products are not warranted to be suitable for use in life-support Applications, or systems.
- GTM assumes no liability for any consequence of customer product design, infringement of patents, or application assistance.

**Head Office And Factory:**

- **Taiwan:** No. 17-1 Tatung Rd. Fu Kou Hsin-Chu Industrial Park, Hsin-Chu, Taiwan, R. O. C.
- TEL : 886-3-597-7061 FAX : 886-3-597-9220, 597-0785
- **China:** (201203) No.255, Jang-Jiang Tsai-Lueng RD. , Pu-Dung-Hsin District, Shang-Hai City, China
- TEL : 86-21-5895-7671 ~ 4 FAX : 86-21-38950165