

## G9018

### NPN EPITAXIAL PLANAR TRANSISTOR

#### Description

The G9018 is designed for use in AM/FM amplifier and local oscillator of FM/VHF tuner.

#### Package Dimensions

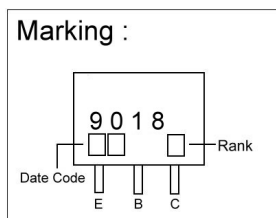
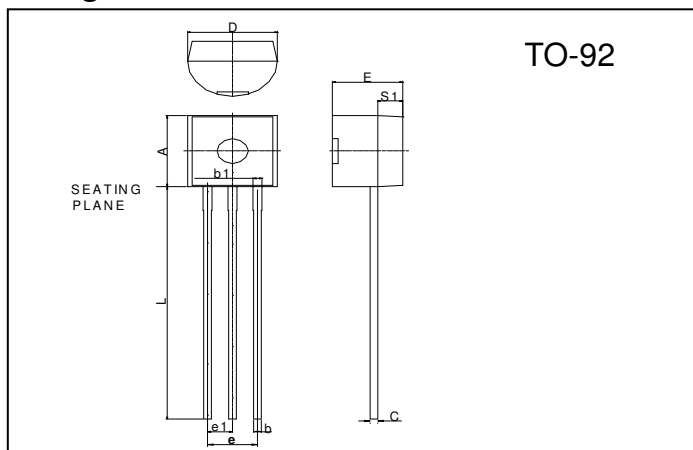

REF.	Millimeter		REF.	Millimeter	
	Min.	Max.		Min.	Max.
A	4.45	4.7	D	4.44	4.7
S1	1.02	-	E	3.30	3.81
b	0.36	0.51	L	12.70	-
b1	0.36	0.76	e1	1.150	1.390
C	0.36	0.51	e	2.42	2.66

#### Absolute Maximum Ratings at Ta = 25°C

Parameter	Symbol	Ratings	Unit
Junction Temperature	Tj	+150	°C
Storage Temperature	Tstg	-55 ~ +150	°C
Collector to Base Voltage	VCBO	30	V
Collector to Emitter Voltage	VCEO	15	V
Emitter to Base Voltage	VEBO	5	V
Collector Current	IC	50	mA
Total Power Dissipation	PD	400	mW

#### Characteristics at Ta = 25°C

Symbol	Min.	Typ.	Max.	Unit	Test Conditions
BVCBO	30	-	-	V	IC=100uA, IE=0
BVCEO	15	-	-	V	IC=1mA, IB=0
BVEBO	5	-	-	V	IE=100uA, IC=0
ICBO	-	-	50	nA	VCB=12V, IE=0
*VCE(sat)	-	-	0.5	V	IC=10mA, IB=1mA
*hFE	39	-	198		VCE=5V, IC=1mA
fT	700	1100	-	MHz	VCE=5V, IC=5mA
Cob	-	1.3	1.7	pF	VCB=10V, IE=0

\* Pulse Test: Pulse Width ≤ 380μs, Duty Cycle ≤ 2%

#### Classification Of hFE

Rank	E	F	G	H	I
hFE	39 - 60	54 - 80	72 - 108	97 - 146	132 - 198

## Characteristics Curve

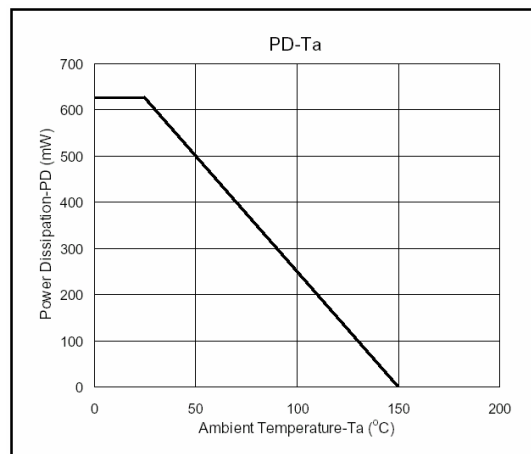
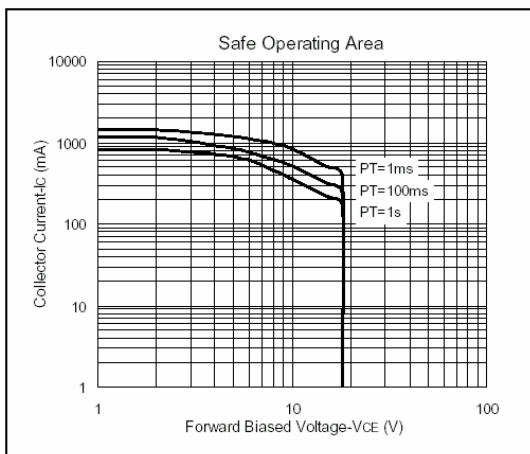
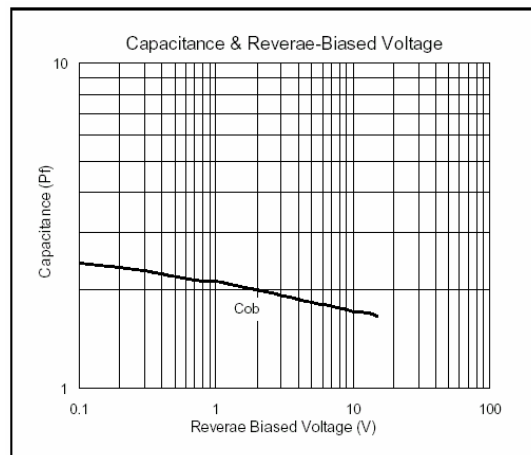
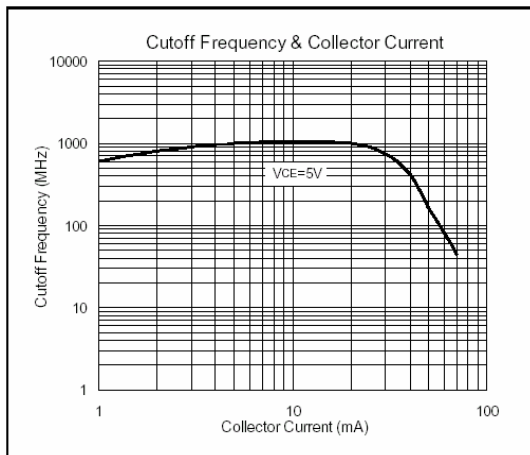
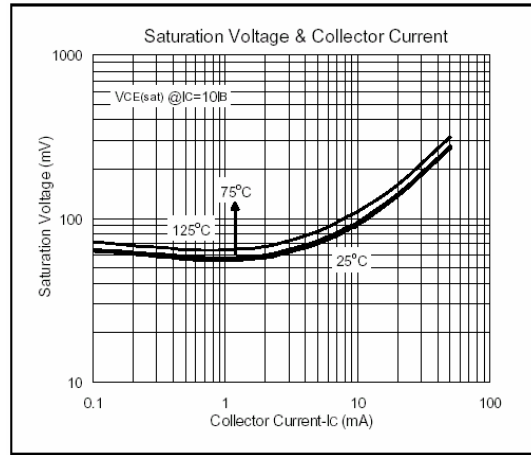
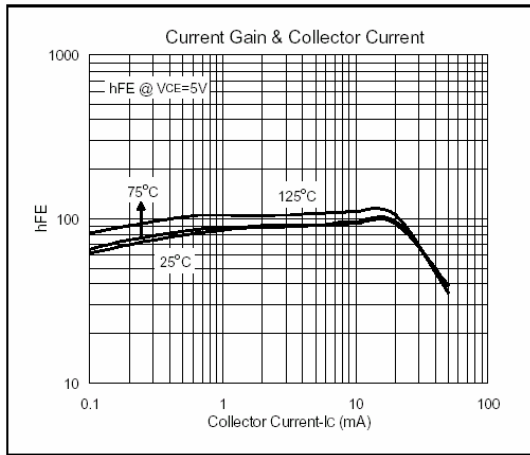

**Important Notice:**

- All rights are reserved. Reproduction in whole or in part is prohibited without the prior written approval of GTM.
- GTM reserves the right to make changes to its products without notice.
- GTM semiconductor products are not warranted to be suitable for use in life-support Applications, or systems.
- GTM assumes no liability for any consequence of customer product design, infringement of patents, or application assistance.

**Head Office And Factory:**

- Taiwan:** No. 17-1 Tatung Rd. Fu Kou Hsin-Chu Industrial Park, Hsin-Chu, Taiwan, R. O. C.
- TEL : 886-3-597-7061 FAX : 886-3-597-9220, 597-0785
- China:** (201203) No.255, Jang-Jiang Tsai-Lueng RD. , Pu-Dung-Hsin District, Shang-Hai City, China
- TEL : 86-21-5895-7671 ~ 4 FAX : 86-21-38950165