

1. Mechanical Dimensions:

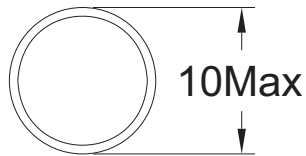

(TOP VIEW)

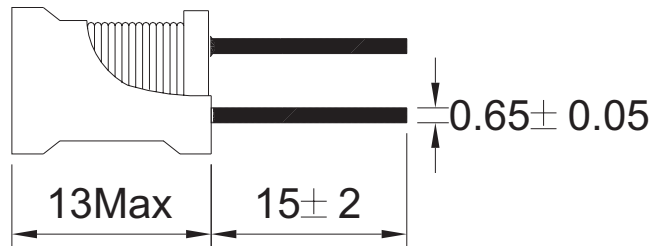

(SIDE VIEW)

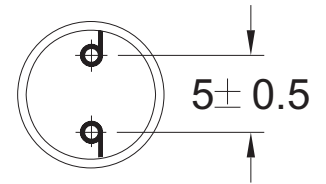

(BUTTON VIEW)

2. Electrical Characteristics :

Specifications: at 25°C . Operating Temperature -40 to +85°C

NO.	ITEM	TEST CONDITION	SPECIFICATION
1	Inductance	(1-2)@1KHz, 0.25Vac	1mH+/-20%
2	DCR	(1-2) @ 25°C	1.9Ω Max

3. SCHEMATIC:

