

REV.	CHANGE CONTENT	BY	DATE

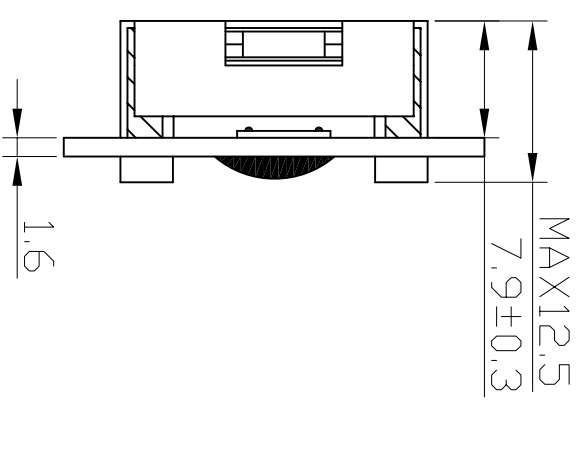

NO.	1	2	3	4	5	6	7-14	15	16
SYM.	GND	VDD	V0	RS	R/W	E	DD-D7	NC	NC

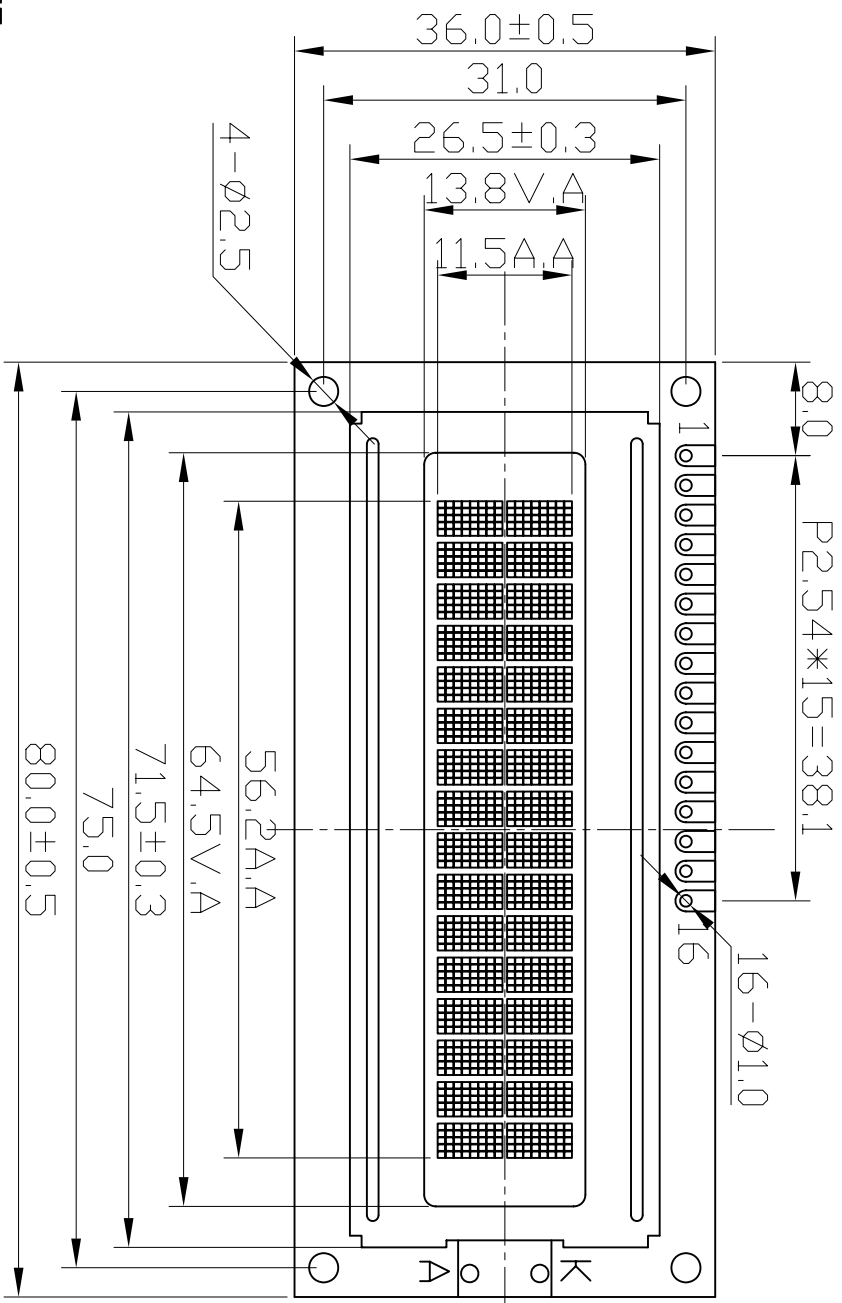
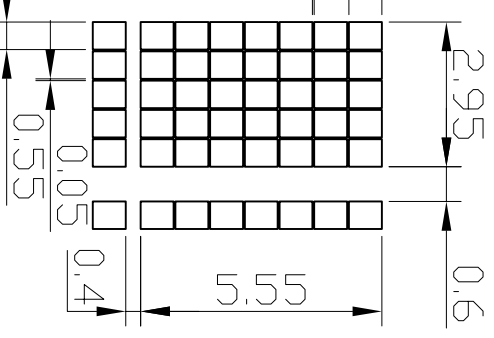

- NOTE:
1. DISPLAY TYPE: STN-Y/G-POSITIVE
 2. DISPLAY MODE: REFLECTIVE
 3. DRIVE METHOD: 1/16 DUTY, 1/5 BIAS.
 4. LCD DRIVING VOLTAGE : 4.6V
 5. VIEWING DIR.: 6:00
 6. OP TEMP.: -20°C~70°C
 7. ST TEMP.: -30°C~80°C
 8. POWER SUPPLY FOR LOGIC : 5.0V
 9. BACKLIGHT: NONE
 10. DRIVER IC:S6A0069,S6A0065

TOLERANCE		HTDISPLAY		HTDISPLAY CO., LTD.		DRAWING No. : HC160204C-YR62N-VD	
>0~6	±0.10	DESIGN	JHG	STANDARD	REV. : A	SCALE : -	
>6~80	±0.20	CHECKED		TECHNOLOGY	PROJECTION:	UNIT : mm	
>80~240	±0.30	APPROVED		Q.A		SHEET : 1/1	
>240~400	±0.50						
// 1.0 @ ±0.10							