

HFE26

MINIATURE HIGH POWER LATCHING RELAY



Features

- 25A, 40A switching capability
- Latching relay
- Manual switch function available
- Creepage distance: 8mm
- Dielectric strength: more than 4kV (between coil and contacts)
- Environmental friendly product (RoHS compliant)
- Outline Dimensions: (38.8 x 15.0 x 28.7)mm

CONTACT DATA

| | |
|----------------------------|----------------------------------|
| Contact arrangement | 1A, 1C |
| Contact resistance | 2mΩ max. (at 1A 24VDC) |
| Contact material | AgSnO ₂ |
| Contact rating (Res. load) | 1C: 25A 250VAC 1A: 40A 250VAC |
| Max. switching voltage | 250VAC |
| Max. switching current | 40A |
| Max. switching power | 10000VA |
| Max. continuous current | 40A |
| Mechanical endurance | 1 x 10 ⁶ OPS |
| Electrical endurance | 3 x 10 ⁴ OPS |

CHARACTERISTICS

| | | |
|-------------------------------------|-------------------------|---------------------|
| Insulation resistance | 1000MΩ (at 500VDC) | |
| Dielectric strength | Between coil & contacts | 4000VAC 1min |
| | Between open contacts | 1500VAC 1min |
| Creepage distance (input to output) | 8mm | |
| Operate time (at nomi. volt.) | 10ms max. | |
| Release time (at nomi. volt.) | 10ms max. | |
| Shock resistance | Functional | 98m/s ² |
| | Destructive | 980m/s ² |
| Vibration resistance | 10Hz to 55Hz 1.5mm DA | |
| Humidity | 5% to 85% RH | |
| Ambient temperature | -40°C to 70°C | |
| Storage temperature | -40°C to 100°C | |
| Termination | PCB & QC | |
| Unit weight | Approx. 36g | |
| Construction | Dust protected | |

Notes: The data shown above are initial values.

COIL

| | |
|------------|--|
| Coil power | 25A: Single coil latching: Approx. 1.0W Double coils latching: Approx. 2.0W |
| | 40A: Single coil latching: Approx. 1.5W Double coils latching: Approx. 3.0W |

COIL DATA

at 23°C

25A

| Nominal Voltage VDC | Set / Reset Voltage VDC max. | Pulse Duration ms min. | Coil Resistance x (1±10%) Ω | |
|---------------------|------------------------------|------------------------|-----------------------------|-----------|
| 5 | 4 | 50 | Single coil latching | 25 |
| 6 | 4.8 | 50 | | 36 |
| 9 | 7.2 | 50 | | 81 |
| 12 | 9.6 | 50 | | 144 |
| 15 | 12 | 50 | | 225 |
| 24 | 19.2 | 50 | | 576 |
| 48 | 38.4 | 50 | | 2304 |
| 5 | 4 | 50 | Double coils latching | 12.5+12.5 |
| 6 | 4.8 | 50 | | 18+18 |
| 9 | 7.2 | 50 | | 41+41 |
| 12 | 9.6 | 50 | | 72+72 |
| 15 | 12 | 50 | | 113+113 |
| 24 | 19.2 | 50 | | 288+288 |
| 48 | 38.4 | 50 | | 1152+1152 |

NOTICE

1. Relay is on the "reset" or "set" status when being released from stock, with the consideration of shock risen from transit and relay mounting, relay would be changed to "set" or "reset" status, therefore, when application (connecting the power supply), please reset the relay to "set" or "reset" status on request.
2. In order to maintain "set" or "reset" status, energized voltage to coil should reach the rated voltage, impulse width should be 5 times more than "set" or "reset" time. Do not energize voltage to "set" coil and "reset" coil simultaneously. And also long energized time (more than 1 min) should be avoided.



HONGFA RELAY

ISO9001, ISO/TS16949, ISO14001, OHSAS18001, IECQ QC 080000 CERTIFIED

2014 Rev. 1.00

COIL DATA

at 23°C

40A

| Nominal Voltage VDC | Set / Reset Voltage VDC max. | Pulse Duration ms min. | Coil Resistance x (1±10%) Ω | |
|---------------------|------------------------------|------------------------|-----------------------------|------|
| 5 | 4 | 50 | Single coil latching | 16.8 |
| 6 | 4.8 | 50 | | 24 |
| 9 | 7.2 | 50 | | 54 |
| 12 | 9.6 | 50 | | 96 |
| 15 | 12 | 50 | | 150 |
| 24 | 19.2 | 50 | | 384 |
| 48 | 38.4 | 50 | | 1536 |

40A

| Nominal Voltage VDC | Set / Reset Voltage VDC max. | Pulse Duration ms min. | Coil Resistance x (1±10%) Ω | |
|---------------------|------------------------------|------------------------|-----------------------------|---------|
| 5 | 4 | 50 | Double coils latching | 8.4+8.4 |
| 6 | 4.8 | 50 | | 12+12 |
| 9 | 7.2 | 50 | | 27+27 |
| 12 | 9.6 | 50 | | 48+48 |
| 15 | 12 | 50 | | 75+75 |
| 24 | 19.2 | 50 | | 192+192 |
| 48 | 38.4 | 50 | | 768+768 |

ORDERING INFORMATION

| | | | |
|---|---|---------|---------------------------|
| Type | HFE26 -40/ 12 -Z A T -L2 -1 -R (XXX) | | |
| Contact rating | 40: 40A | 25: 25A | |
| Coil voltage | 5, 6, 9, 12, 15, 24, 48VDC | | |
| Contact form | H: 1 Form A (Only for 40A) Z: 1 Form C (Only for 25A) | | |
| Manual switch | A: With manual switch B: No manual switch | | |
| Contact material | T: AgSnO ₂ | | |
| Sort | L1: Single coil latching | | L2: Double coils latching |
| Layout of the coil pin (for details please check the outline dimensions) | 1: In parallel with the relay's longer edge 2: In parallel with the relay's shorter edge | | |
| Polarity | R: Negative polarity | | Nil: Positive polarity |
| Customer special code | | | |

OUTLINE DIMENSIONS AND WIRING DIAGRAM

Unit: mm

HFE26-40/XX-HXX-LX-1

Outline Dimensions

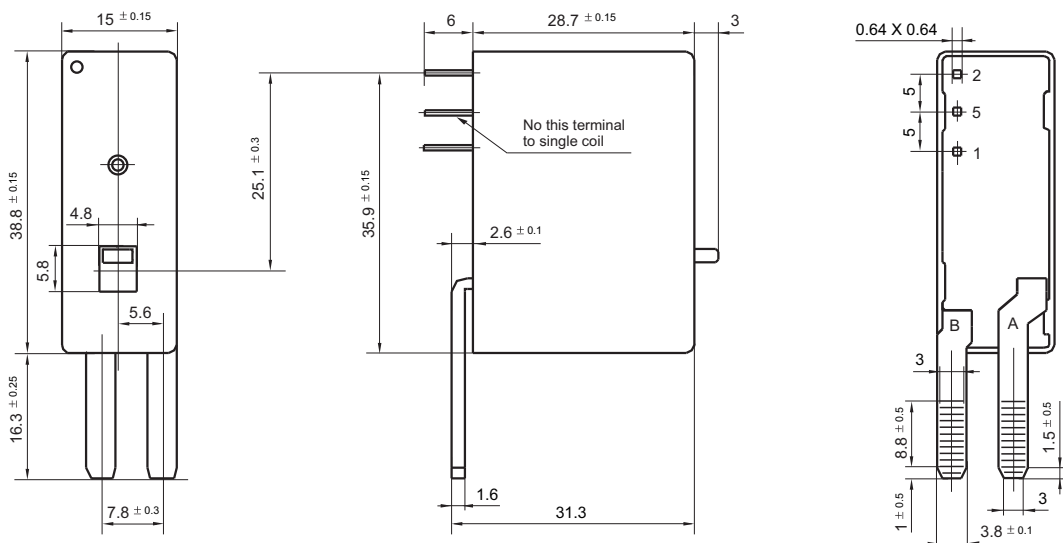

Outline Dimensions

HFE26-40/XX-HXX-LX-2

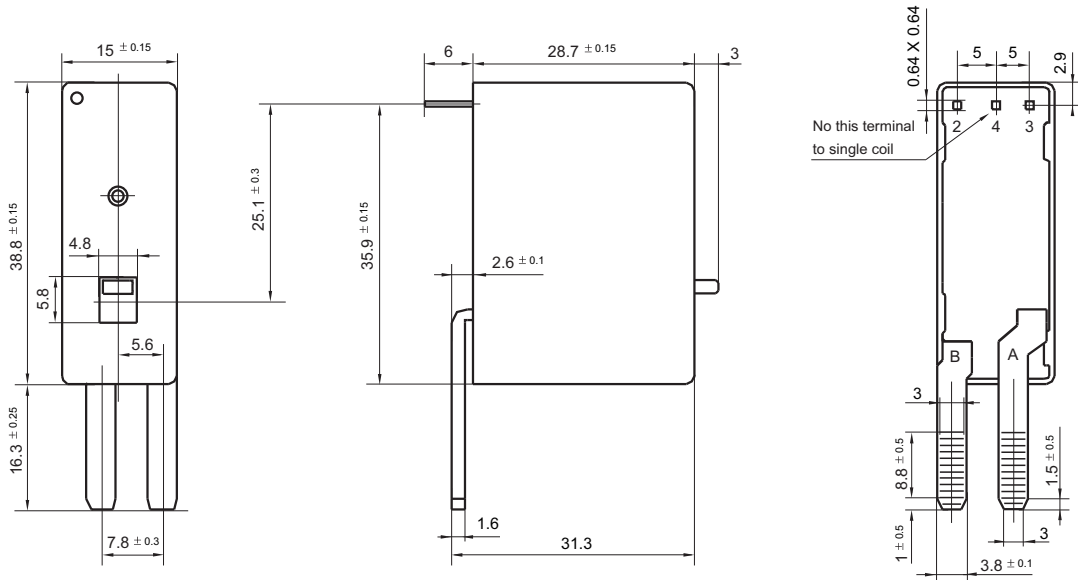

HFE26-25/XX-ZXX-LX-1

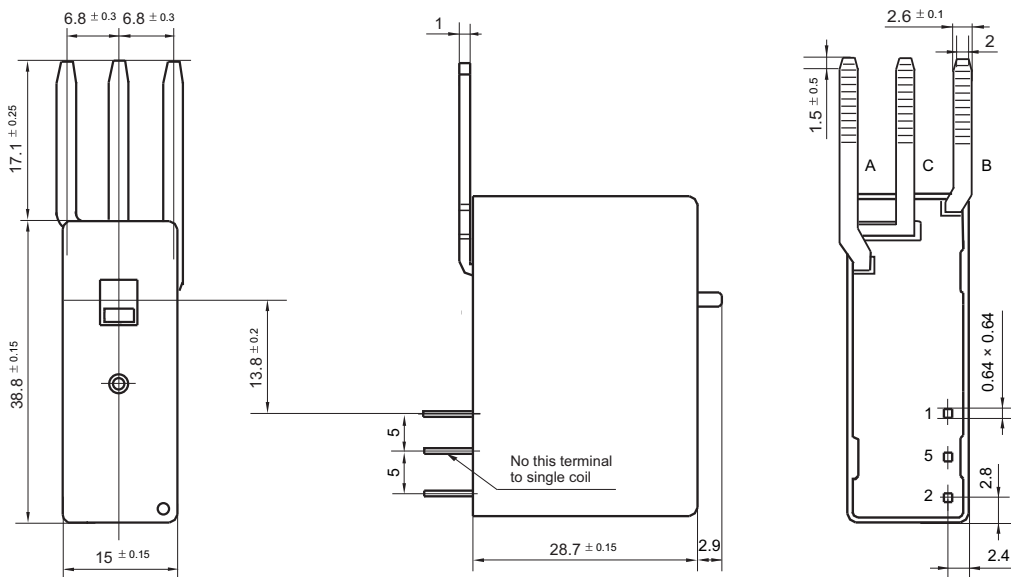

OUTLINE DIMENSIONS AND WIRING DIAGRAM

Unit: mm

HFE26-25/XX-ZXX-LX-2

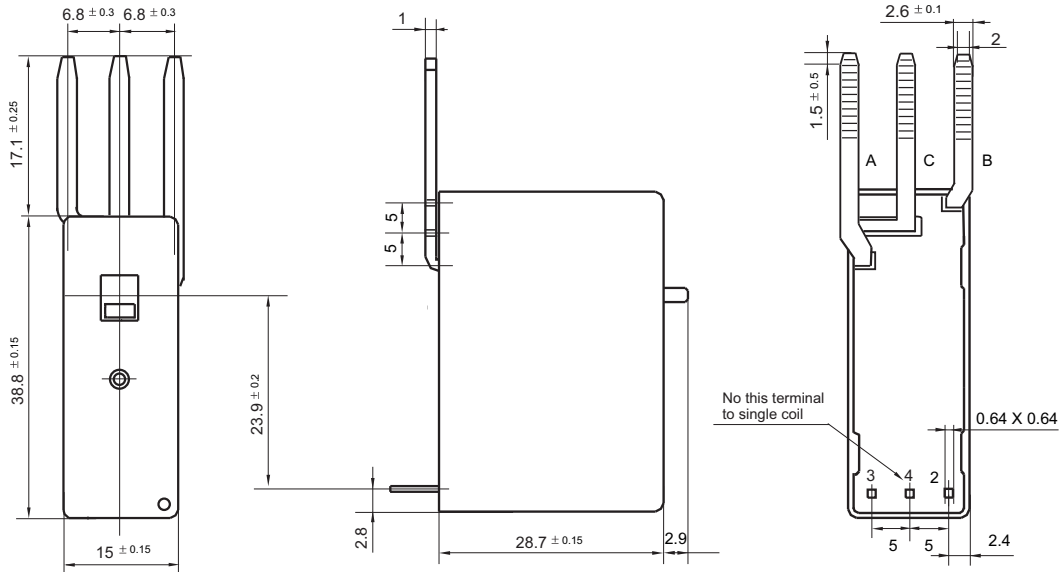

Wiring Diagram

Positive polarity

Single coil latching, 1 Form A Double coils latching, 1 Form A

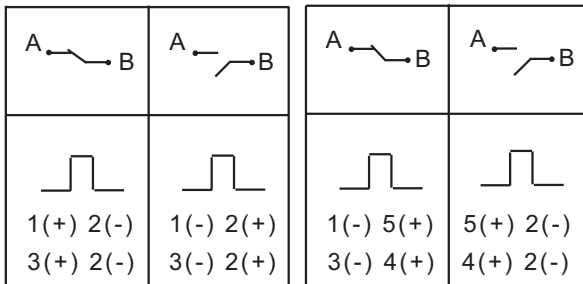

Single coil latching, 1 Form Z Double coils latching, 1 Form Z

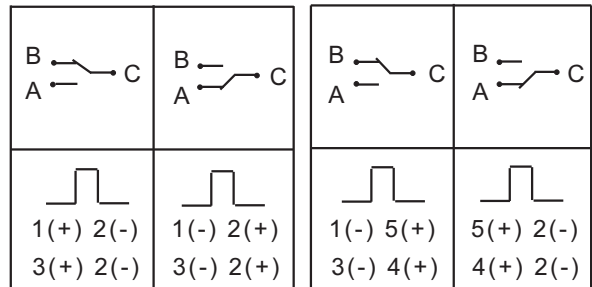

Negative polarity

Single coil latching, 1 Form A Double coils latching, 1 Form A

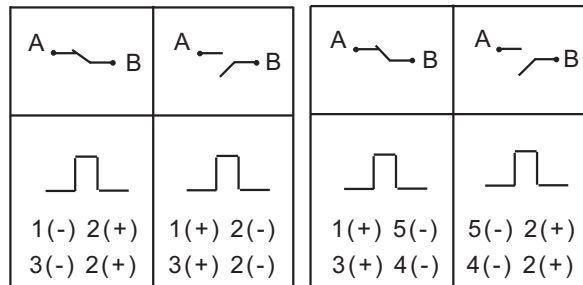

Single coil latching, 1 Form Z Double coils latching, 1 Form Z

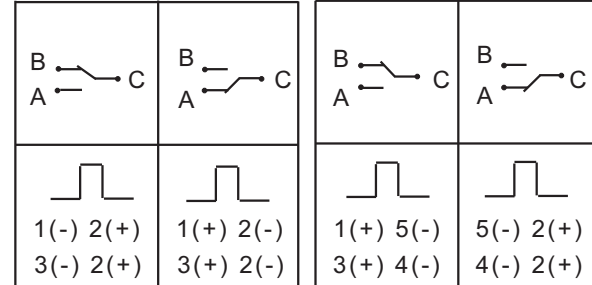

Disclaimer

The specification is for reference only. See to "Terminology and Guidelines" for more information. Specifications subject to change without notice. We could not evaluate all the performance and all the parameters for every possible application. Thus the user should be in a right position to choose the suitable product for their own application. If there is any query, please contact Hongfa for the technical service. However, it is the user's responsibility to determine which product should be used only.

© Xiamen Hongfa Electroacoustic Co., Ltd. All rights of Hongfa are reserved.