

JE12

HIGH POWER LATCHING RELAY



Features

- UC3 compliant in accordance with IEC 62055-31
- Strong resistance ability to short circuit current at 3600A (30 times more than rated load current)
- 120A switching capability
- Heavy load up to 33.24kVA
- 4kV dielectric strength (between coil and contacts)
- Environmental friendly product (RoHS compliant)
- Outline Dimensions: (52.0 x 43.0 x 22.0) mm

CONTACT DATA

| | |
|----------------------------|---|
| Contact arrangement | 1A |
| Voltage drop | Typ.: 50mV (at 10A) Max.: 250mV (at 10A) |
| Contact material | Silver alloy |
| Contact rating (Res. load) | 120A 277VAC/28VDC |
| Max. switching voltage | 440VAC |
| Max. switching current | 120A |
| Max. switching power | 33240VA/3360W |
| Mechanical endurance | 2 x 10 ⁶ OPS |
| Electrical endurance | 1 x 10 ⁴ OPS |

CHARACTERISTICS

| | | |
|---|--------------------|----------------------|
| Insulation resistance | 1000MΩ (at 500VDC) | |
| Dielectric strength (Between coil & contacts) | 4000VAC 1min | |
| Creepage distance | 8mm | |
| Operate time (at nomi. volt.) | 20ms max | |
| Release time (at nomi. volt.) | 20ms max | |
| Shock resistance | Functional | 100m/s ² |
| | Destructive | 1000m/s ² |
| Vibration resistance | 10 ~ 55Hz 1.0mm DA | |
| Humidity | 98%RH, 40°C | |
| Ambient temperature | -40°C to 70°C | |
| Termination | QC | |
| Unit weight | Approx. 100g | |
| Construction | Dust protected | |

COIL

| | |
|------------|--------------------------------------|
| Coil power | Single Coil: 2.4W; Double Coil: 4.8W |
|------------|--------------------------------------|

COIL DATA

at 23°C

| Nominal Voltage VDC | Pick-up Voltage VDC | Pulse Duration ms | Coil Resistance x (±10%) Ω | |
|---------------------|---------------------|-------------------|----------------------------|-------|
| 6 | 4.8 | 200 | Single Coil | 16 |
| 12 | 9.6 | 200 | | 60 |
| 24 | 19.2 | 200 | | 250 |
| 48 | 38.4 | 200 | | 1000 |
| 6 | 4.8 | 200 | Double Coils | 2×8 |
| 12 | 9.6 | 200 | | 2×30 |
| 24 | 19.2 | 200 | | 2×125 |
| 48 | 38.4 | 200 | | 2×500 |

Notice

1. Relay is on the "reset" status when being released from stock, with the consideration of shock risen from transit and relay mounting, relay would be changed to "set" status, therefore, when application (connecting the power supply), please reset the relay to "set" or "reset" status on request.
2. In order to maintain "set" or "reset" status, energized voltage to coil should reach the rated voltage, impulse width should be 5 times more than "set" or "reset" time. Do not energize voltage to "set" coil and "reset" coil simultaneously. And also long energized time (more than 1 min) should be avoided.
3. The terminals of relay without twisted copper wire can not be tin-soldered, can not be moved willfully, more over two terminals can not be fixed at the same time.



HONGFA RELAY

ISO9001、ISO/TS16949、ISO14001、OHSAS18001 CERTIFIED

2007 Rev. 2.00

ORDERING INFORMATION

| | | | | | | | | | | |
|-----------------------|---|--|------------------------|----|---|---|---|---|---|-------|
| Type | JE12 | | -A/ | 12 | H | T | F | 2 | R | (XXX) |
| Version | A: Type A contact terminal B: Type B contact terminal C: Type C contact terminal D: Type D contact terminal E: Type E contact terminal | | | | | | | | | |
| Coil voltage | 6, 12, 24, 48VDC | | | | | | | | | |
| Contact form | H: 1 Form A | | | | | | | | | |
| Contact material | T: Silver alloy | | | | | | | | | |
| Insulation standard | B: Class B | | F: Class F | | | | | | | |
| Sort | 1: 1 coil latching | | 2: 2 coils latching | | | | | | | |
| Polarity | R: Reverse polarity | | Nil: Standard polarity | | | | | | | |
| Customer special code | ¹⁾ Only for special requirements, e.g. (555) stands for RoHS compliant | | | | | | | | | |

Notes: 1) JE12 is an environmental friendly product. Please mark a special code (555) when ordering.

OUTLINE DIMENSIONS AND WIRING DIAGRAM

Unit: mm

Outline Dimensions

Type A contact terminal

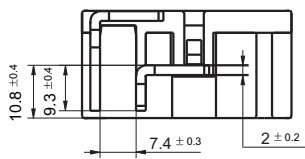

Type B contact terminal

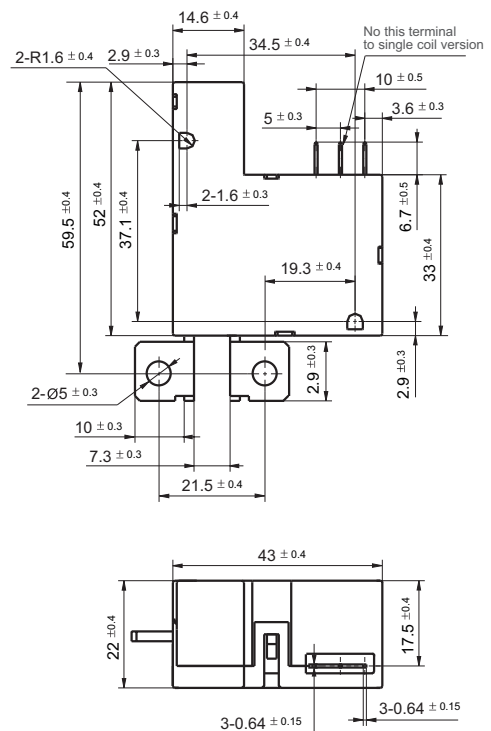
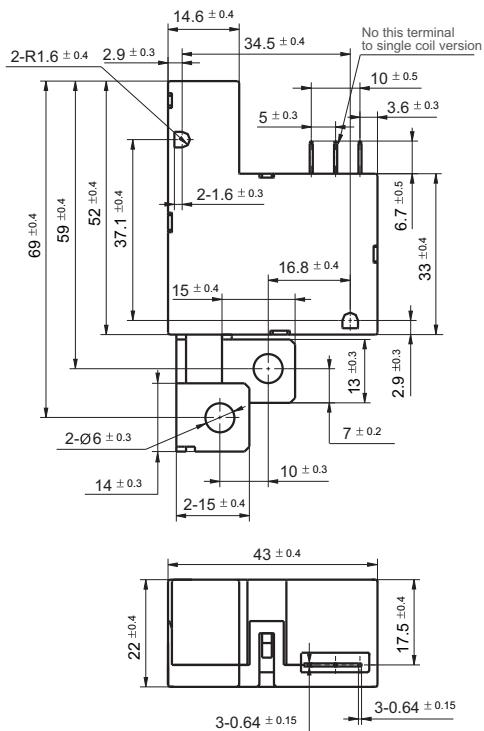
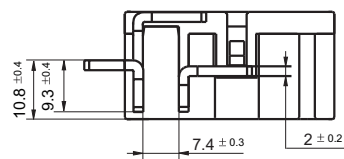

Outline Dimensions

Type C contact terminal

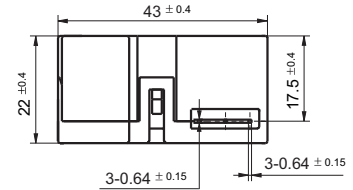
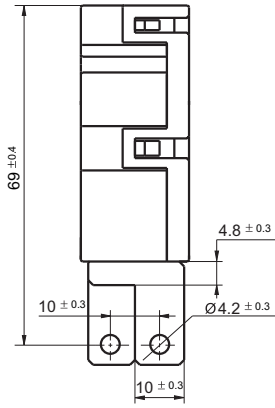
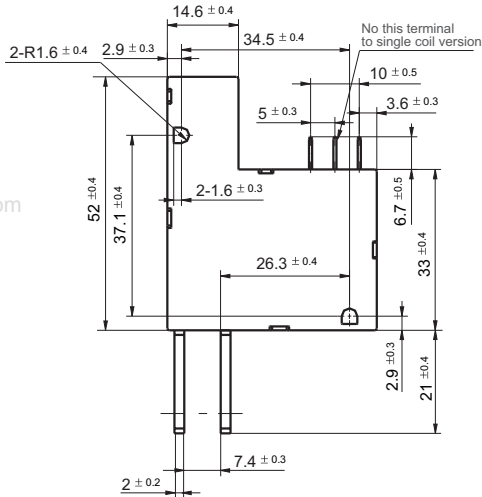

Type D contact terminal

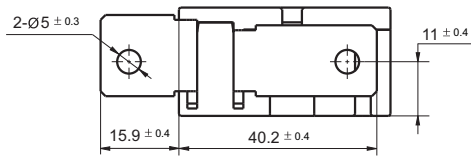

Type E contact terminal

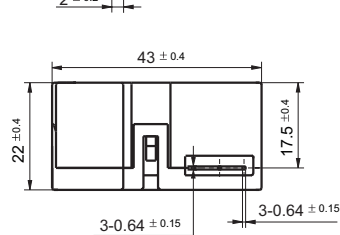
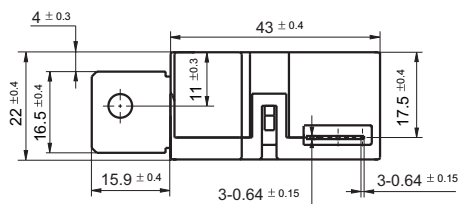
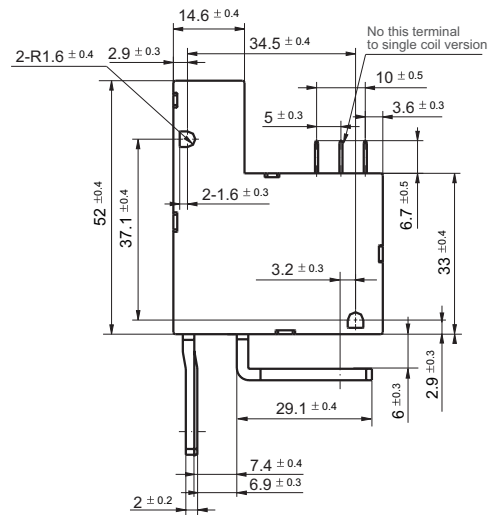
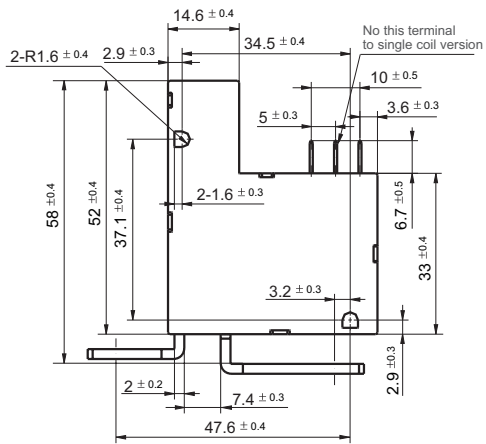
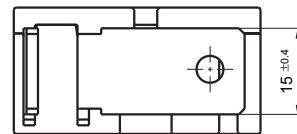

Coil Wiring Diagram

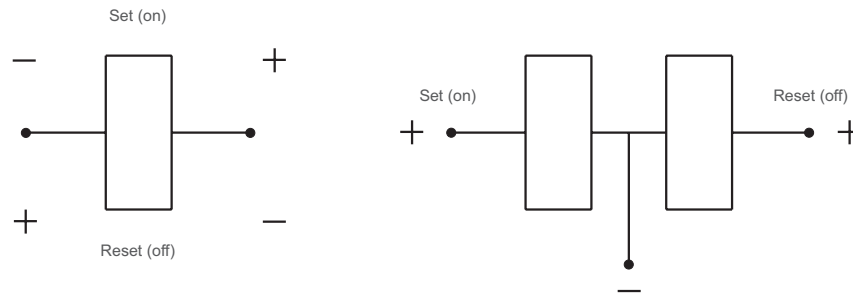

www.DataSheet4U.com

Disclaimer

This datasheet is for the customers' reference. All the specifications are subject to change without notice. We could not evaluate all the performance and all the parameters for every possible application. Thus the user should be in a right position to choose the suitable product for their own application. If there is any query, please contact Hongfa for the technical service. However, it is the user's responsibility to determine which product should be used only.

© Xiamen Hongfa Electroacoustic Co., Ltd. All rights of Hongfa are reserved.