

# K5A2 Series Snap Action Key Switch



## Features/Benefits

- Quiet actuation
- Space Saving
- RoHS compliant

## Typical Applications

- Automotive
- Computers and network equipment

## Construction

FUNCTION: Momentary action  
CONTACT ARRANGEMENT: Normally open  
TERMINALS: Gullwing type for SMT

## Mechanical

OPERATING FORCE: (6N version) 5,5 + 0,5 -1N  
3,7 + 0,8N -0,5N  
OPERATING LIFE: 50,000 operations  
TOTAL TRAVEL: 0.8 mm +/- 0.2 mm  
ELECTRICAL TRAVEL: 0,5 mm +/- 0.1 mm

## Packaging

Switches are delivered on continuous tape, in reels of 600 pieces

**NOTE:** Product to be offered as compatible with the lead free soldering profile on Q3 2006.

**Note:** Specifications listed above are for switches with standard options.  
For information on specific and custom switches, consult Customer Service Center.

## Electrical

POWER MIN / MAX: .02 VA / 1.0 VA  
VOLTAGE MIN / MAX: 20 mV DC / 30 V DC  
CURRENT MIN / MAX DC: 0.1mA / 50 mA  
CONTACT RESISTANCE: ≤100m Ω  
INSULATION RESISTANCE: ≤1 Ω  
BOUNCE TIME: 5ms

## Environmental

OPERATING TEMPERATURE: -40° C TO 85° C  
STORAGE TEMPERATURE: -50° C TO 85° C

## Process

SOLDERING: Lead free reflow compatible in accordance with CEI 60068-2-58

## Materials

CONTACTS: Au over Ni  
SOLDERING: Au  
HOUSING: Thermoplastic UL 94 H-B

## How To Order

Our easy build-a-switch concept allows you to mix and match options to create the switch you need. To order, select desired option from each category and place it in the appropriate box.

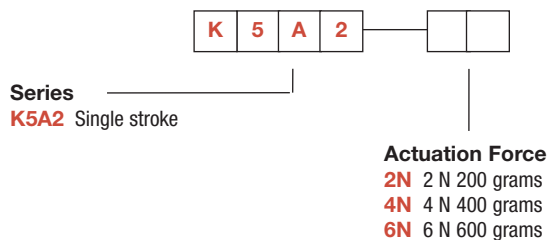

# K5A2 Series Snap Action Key Switch

**K5A2** WITH LED

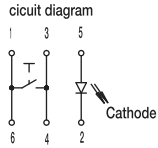
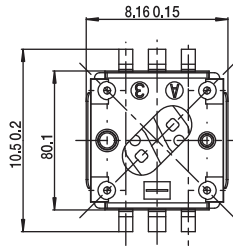

## PCB LAYOUT, MOUNTING SIDE

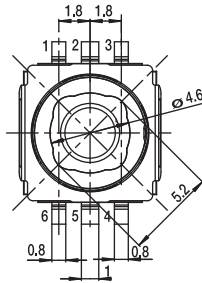
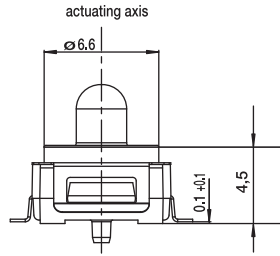
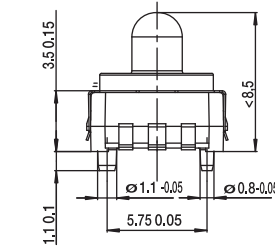
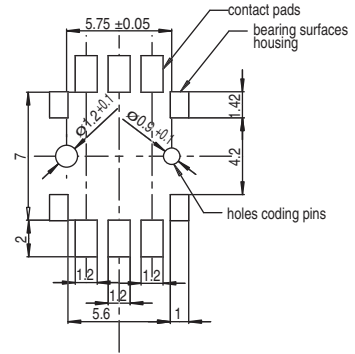

Key Switches

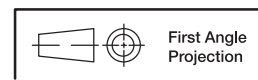

Dimensions are shown: mm (inch)  
Specifications and dimensions subject to change

www.ittcannon.com