

KBPC8005 THRU KBPC810

8A SINGLE-PHASE SILICON BRIDGE RECTIFIERS

Features

- Surge overload rating-125 amperes peak
- Low forward voltage drop
- Small size: simple installation
- Silver Plated Copper leads
- Mounting Position: Any

VOLTAGE RANGE
50 to 1000 Volts PRV
CURRENT
8 Amperes

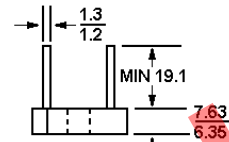
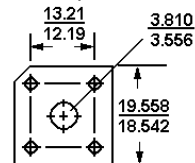

Polarity shown on side of case;
positive lead by beveled corner.

Dimensions in mm

Absolute Maximum Ratings and Characteristics

Rating at 25°C ambient temperature unless otherwise specified.
For capacitive load, derate current by 20%.

	KBPC 8005	KBPC 801	KBPC 802	KBPC 804	KBPC 806	KBPC 808	KBPC 810	Units
Maximum Recurrent Peak Reverse Voltage	50	100	200	400	600	800	1000	V
Maximum RMS Bridge Input Voltage	35	70	140	280	420	560	700	V
Maximum Average Forward Rectified Output Current at $T_C = 100^\circ\text{C}^*$ $T_A = 40^\circ\text{C}^{**}$	8							A
	3							A
Peak Forward Surge Current, 8.3ms single half sine-wave superimposed on rated load	125							A
Maximum Forward Voltage Drop per Bridge element at 4.0A Peak.	1.1							V
Maximum Reverse Current at Rated DC Blocking Voltage per element	10							uA
	1							mA
Operating Temperature Range T_C	-55 to +125							°C
Storage Temperature Range T_A	-55 to +150							°C

Notes: * Unit mounted on metal chassis

** Unit mounted on P.C. board

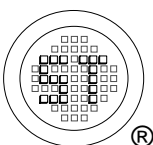

SEMTECH ELECTRONICS LTD.
Subsidiary of Sino-Tech International (BVI) Limited



Dated : 03/10/2003

KBPC8005 THRU KBPC810

RATINGS AND CHARACTERISTIC CURVES (KBPC8 SERIES)

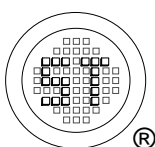
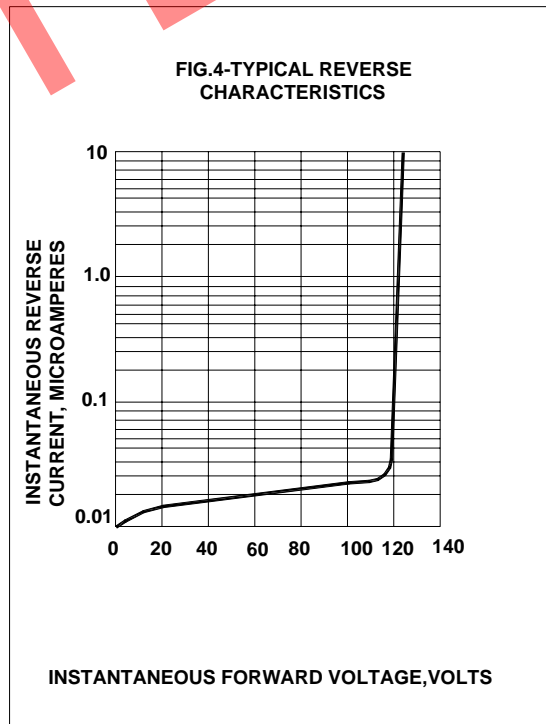
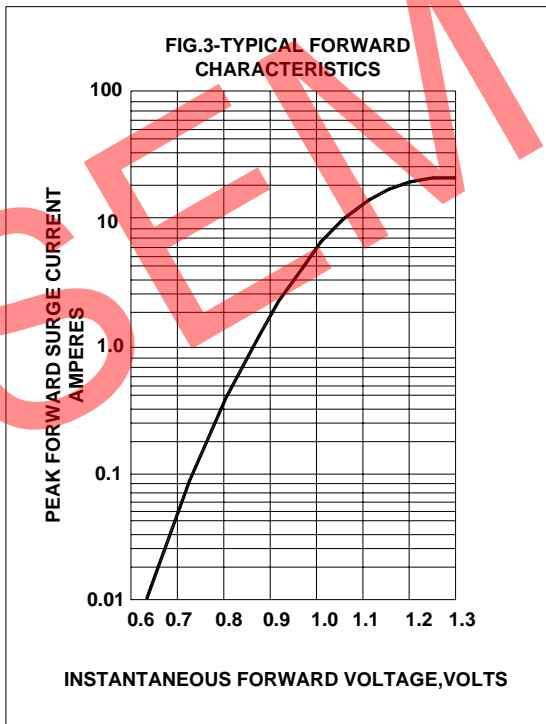
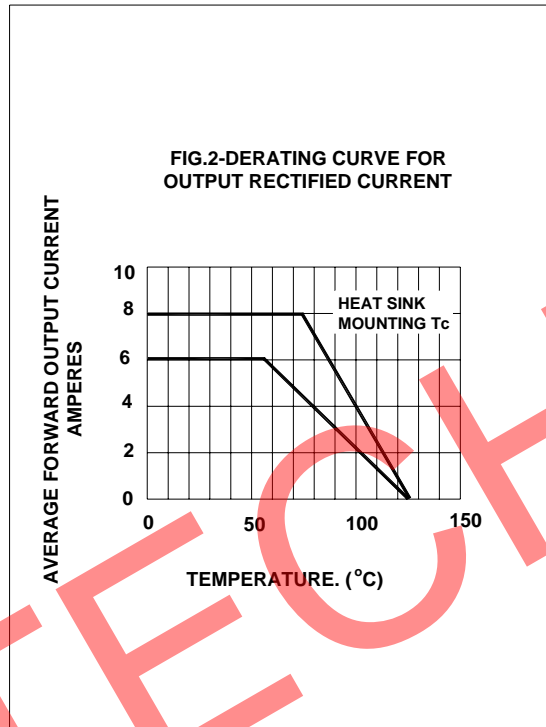
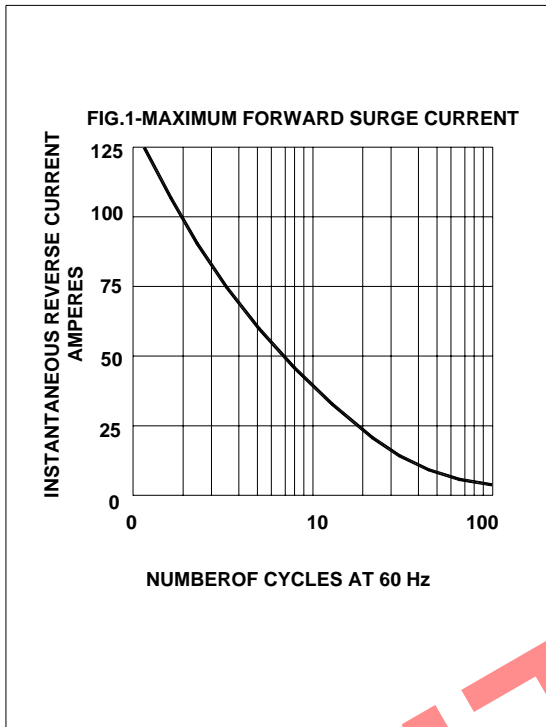

SEMTECH ELECTRONICS LTD.
 Subsidiary of Sino-Tech International (BVI) Limited



Dated : 03/10/2003