

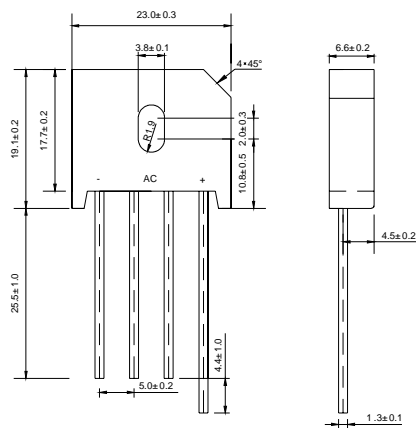

Silicon Bridge Rectifiers

CURRENT: 4.0 A

KBU



Dimensions in millimeters

Ratings at 25°C ambient temperature unless otherwise specified.

Single phase, half wave, 60 Hz resistive or inductive load. For capacitive load, derate by 20%.

		KBU 4A	KBU 4B	KBU 4D	KBU 4G	KBU 4J	KBU 4K	KBU 4M	UNITS
Maximum recurrent peak reverse voltage	V_{RRM}	50	100	200	400	600	800	1000	V
Maximum RMS voltage	V_{RMS}	35	70	140	280	420	560	700	V
Maximum DC blocking voltage	V_{DC}	50	100	200	400	600	800	1000	V
Maximum average forward output current @ $T_A=50^{\circ}C$	$I_{F(AV)}$	4.0							A
Peak forward surge current 8.3ms single half-sine-wave superimposed on rated load	I_{FSM}	150.0							A
Maximum instantaneous forward voltage @ 2.0 A	V_F	1.0							V
Maximum reverse current @ $T_A=25^{\circ}C$ at rated DC blocking voltage @ $T_A=100^{\circ}C$	I_R	10.0 1.0							μA mA
Operating junction temperature range	T_J	- 55 ---- + 125							$^{\circ}C$
Storage temperature range	T_{STG}	- 55 ---- + 150							$^{\circ}C$

Ratings AND Characteristic Curves

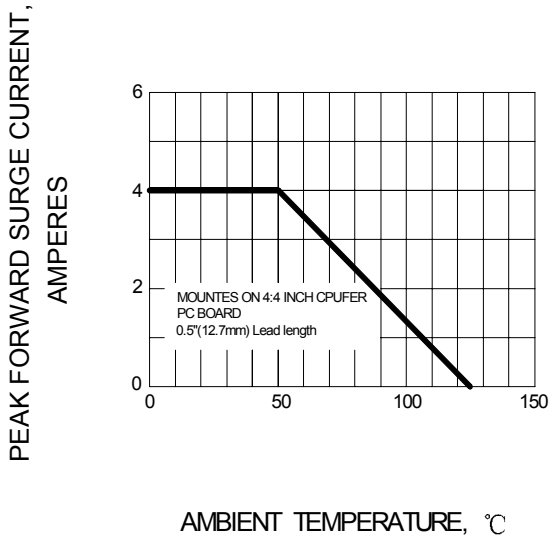
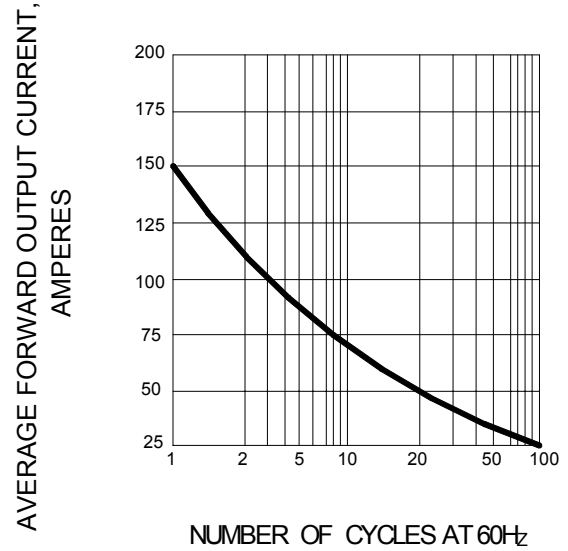
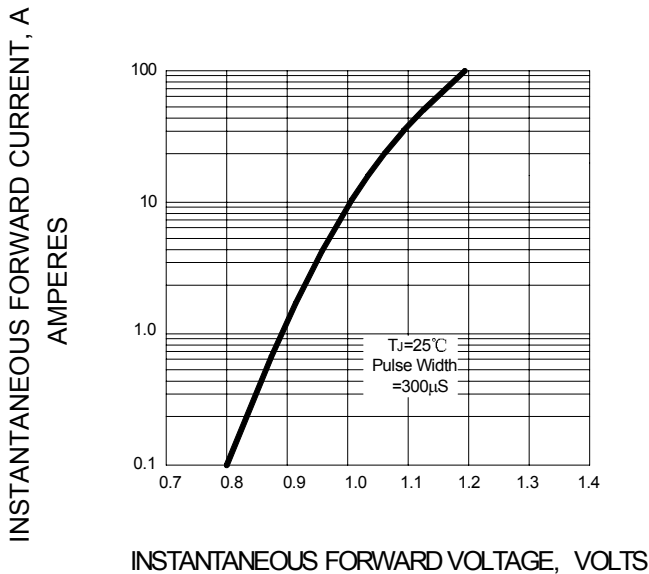
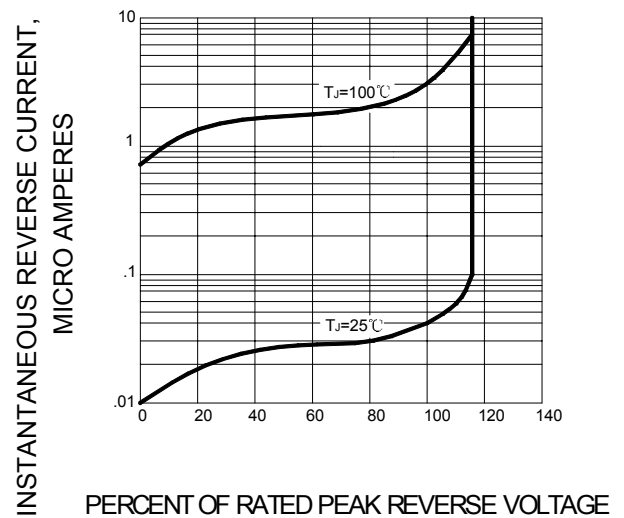
FIG.1 – TYPICAL FORWARD CURRENT DERATING CURVE

FIG.2 – MAXIMUM FORWARD SURGE CURRENT

FIG.3 – TYPICAL FORWARD CHARACTERISTIC

FIG.4 – TYPICAL REVERSE CHARACTERISTIC

FIG.5 – TYPICAL JUNCTION CAPACITANCE PER ELEMENT
