

K_5N series Ø38 mm 5.4-15 W

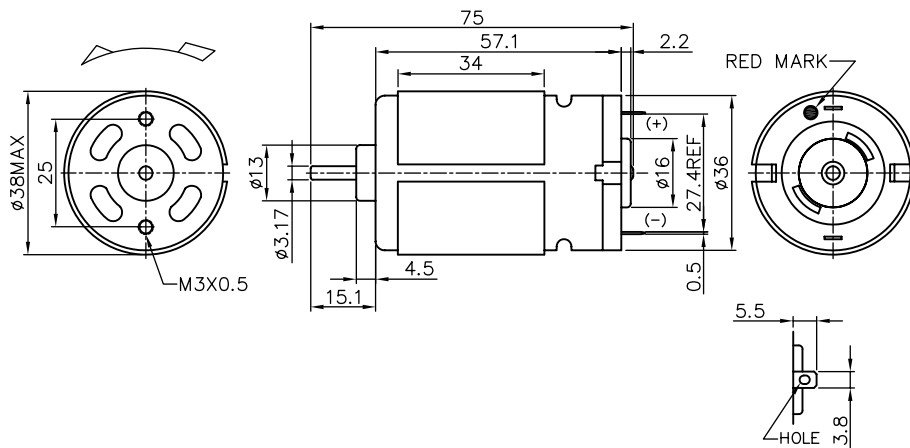

Model - -
 Carbon brush = C V = Varistor
 Metal brush = M C = Capacitor

MOTOR DATA

| Part name | KD5N-4525-CVC | KP5N-18150-CVC | KS5N-18130-CVC | KP5N-3732-CVC |
|------------------------------|---------------|----------------|----------------|---------------|
| Diameter (mm) | 38 | 38 | 38 | 38 |
| Length (mm) | 57 | 57.1 | 57.1 | 57.1 |
| Nominal voltage (V) | 6 | 24 | 24 | 12 |
| Nominal speed (rpm) | 4300 | 3000 | 3300 | 7200 |
| Nominal torque (mNm) | 24.5 | 20.7 | 15.3 | 20.3 |
| Nominal current A | 2.7 | 0.4 | 0.4 | 1.8 |
| No load speed (rpm) | 5500 | 3700 | 4000 | 8400 |
| No load current A | 0.70 | 0.95 | 0.09 | 0.28 |
| Stall torque (mNm) | 133.3 | 119.0 | 110.0 | 180.1 |
| Starting current (A) | 12.5 | 2.0 | 2.1 | 13.8 |
| Output (W) | 11 | 6.6 | 5.4 | 15 |
| Efficiency (%) | 69 | 69 | 65 | 71 |
| Operating temperature deg. C | -10..+60 | -10..+60 | -10..+60 | -10..+60 |

K_3SFN series Ø39 mm 46-95 W

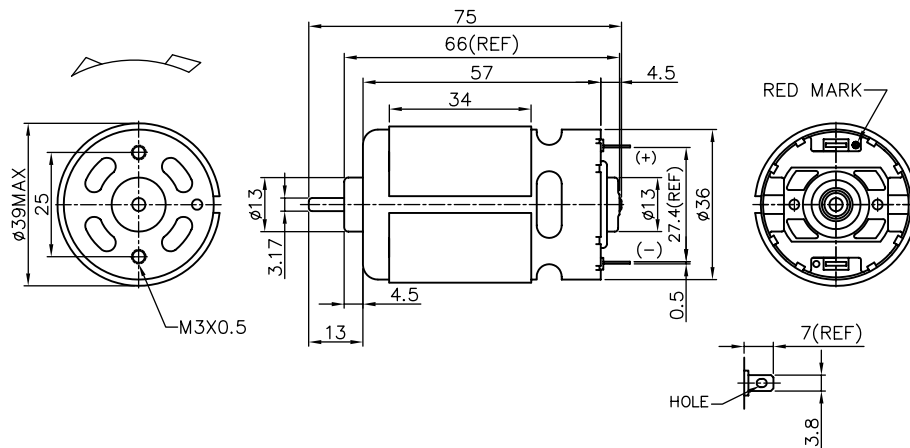

Model - -
 Carbon brush = C V = Varistor
 Metal brush = M C = Capacitor

MOTOR DATA

| Part name | KD3SFN-8518-CC | KS3SFN-7520F-CC | KP3SFN-8020F-CC | KV3SFN-7525F-CC |
|------------------------------|----------------|-----------------|-----------------|-----------------|
| Diameter (mm) | 39 | 39 | 39 | 39 |
| Length (mm) | 57 | 57 | 57 | 57 |
| Nominal voltage (V) | 6 | 7.2 | 7.2 | 12 |
| Nominal speed (rpm) | 12000 | 12300 | 12400 | 15800 |
| Nominal torque (mNm) | 36.1 | 41.5 | 40.1 | 57.3 |
| Nominal current A | 10.2 | 10.4 | 9.6 | 9.8 |
| No load speed (rpm) | 13000 | 15000 | 14400 | 17600 |
| No load current A | 6.00 | 1.30 | 1.50 | 1.20 |
| Stall torque (mNm) | 391.2 | 277.5 | 343.7 | 527.5 |
| Starting current (A) | 95.2 | 60.4 | 71.5 | 82.5 |
| Output (W) | 46 | 54 | 52 | 95 |
| Efficiency (%) | 75 | 72 | 76 | 81 |
| Operating temperature deg. C | -10..+60 | -10..+60 | -10..+60 | -10..+60 |