

Silicon PIN Photodiode KDP6004A

Description

The KDP6004A is high-speed silicon pin photodiode in COB package and responds to wavelengths from 700nm to 1050nm.

Features

- High sensitive Si PIN Photodiode
- Chip on Board Package
- High Speed Response

Applications

- IR Remote Control Module
- High Speed Detector

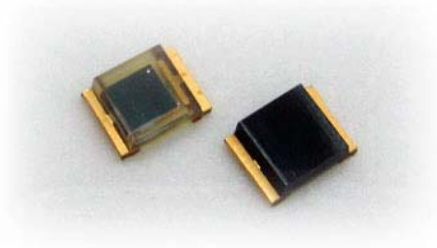

Outline Dimensions

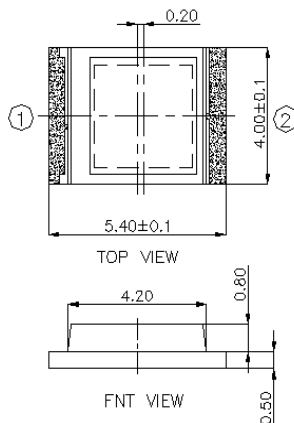

NOTES

1. Pin Description

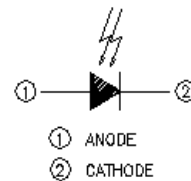

2. General Tolerance

± 0.1 mm

3. Unit : mm

Characteristics

[Ta= 25°C]

| Description | Symbol | Condition | Min. | Typ. | Max. | Unit |
|---------------------------|-------------|---------------------------------------|----------|----------|------|---------------|
| Open Circuit Voltage | V_{OP} | $E_V=1000\text{Lux}^{*1}$ | 300 | 380 | | mV |
| Short Circuit Current | I_{SC} | $E_V=1000\text{Lux}^{*1}$ | | 90 | | μA |
| Reverse Dark Current | I_D | $V_R=10\text{V}, E=0$ | | 2 | 10 | nA |
| Light Current | I_L | $V_R=5\text{V}, E=1000\text{Lux}$ | 50 | | | μA |
| Diode Capacitance | C_D | $V_R=3\text{V}, f=1\text{MHz}, E=0$ | | 25 | 40 | pF |
| Spectral Sensitivity | λ | | 700~1050 | | | nm |
| Peak Wavelength | λ_p | | | 970 | | nm |
| Angle of Half Sensitivity | ψ | | | ± 65 | | deg |
| Rise Time | t_r | $V_R=10\text{V}, R_L=1\text{k}\Omega$ | | 150 | | ns |
| Fall Time | t_f | $V_R=10\text{V}, R_L=1\text{k}\Omega$ | | 150 | | ns |