

Piezoelectric Telephone Receiver

KPEG006

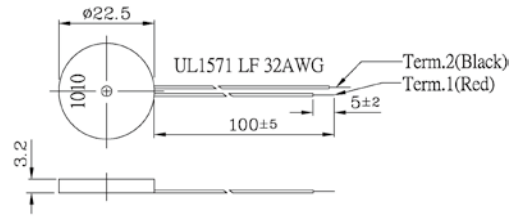

Dimension



Tol: ± 0.5 Unit: mm

Electrostatic capacity (PF)	90,000 ± 30% @ 120Hz/0.25V
Sound Pressure Level (dB)	108 ± 3 @ 1.0KHz 1.0V with IEC318 Coupler
Impedance (Ω)	2.0K ± 25% @ 1.0KHz
Frequency Range (Hz)	400 ~ 4K
Operating Temperature (°C)	-30 ~ +85
Dimension (mm)	Φ22.5x H3.2
Material	ABS UL-94 1/16" HB High Heat (Black)

Characteristic

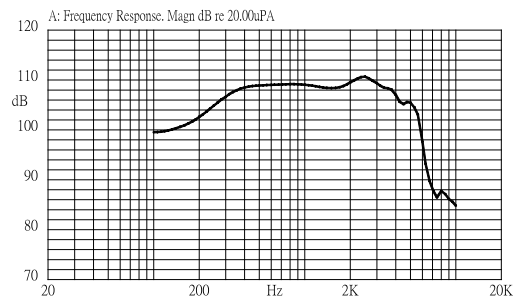

Round Type

Dynamic Receiver

KDRG057016A



Dimension

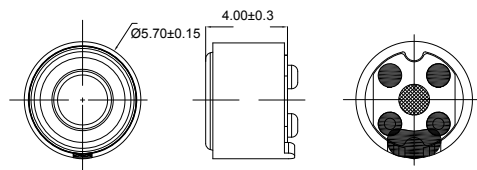

Tol: ± 0.5 Unit: mm

Rated Power (mW)	3.0
Max. Input Power (mW)	5.0
Sound Pressure Level (dB)	92.7 ± 3 @ 1.0KHz 126mV with IEC318 Coupler
Impedance (Ω)	16 ± 15% @ 1.5KHz
Frequency Range (Hz)	100 ~ 10K
Operating Temperature (°C)	-20 ~ +55
Dimension (mm)	Φ5.7xH4.0
Material	Metal

Characteristic

