



**Technical Data**

**PST KP1007**

**HIGH POWER PHASE CONTROL THYRISTOR  
FOR PHASE CONTROL APPLICATIONS**

**Features :**

- Blocking Capability up to 2600 V
- High dV/dt Capability
- All Diffused Structure
- Amplifying Gate Configuration
- Rugged Ceramic Hermetic Package

**ELECTRICAL CHARACTERISTICS AND RATINGS**

**Blocking**

Parameter	Symbol	Min	Max	Typ	Unit	Conditions
Repetitive peak reverse voltage	$V_{RRM}$		2600		V	$T_j = -40\text{ }^\circ\text{C}$ to $125\text{ }^\circ\text{C}$
Repetitive peak off-state voltage	$V_{DRM}$		2600		V	$T_j = -40\text{ }^\circ\text{C}$ to $125\text{ }^\circ\text{C}$
Non repetitive peak reverse voltage	$V_{RSM}$		2700		V	$T_j = -40\text{ }^\circ\text{C}$ to $125\text{ }^\circ\text{C}$
Repetitive peak reverse current	$I_{RRM}$		50		mA	$T_j = T_{jmax}$ , $V = V_{RRM}$
Repetitive peak off-state current	$I_{DRM}$		50		mA	$T_j = T_{jmax}$ , $V = V_{DRM}$

**Conducting**

Parameter	Symbol	Min	Max	Typ	Unit	Conditions
Average value of on-state current	$I_{T(AV)}$		1040		A	50 Hz sine wave, $180^\circ$ conduction, $T_c = 85\text{ }^\circ\text{C}$
RMS value of on-state current	$I_{T(RMS)}$		1633		A	50 Hz sine wave, $180^\circ$ conduction, $T_c = 85\text{ }^\circ\text{C}$
Surge non repetitive current	$I_{TSM}$		20		kA	50 Hz sine wave Half cycle
I square t	$I^2 t$		2000		$\text{kA}^2\text{s}$	$V_R = 0$ $T_j = T_{jmax}$
Peak on-state voltage	$V_{TM}$		2.02		V	On-state current 2900 A, $T_j = T_{jmax}$
Threshold voltage	$V_{T(TO)}$		1.12		V	$T_j = T_{jmax}$
On-state slope resistance	$r_T$		0.31		$\text{m}\Omega$	$T_j = T_{jmax}$
Holding current	$I_H$			400	mA	$V_D = 12\text{ V}$ ; $I_T = 2.5\text{ A}$
Latching current	$I_L$			800	mA	$V_D = 12\text{ V}$ ; $R_L = 12\ \Omega$

# PST KP1007

## HIGH POWER PHASE CONTROL THYRISTOR

### Triggering

Parameter	Symbol	Min	Max	Typ	Unit	Conditions
Gate current	$I_{GT}$		350		mA	$V_D = 6\text{ V}, R_L = 3\ \Omega, T_j = -40\ ^\circ\text{C}$
			300		mA	$V_D = 6\text{ V}, R_L = 3\ \Omega, T_j = 25\ ^\circ\text{C}$
			125		mA	$V_D = 6\text{ V}, R_L = 3\ \Omega, T_j = 125\ ^\circ\text{C}$
Gate voltage	$V_{GT}$		5		V	$V_D = 6\text{ V}, R_L = 3\ \Omega, T_j = -40\ ^\circ\text{C}$
			3.5		V	$V_D = 6\text{ V}, R_L = 3\ \Omega, T_j = 0 \div 125\ ^\circ\text{C}$
		0.3			V	$V_D = V_{DRM}, R_L = 1\ \text{k}\Omega, T_j = 125\ ^\circ\text{C}$
Peak gate current	$I_{GM}$		10		A	
Peak reverse gate voltage	$V_{RGM}$		5		V	
Peak gate power dissipation	$P_{GM}$		200		W	
Average gate power dissipation	$P_{G(AV)}$		5		W	

### Switching

Parameter	Symbol	Min	Max	Typ	Unit	Conditions
Critical rate of rise of on-state current	$di/dt$		200		A/ $\mu\text{s}$	$I_G = 5 \cdot I_{GT}, t_r = 1\ \mu\text{s}, V_{DRM} \leq 1500\text{V}, T_j = T_{jmax}$
Critical rate of rise of on-state voltage	$dv/dt$		500		V/ $\mu\text{s}$	Linear ramp up to 80% of $V_{DRM}$
Gate controlled delay time	$t_d$			3	$\mu\text{s}$	$I_{TM} = 50\text{ A}, V_D = 67\% V_{DRM}, V_G = 20\text{ V}$ $R_G = 20\ \Omega, t_r = 0.1\ \mu\text{s}, t_p = 20\ \mu\text{s}$
Turn-off time	$t_q$			350	$\mu\text{s}$	$I_{TM} = 900\text{ A}; di/dt = 10\text{ A}/\mu\text{s}; V_R \geq 100\text{ V}$ $dV/dt = 20\text{ V}/\mu\text{s}$ linear to 67% $V_{DRM}$ $V_G = 0\text{ V}; T_j = T_{jmax}$
Reverse recovery charge	$Q_{rr}$				$\mu\text{C}$	$I_T = 500\text{ A}$ $di/dt = 20\text{ A}/\mu\text{s}$
Reverse recovery current	$I_{rr}$				A/ $\mu\text{s}$	$V_R \geq 50\text{ V}$ $T_j = T_{jmax}$

### Thermal and mechanical

Parameter	Symbol	Min	Max	Typ	Unit	Conditions
Operating temperature	$T_j$	-40	125		$^\circ\text{C}$	
Storage temperature	$T_{stg}$	-40	150		$^\circ\text{C}$	
Thermal resistance junction to case	$R_{th(j-c)}$		0.020		$^\circ\text{C}/\text{W}$	Double side cooled, 180° SIN
Thermal resistance case to sink	$R_{th(c-s)}$		0.006		$^\circ\text{C}/\text{W}$	Double side cooled, mounting surfaces smooth, flat and greased
Mounting force	$F$	20	24		kN	
Weight	$W$			480	g	

# PST KP1007

## HIGH POWER PHASE CONTROL THYRISTOR

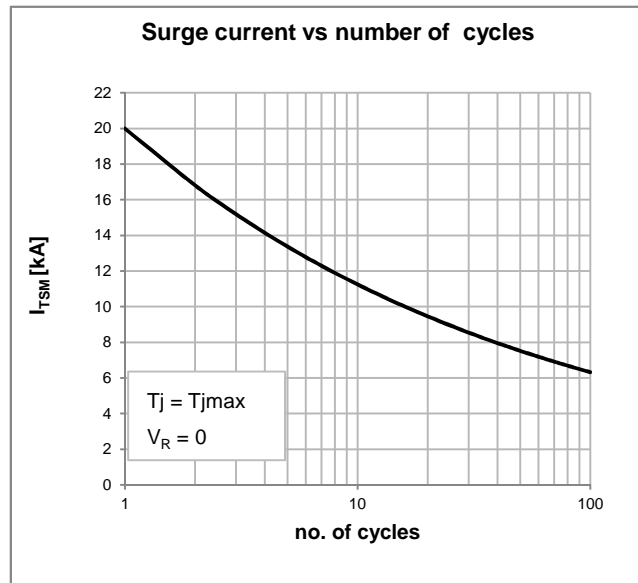
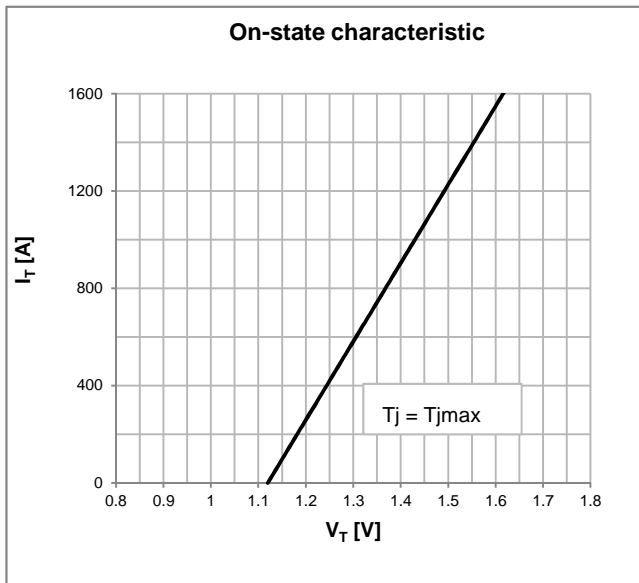
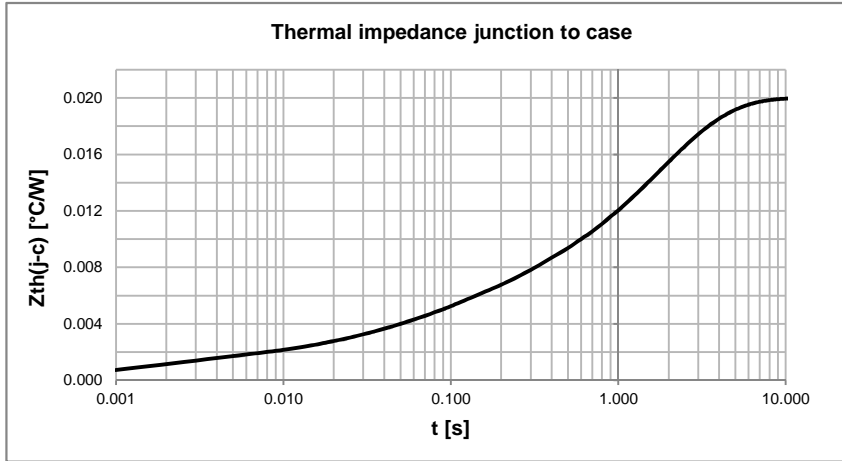

### OUTLINE AND DIMENSIONS

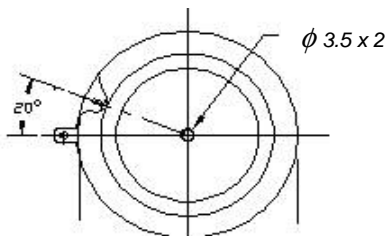

	A	B	C	E
mm	47	75	66	26 ± 0.5

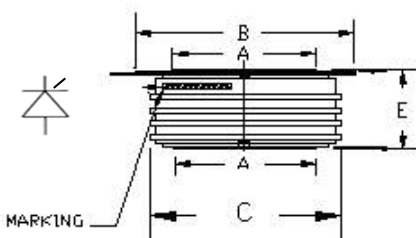

- All the characteristics given in this data sheet are guaranteed only with uniform clamping force, cleaned and lubricated heatsink surfaces with flatness < 0.03 mm and roughness < 2µm