

NPN Silicon Epitaxial Planar Transistor

KTC4379

FEATURES

- High speed switching time.
- Low saturation voltage: $V_{CE(sat)}=0.5V(\text{Max})$.
- $P_C=1\sim 2W$ (Mounted on ceramic substrate).
- Small flat package.
- Complementary: KTA1666.



Lead-free

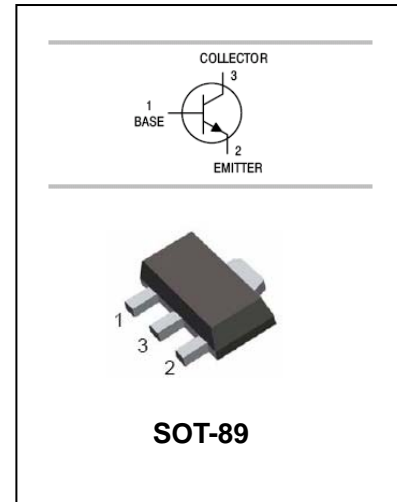

APPLICATIONS

- Power amplifier application.
- Power switching application.

ORDERING INFORMATION

Type No.	Marking	Package Code
KTC4379	UO/UY	SOT-89

MAXIMUM RATING @ $T_a=25^\circ\text{C}$ unless otherwise specified

Symbol	Parameter	Value	Units
V_{CBO}	Collector-Base Voltage	50	V
V_{CEO}	Collector-Emitter Voltage	50	V
V_{EBO}	Emitter-Base Voltage	5	V
I_C	Collector Current -Continuous	2	A
I_B	Base Current	0.4	A
P_C	Collector Dissipation	500	mW
T_j, T_{stg}	Junction and Storage Temperature	-55 to +150	$^\circ\text{C}$

NPN Silicon Epitaxial Planar Transistor

KTC4379

ELECTRICAL CHARACTERISTICS @ Ta=25°C unless otherwise specified

Parameter	Symbol	Test conditions	MIN	TYP	MAX	UNIT
Collector-base breakdown voltage	$V_{(BR)CBO}$	$I_C=1mA, I_E=0$	50			V
Collector-emitter breakdown voltage	$V_{(BR)CEO}$	$I_C=10mA, I_B=0$	50			V
Emitter-base breakdown voltage	$V_{(BR)EBO}$	$I_E=1mA, I_C=0$	5			V
Collector cut-off current	I_{CBO}	$V_{CB}=50V, I_E=0$			0.1	μA
Emitter cut-off current	I_{EBO}	$V_{EB}=5V, I_C=0$			0.1	μA
DC current gain	h_{FE}	$V_{CE}=2V, I_C=500mA$	70		240	
		$V_{CE}=2V, I_C=1.5A$	40			
Collector-emitter saturation voltage	$V_{CE(sat)}$	$I_C=1A, I_B=50mA$			0.5	V
Base-emitter saturation voltage	$V_{BE(sat)}$	$I_C=1A, I_B=50mA$			1.2	V
Transition frequency	f_T	$V_{CE}=2V, I_C=0.5A$		120		MHz
Collector output capacitance	C_{ob}	$V_{CB}=10V, I_E=0, f=1MHz$		30		pF

CLASSIFICATION OF $h_{FE(1)}$

Rank	O	Y
Range	70-140	120-240
MARKING	UO	UY

NPN Silicon Epitaxial Planar Transistor

KTC4379

TYPICAL CHARACTERISTICS @ Ta=25°C unless otherwise specified

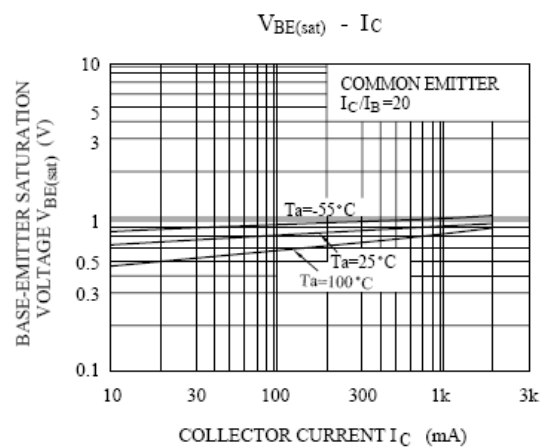
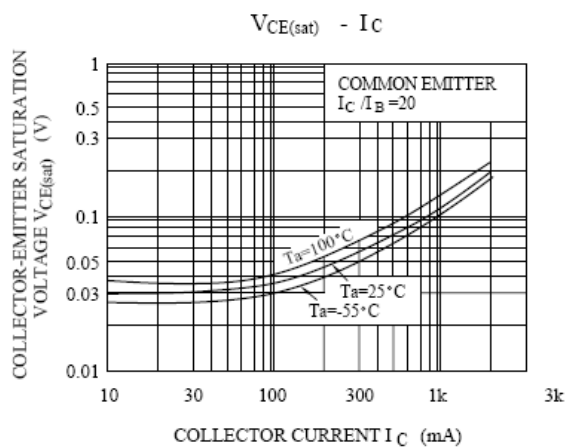
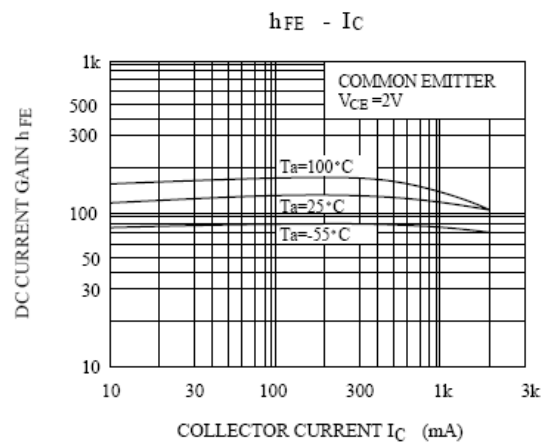
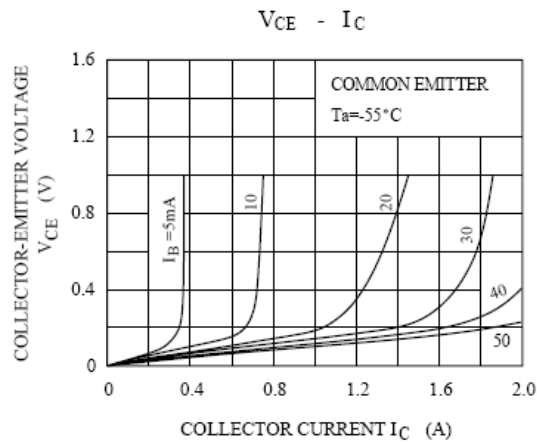
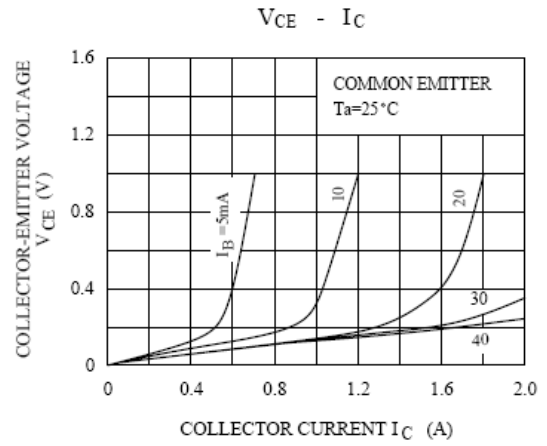
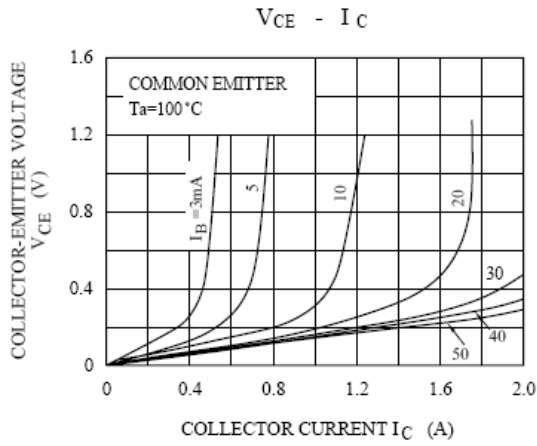

NPN Silicon Epitaxial Planar Transistor

KTC4379

PACKAGE OUTLINE

Plastic surface mounted package

SOT-89

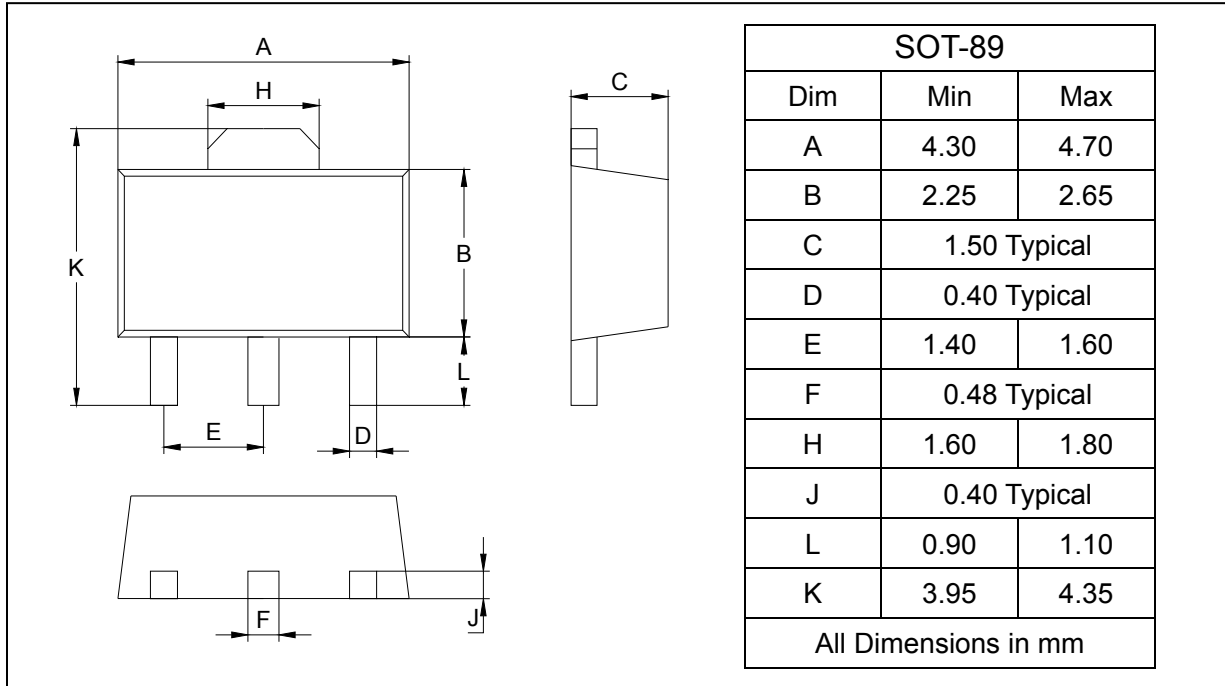

SOLDERING FOOTPRINT

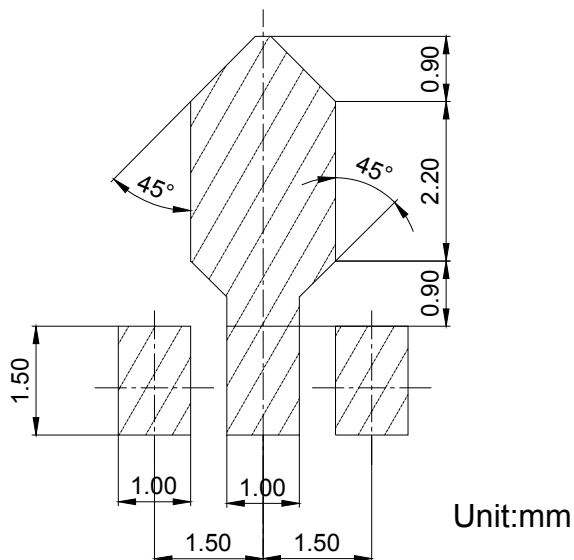

PACKAGE INFORMATION

Device	Package	Shipping
KTC4379	SOT-89	1000/Tape&Reel