

LC218

S-Beam Load Cells

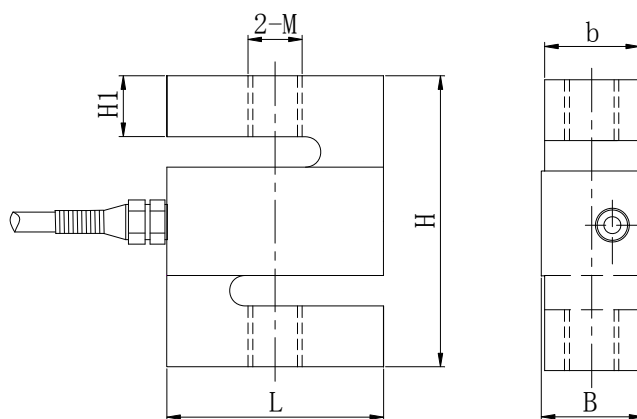

Dimensions:



Unit: mm(inch)

Cap/Size	L	H	b	B	M	H1
50kg,100kg 0.05~0.3klb	50.8(2.0)	63.5(2.5)	12.7(0.5)	16.08(0.63)	M8 1/4-28UNF	10.16 (0.4)
250kg,500kg 0.5~1.5klb	50.8(2.0)	63.5(2.5)	19.05(0.75)	22.43(0.88)	M12 1/2-20UNF	
1t /2,2.5klb	50.8(2.0)	63.5(2.5)	25.4(1.0)	28.78(1.13)	M12 1/2-20UNF	
2.5t/ 3klb	50.8(2.0)	101.6(4.0)	25.4(1.0)	28.78(1.13)	M20×1.5 1/2-20UNF	15.24 (0.6)
5t/ 5,10klb	76.2(3.0)	101.6(4.0)	25.4(1.0)	28.78(1.13)	M20×1.5 3/4-16UNF	20 (0.79)
7.5t /15klb	101.6(4.0)	139.7(5.5)	31.75(1.25)	35.13(1.38)	M24×2 1-14UNF	31 (1.22)
20klb	127(5.0)	177.8(7.0)	50.8(2.0)	54.18(2.13)	5/4-12UNF	39.9(1.57)

Product Characteristics:

S-Beam Load Cells/Tension Load Cells LC218 Load cell are available in the capacities 50kg~10t;50lb~20klb. They offer alloy steel or total stainless steel construction, complete hermetic sealing, oil proof, water proof and anti-corrosion making them suitable for use in all kinds of environments. S-Beam Load Cells LC218 are used to tank weighing, hopper weighing, conveyor weighing, scale conversion. Tension S-cells are designed for use with suspended tanks.

Technical Parameter:

Rated Load:	0.05/0.1/0.25/0.5/1/2.5/5/7.5/10t 50/75/100/150/200/300/500/750/1k/1.5k/2k/2.5k/3k/5k/10k/15k/20klb
Sensitivity:	(2.0±0.1%) mV/V
Combined Error:	±0.02% F.S
Creep Error (30min) :	±0.02% F.S
Zero Balance:	±1% F.S
Temp. Effect On Zero:	±0.02% F.S/10°C
Temp. Effect On Span:	±0.02% F.S/10°C
Input Resistance:	385±5Ω
Output Resistance:	352±2Ω
Insulation Resistance:	≥5000MΩ
Operating Temperature Range:	-30~+70°C
Maximum Safe Over Load:	150%F.S
Ultimate Over Load:	300%F.S
Recommend Excitation Voltage:	10~12V DC
Maximum Excitation Voltage:	15V DC
Sealing Class:	IP67/IP68
Element Material:	Alloy Steel, Stainless Steel
Cable:	Length=L:2m
Citation:	GB/T7551-2008/ OIML R60
Mode Of Connection:	Red(Input+),Black(Input-),Green(Output+),White(Output-)