

LC219

Universal S-Type Load Cells

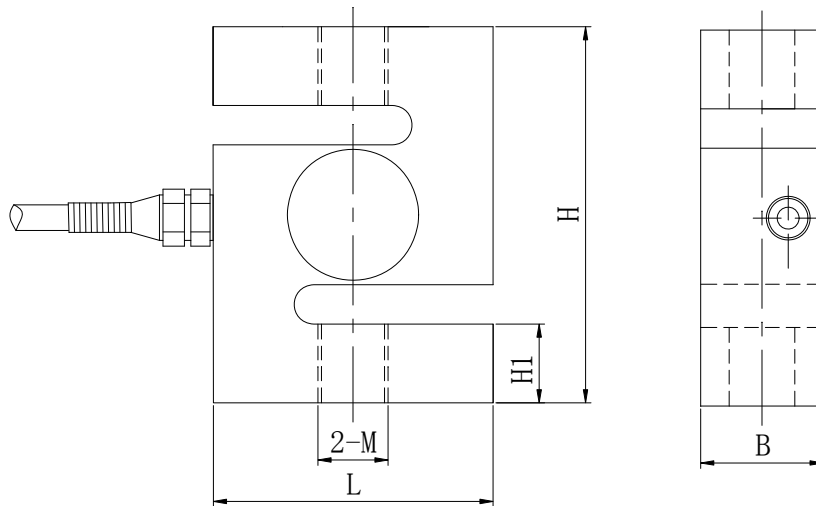

Dimensions:



Unit: mm(inch):

Cap./Size	L	H	B	M	H1
7.5~10t	125(4.92)	175(6.89)	50(1.97)	M33×3	40.2(1.58)
15~20t	160(6.3)	200(7.89)	60(2036)	M42×3	51(2.01)
30t	190(7.48)	230(9.06)	80(3.15)	M42×3	57.5(2.26)

Product Characteristics:

Universal S-type load cells LC219 manufactured SAINTBOND, with various versions and capacities. Universal S-type load cells LC219 may be used in tension or compression. These load cells are available in both metric and imperial versions. Universal S-type load cells LC219 is a complete range of precision 'S' Beam Load Cells designed for Tension/Compression and Bi-Directional testing. Typical uses are in materials test machines, platform, hopper and tank weighing systems, conveyors, overhead track scales and for general in-line load measurement applications.

Technical Parameter:

Rated Load:	7.5/10/15/20/30t
Sensitivity:	(2.0±0.1%) m V/V
Combined Error:	±0.02% F.S
Creep Error (30min) :	±0.02% F.S
Zero Balance:	±1% F.S
Temp. Effect On Zero:	±0.02% F.S/10°C
Temp. Effect On Span:	±0.02% F.S/10°C
Input Resistance:	385±5Ω
Output Resistance:	352±2Ω
Insulation Resistance:	≥5000MΩ
Operating Temp. Range:	-30~+70°C
Maximum Safe Over Load:	150%F.S
Ultimate Over Load:	300%F.S
Recommend Excitation:	10~12V DC
Maximum Excitation:	15V DC
Sealing Class:	IP67/IP68
Element Material:	Alloy Steel, Stainless Steel
Cable:	Length=L:3m(0.025t~3t) ; 5m(5~30t)
Citation:	GB/T7551-2008/ OIML R60
Mode Of Connection:	Red(Input+),Black(Input-),Green(Output+),White(Output-)