

Data Sheet

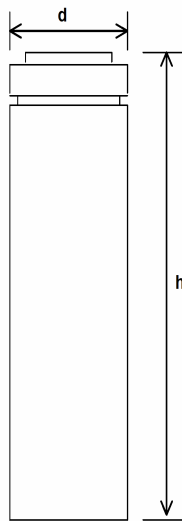

Type Designation	LIC 18650-26 FC
Type Number	56627
System	Li-Ion
UL Recognition	UL1642
Nominal Voltage	3.7V
Nominal Capacity, C	2600mAh (at 0.2C and 20 °C)
Minimum Capacity	2550mAh
Dimensions	
Diameter (d)	18.4mm Max.
Height (h)	65.0mm Max.
Weight, approx.	47.0g
Charging Method	Constant Current + Constant Voltage
Charge Voltage	4.20V (+/- 50 mV)
Initial Charge Current	Standard Charge: 1300mA Rapid Charge: 2600mA
Charging Cut-Off (a) or b))	
a) by time	Standard Charge: 3h Rapid Charge: 2.5h
b) by min. current	0.05C
Discharge Cut-Off voltage	2.75V
Max. Continuous Discharge Current	5200mA
Operating Temperature	Charge: 0 °C to 45 °C Discharge: -20 °C to 60 °C
Storage Temperature	1 Year at -20 °C to 25 °C >80%
Capacity Recovery Rate ²⁾	3 Month at -20 °C to 45 °C >80%
	1 Month at -20 °C to 60 °C >80%
Impedance Initial	<100mΩ @ 1kHz
Life Expectancy ³⁾	300 Cycles for ≥1785mAh

- 1) Prior to use read Handling Precaution and Prohibitions for VARTA Li-ion Batteries.
- 2) After storage at initial cell voltage of 3.6 to 3.9 V/cell; capacity 0.2C measured at 20 °C.
- 3) Cell is to be charged at 0.5C to 4.2V with cutoff at 0.05C and discharged at 0.5C with cutoff at 2.75V, at 20 °C