

1 Digit 7.6 mm (.3") Series

Conventional Part No. Global Part No. Lighting Color
 LN513RA LNM213AA01 Red
 LN513RK LNM213KA01 Red
 LN513GA LNM313AA01 Green
 LN513GK LNM313KA01 Green

Terminal Connection

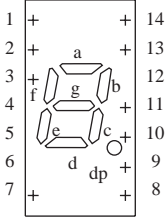

| Pin No. | Assignment | Assignment |
|---------|--------------|----------------|
| 1 | Cathode a | Anode a |
| 2 | Cathode f | Anode f |
| 3 | Common Anode | Common Cathode |
| 4 | _____ | _____ |
| 5 | _____ | _____ |
| 6 | _____ | _____ |
| 7 | Cathode e | Anode e |
| 8 | Cathode d | Anode d |
| 9 | Cathode dp | Anode dp |
| 10 | Cathode c | Anode c |
| 11 | Cathode g | Anode g |
| 12 | _____ | _____ |
| 13 | Cathode b | Anode b |
| 14 | Common Anode | Common Cathode |

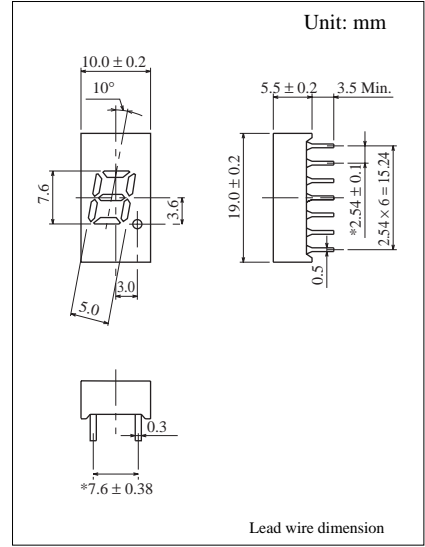

■ Absolute Maximum Ratings ($T_a = 25^\circ\text{C}$)

| Lighting Color | P_D (mW) | I_F (mA) | I_{FP} (mA)* | V_R (V) | T_{opr} ($^\circ\text{C}$) | T_{stg} ($^\circ\text{C}$) |
|----------------|------------|------------|----------------|-----------|--------------------------------|--------------------------------|
| Red | 60 | 20 | 100 | 5 | -25 ~ +80 | -30 ~ +85 |
| Green | 60 | 20 | 100 | 5 | -25 ~ +80 | -30 ~ +85 |

I_{FP} の条件は、duty 10%、Pulse width 1 msec. The condition of I_{FP} is duty 10%, Pulse width 1 msec

■ Electro-Optical Characteristics ($T_a = 25^\circ\text{C}$)

| Conventional Part No. | Lighting Color | Common | I_O / seg | | I_O / d.p | I_F | V_F | | λ_P | $\Delta\lambda$ | I_F | I_R | |
|-----------------------|----------------|---------|----------------|----------------|----------------|-------|-------|-----|-------------|-----------------|-------|---------------|-----|
| | | | Typ | Min | | | Typ | Typ | | | | Max | Max |
| LN513RA | Red | Anode | 400 | 150 | 150 | 5 | 2.2 | 2.8 | 700 | 100 | 20 | 10 | 5 |
| LN513RK | Red | Cathode | 400 | 150 | 150 | 5 | 2.2 | 2.8 | 700 | 100 | 20 | 10 | 5 |
| LN513GA | Green | Anode | 1200 | 400 | 400 | 10 | 2.2 | 2.8 | 565 | 30 | 20 | 10 | 5 |
| LN513GK | Green | Cathode | 1200 | 400 | 400 | 10 | 2.2 | 2.8 | 565 | 30 | 20 | 10 | 5 |
| Unit | — | — | μcd | μcd | μcd | mA | V | V | nm | nm | mA | μA | V |

