

**PLC Transformer**

- RoHS Compliant
- Operating Temperature -40°C to +85°C
- For Qualcomm Atheros' QCA6410 HomePlug® Chipset
- Frequency Range 2MHz to 30MHz

Electrical Specifications @25°C	
Inductance	PIN 2-4= 1.4uH ref.@ 2MHz/100mV
	PIN 1-5= 23uH ref.@ 2MHz/100mV
	PIN 6-10= 11.7uH ref.@ 2MHz/100mV
Leakage Inductance	PIN 2-4= 15nH ref. @ 2MHz/100mV (PIN 6-10 Short)
D.C.R.	PIN 2-4 = 5.0mohm ref.
	PIN 1-5 = 50.0mohm ref.
	PIN 6-10 = 40.0mohm ref.
Turn Ratio	PIN 1-5 : PIN2-4 = 4±2% :1
	PIN 6-10 : PIN2-4 = 3±2% :1
Hi-POT	PRI. – SEC. =3000VAC/60Hz/1Second/1mA

**Dimensions** (Units: mm)

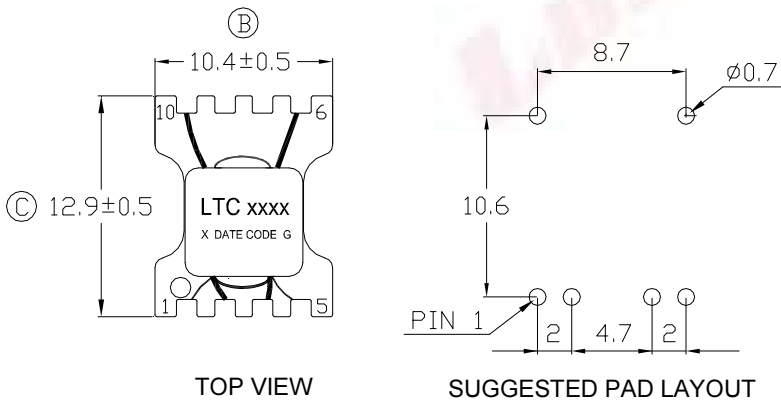

**Schematic**

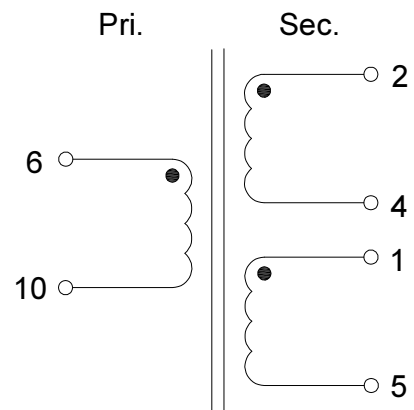

**Mark**

- 1.LTC\*\*\*\*----LTC0318
2. X----PRODUCT LINE OR BLANK
3. DATE CODE----YYWW
4. G----RoHS

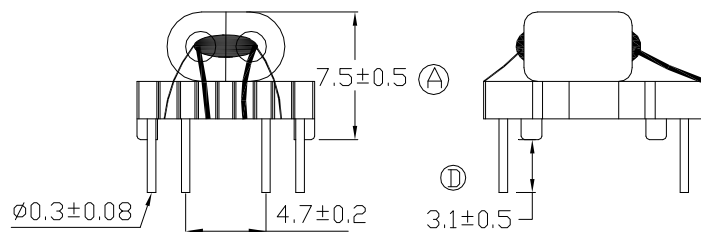

**Package info**

LTC0318-50P-- Tray