

**HomePlug Transformer**

- RoHS Compliant
- Operating Temperature -40°C to +85°C
- 2MHz to 30MHz bandwidth

**Electrical Specifications @25°C**

Inductance	PIN 8-5 = 10uH Min. @ 2MHz/0.1V/Series
	PIN 1-4 = 10uH Min. @ 2MHz/0.1V/Series
Leakage Inductance	PN 8-5 = 70 nH Max. @ 2MHz/0.1V (PIN 1-4 shorted)
D.C.R.	PIN 8-5 = 80mohm Max.
	PIN 1-4 = 80mohm Max
Turn Ratio	PIN 8-5 : PIN 1-4 = 1±2% : 1 @50kHz/0.1V
Hi-POT	Pri.-Sec. = 500VAC/1Seconds/1mA

**Dimensions**

(Units:  $\frac{\text{Inches}}{\text{mm}}$  , Unless otherwise specified, all tolerances are  $\pm\frac{.010}{0.25}$  )

**Schematic**

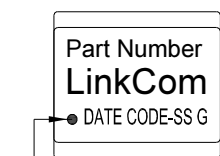

TOP VIEW

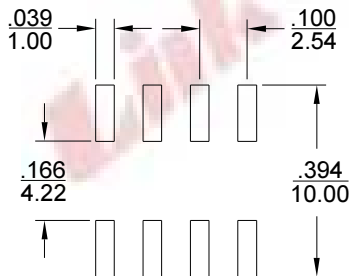

SUGGESTED PAD LAYOUT

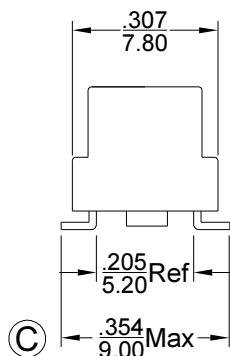
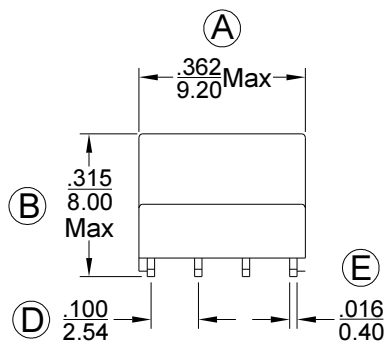
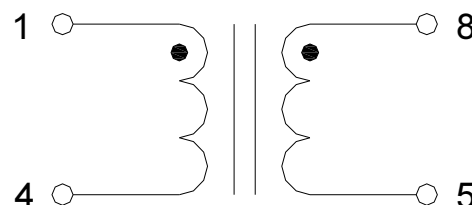

**Mark**

1. Part Number----LTC0389
2. X----PRODUCT LINE or BLANK
3. DATE CODE----YYWW
4. SS----50 or BLANK
5. G----RoHS

**Package info**

LTC0389-50R—Tape Reel