

LTM455_W & LTM450_W Series Ceramic Filter

LTM455_W and LTM450_W series ceramic filters are widely used in telecommunication, cable, radar, TV set, tape recorder, video camera and other electronic products due to its lower price and stable performances.

LTM455_W
LTM450_W

Specifications:

Frequency Range (fc):

LTM455_W Series: 455KHz

LTM450_W Series: 450KHz

Operating Temperature: -20°C ~ +80°C Standard

Storage Temperature: -40°C ~ +85°C

6dB Bandwidth and Attenuation Bandwidth:

B:	± 15KHz	± 30KHz
C:	± 12.5KHz	± 24KHz
D:	± 10KHz	± 20KHz
E:	± 7.5KHz	± 15KHz
F:	± 6KHz	± 12.5KHz
G:	± 4.5KHz	± 10 KHz
H:	± 3KHz	± 9KHz
I:	± 2KHz	± 7.5KHz

Attenuation Specified: 50dB min

Stop Band Attenuation: 40dB min (at fc ± 100KHz)

Insertion Loss: 4.0dB max (B,C,D)
6.0dB max (E,F,G,H,I)

Input/Output Impedance: 1.5KΩ (B,C,D,E)
2.0KΩ (F,G,H,I)

LTM_W Series

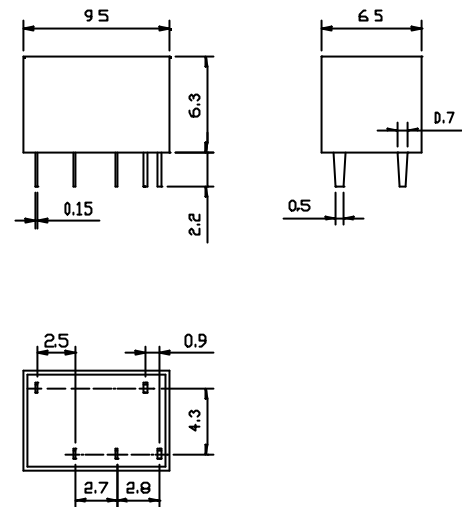

All dimensions are in mm

Note:

1. Other frequencies, bandwidth ranges available. Consult VTC Support for specific requirements.
2. Not all combinations of the above bandwidth ranges are available. Consult VTC Support if your requirement is not standard.
3. All specifications subject to change without notice.

Ordering Information

Product name + Frequency + Bandwidth Code.

i.e. LTM455BW