

# M10SP-2N

## FEATURES

1. Compact size, lightweight and high-output torque.
2. Superior running quietness.

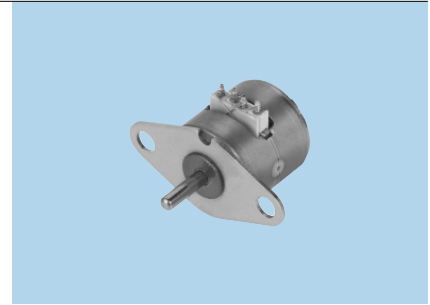

## USES

Scanners, mini-printers, multifunction machines.

## SPECIFICATIONS

Item	M10SP-2N
Rated Voltage	DC 5V
Working Voltage	DC 4~6V
Rated Current/Phase	0.125mA(Peak)
Coil DC Resistance	10Ω/phase±10%
Step Angle	18° /step
Drive Method	Constant Current
Excitation Method	2-2 Phase excitation(Bipolar driving)
Insulation Class	Class E insulation
Pull-out Torque	0.71mN·m/400pps
Pull-in Torque	0.68mN·m/400pps
Max. Pull-out Pulse Rate	4,100pps
Max. Pull-in Pulse Rate	880pps

## CHARACTERISTICS

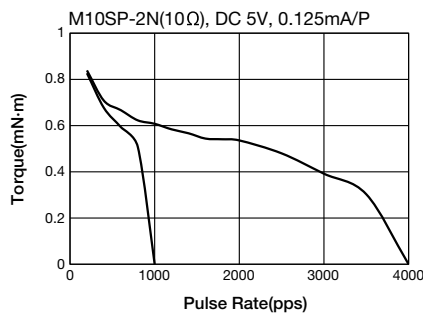

## DIMENSIONS

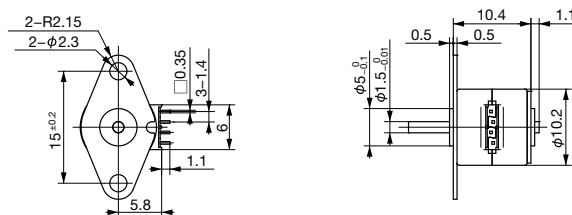

Unit : mm  
General tolerance : ±0.5