

DC Mini-Motors M28N-1 Series

DC Mini-Motors

Applications

1. Printer
2. Power assistance

SPECIFICATIONS

Items	SPEC-NO	R-147381
Rated Voltage (V)		24.2
Voltage Range (V)		3.0~30.0
Rated Load (mN·m)		9.8
No Load Speed (rpm)		7200
No Load Current (mA)		70
Starting Torque (mN·m)		51
Rotation		CW/CCW

*Encoders available as options.



CHARACTERISTICS

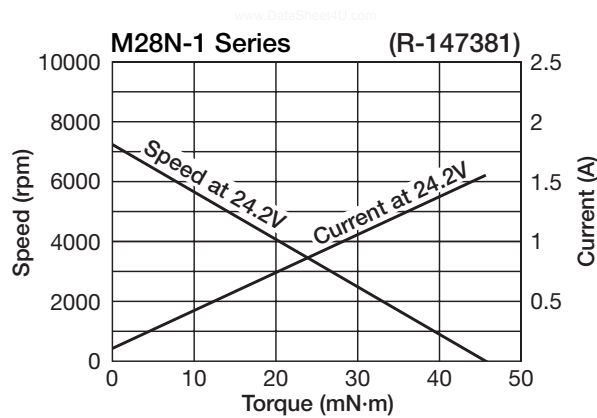

DIMENSIONS

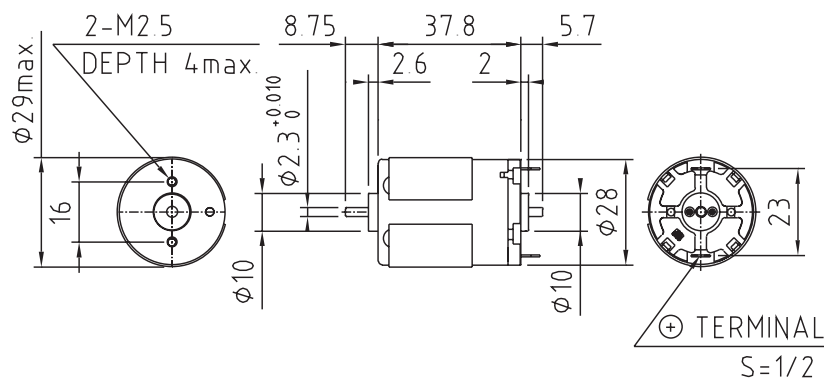

Unit : mm