

## Schottky Barrier Rectifiers

Using the Schottky Barrier principle with a Refractory metal capable of high temperature operation metal. The proprietary barrier technology allows for reliable operation up to 175 °C junction temperature. Typical application are in switching Mode Power Supplies such as adaptors, DC/DC converters, free-wheeling and polarity protection diodes.

### Features

- \* Low Forward Voltage.
- \* Low Switching noise.
- \* High Current Capacity
- \* Guarantee Reverse Avalanche.
- \* Guard-Ring for Stress Protection.
- \* Low Power Loss & High efficiency.
- \* 175 °C Operating Junction Temperature
- \* Low Stored Charge Majority Carrier Conduction.
- \* Plastic Material used Carries Underwriters Laboratory Flammability Classification 94V-O
- \* ESD: 4KV(Min.) Human-Body Model



\* In compliance with EU RoHS 2002/95/EC directives

### MAXIMUM RATINGS

Characteristic	Symbol	MBRA10100	Unit
Peak Repetitive Reverse Voltage Working Peak Reverse Voltage DC Blocking Voltage	$V_{RRM}$ $V_{RWM}$ $V_R$	100	V
RMS Reverse Voltage	$V_{R(RMS)}$	70	V
Average Rectifier Forward Current Total Device (Rated $V_R$ ), $T_C=125$	$I_{F(AV)}$	10	A
Peak Repetitive Forward Current (Rate $V_R$ , Square Wave, 20kHz)	$I_{FM}$	20	A
Non-Repetitive Peak Surge Current (Surge applied at rate load conditions halfwave, single phase, 60Hz)	$I_{FSM}$	150	A
Operating and Storage Junction Temperature Range	$T_J, T_{stg}$	-65 to +175	

### THERMAL RESISTANCES

Typical Thermal Resistance junction to case	$R_{\theta jc}$	3.4	/w
---	-----------------	-----	----

### ELECTRIAL CHARACTERISTICS

Characteristic	Symbol	MBRA10100	Unit
Maximum Instantaneous Forward Voltage ( $I_F=10$ Amp $T_C=25$ ) ( $I_F=10$ Amp $T_C=125$ )	$V_F$	0.85 0.76	V
Maximum Instantaneous Reverse Current ( Rated DC Voltage, $T_C=25$ ) ( Rated DC Voltage, $T_C=125$ )	$I_R$	0.01 10	mA

### SCHOTTKY BARRIER RECTIFIERS

**10 AMPERES  
100 VOLTS**

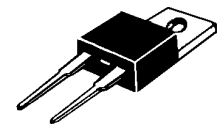

TO-220A

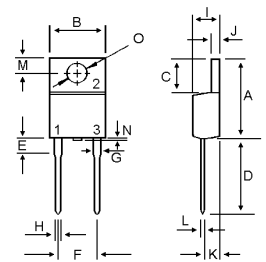

DIM	MILLIMETERS	
	MIN	MAX
A	14.68	15.32
B	9.78	10.42
C	6.02	6.52
D	13.06	14.62
E	3.57	4.07
F	4.84	5.32
G	1.12	1.36
H	0.72	0.96
I	4.22	4.98
J	1.14	1.38
K	2.20	2.98
L	0.33	0.55
M	2.48	2.98
N	----	1.00
O	3.70	3.90

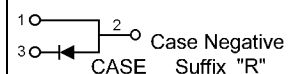
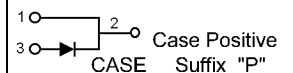

# MBRA10100

FIG-1 FORWARD CURRENT DERATING CURVE

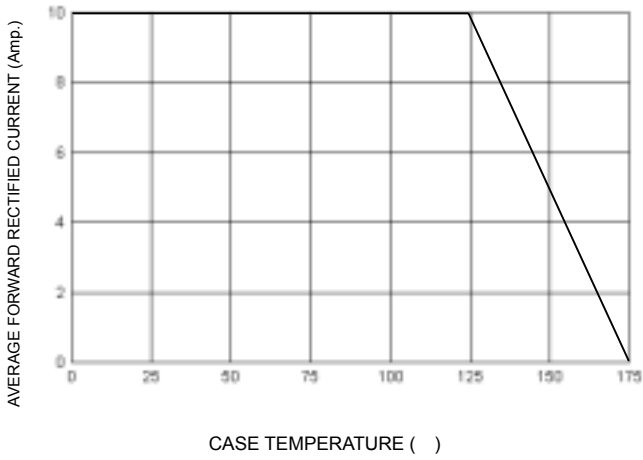

FIG-2 TYPICAL FORWARD CHARACTERISTICS

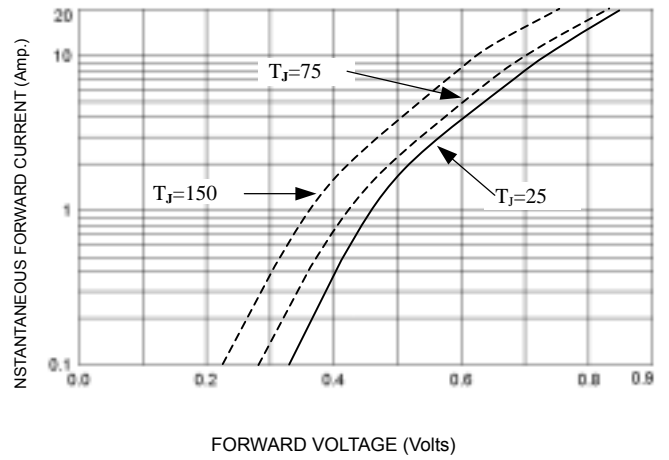

FIG-3 TYPICAL REVERSE CHARACTERISTICS

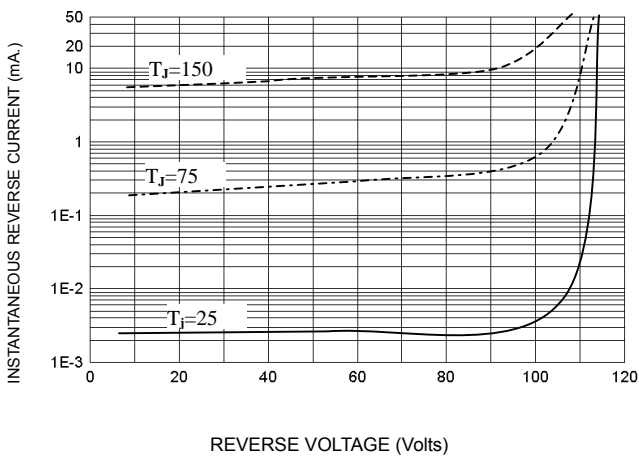

FIG-4 TYPICAL JUNCTION CAPACITANCE

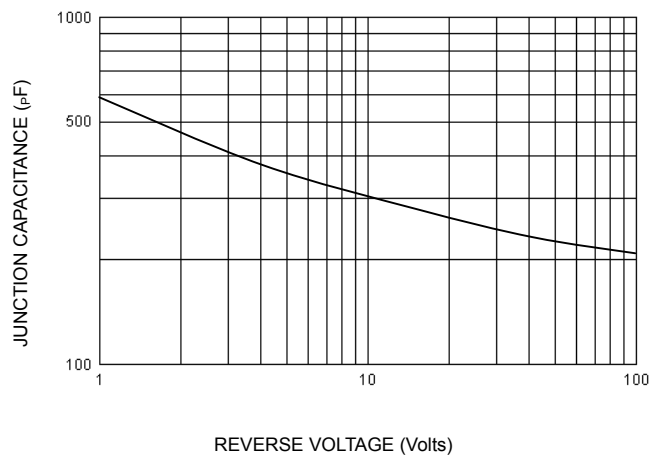

FIG-5 PEAK FORWARD SURGE CURRENT

