



## ITO - 220AC

### Features

- ✧ Plastic material used carries Underwriters Laboratory Classifications 94V-0
- ✧ Metal silicon junction, majority carrier conduction
- ✧ Low power loss, high efficiency
- ✧ High current capability, low forward voltage drop
- ✧ High surge capability
- ✧ For use in low voltage, high frequency inverters, free wheeling, and polarity protection applications
- ✧ Guardring for overvoltage protection
- ✧ High temperature soldering guaranteed: 260°C/10 seconds, 0.25"(6.35mm) from case

### Mechanical Data

- ✧ Cases: JEDEC TO-220AC molded plastic body
- ✧ Terminals: Pure tin plated, lead free. solderable per MIL-STD-750, Method 2026
- ✧ Polarity: As marked
- ✧ Mounting position: Any
- ✧ Mounting torque: 5 in. - lbs. max
- ✧ Weight: 0.08 ounce, 2.24 grams

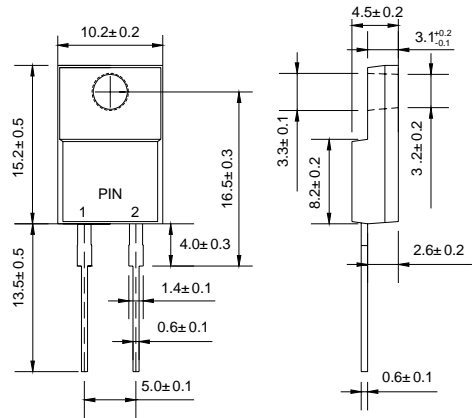

Dimensions in millimeters

### Maximum Ratings and Electrical Characteristics

Rating at 25 °C ambient temperature unless otherwise specified.  
Single phase, half wave, 60 Hz, resistive or inductive load.  
For capacitive load, derate current by 20%

Type Number	Symbol	MBRF 1035	MBRF 1045	MBRF 1050	MBRF 1060	MBRF 1090	MBRF 10100	MBRF 10150	Units
Maximum Recurrent Peak Reverse Voltage	$V_{RRM}$	35	45	50	60	90	100	150	V
Maximum RMS Voltage	$V_{RMS}$	24	31	35	42	63	70	105	V
Maximum DC Blocking Voltage	$V_{DC}$	35	45	50	60	90	100	150	V
Maximum Average Forward Rectified Current at $T_c=125^\circ\text{C}$	$I_{(AV)}$	10							A
Peak Repetitive Forward Current (Rated $V_R$ , Square Wave, 20KHz) at $T_c=125^\circ\text{C}$	$I_{FRM}$	32							A
Peak Forward Surge Current, 8.3 ms Single Half Sine-wave Superimposed on Rated Load (JEDEC method)	$I_{FSM}$	150							A
Peak Repetitive Reverse Surge Current (Note 1)	$I_{RRM}$	1.0			0.5				A
Maximum Instantaneous Forward Voltage at: (Note 2) $I_F=10\text{A}, T_c=25^\circ\text{C}$ $I_F=10\text{A}, T_c=125^\circ\text{C}$ $I_F=20\text{A}, T_c=25^\circ\text{C}$ $I_F=20\text{A}, T_c=125^\circ\text{C}$	$V_F$	0.70		0.80		0.85	1.05		V
		0.57		0.70		0.71	—	—	
		0.84		0.95		—	—	—	
		0.72		0.85		—	—	—	
Maximum Instantaneous Reverse Current @ $T_c=25^\circ\text{C}$ at Rated DC Blocking Voltage @ $T_c=125^\circ\text{C}$ (Note 2)	$I_R$	0.1			0.1				mA
		15		10	6.0				mA
Voltage Rate of Change (Rated $V_R$ )	$dV/dt$	10,000							V/ $\mu\text{S}$
Typical Junction Capacitance	$C_j$	500							pF
Maximum Typical Thermal Resistance(Note 3)	$R_{\theta JC}$	3.0							$^\circ\text{C}/\text{W}$
Operating Junction Temperature Range	$T_J$	-65 to +150							$^\circ\text{C}$
Storage Temperature Range	$T_{STG}$	-65 to +175							$^\circ\text{C}$

- Notes:
1. 2.0us Pulse Width,  $f=1.0\text{ KHz}$
  2. Pulse Test: 300us Pulse Width, 1% Duty Cycle
  3. Thermal Resistance from Junction to Case Per Leg with Heatsink Size of 2 in x 3 in x 0.25 in Al-Plate.

FIG.1- FORWARD CURRENT DERATING CURVE

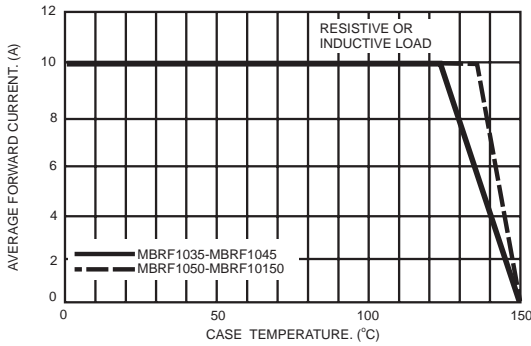

FIG.2- MAXIMUM NON-REPETITIVE FORWARD SURGE CURRENT

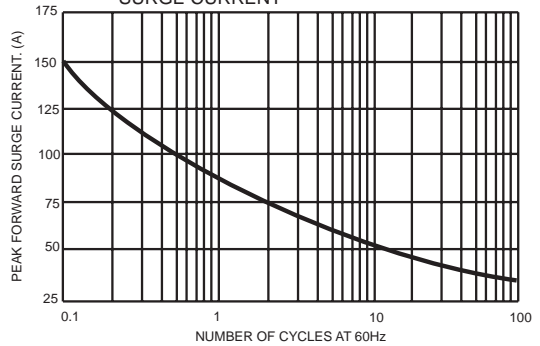

FIG.3- TYPICAL INSTANTANEOUS FORWARD CHARACTERISTICS

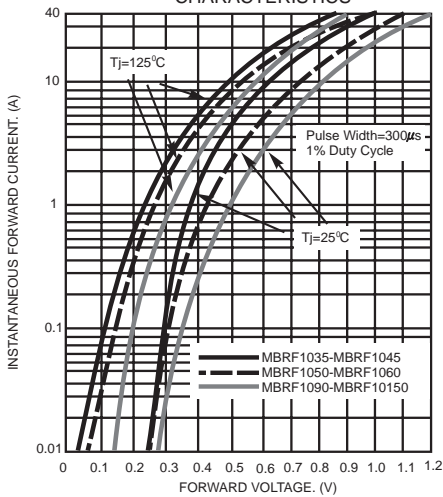

FIG.4- TYPICAL REVERSE CHARACTERISTICS

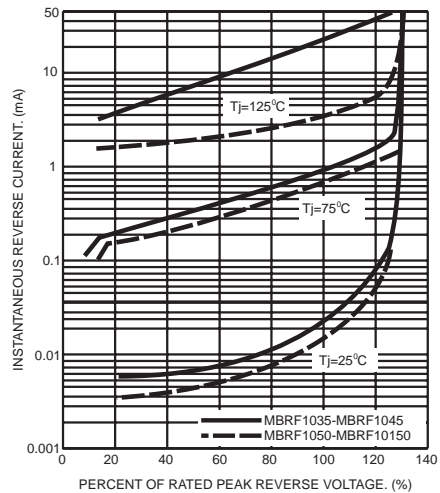

FIG.5- TYPICAL JUNCTION CAPACITANCE

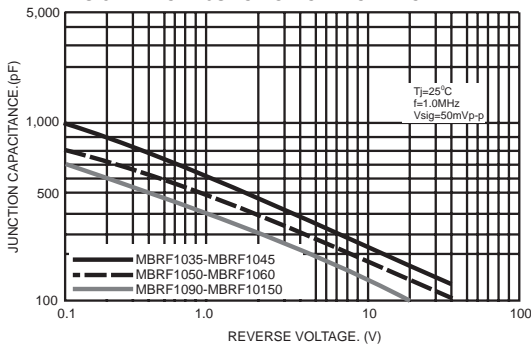

FIG.6- TYPICAL TRANSIENT THERMAL CHARACTERISTICS

