

< C band internally matched power GaAs FET >

MGFC47A4450

4.4 – 5.0 GHz BAND / 50W

DESCRIPTION

The MGFC47A4450 is an internally impedance-matched GaAs power FET especially designed for use in 4.4 – 5.0 GHz band amplifiers. The hermetically sealed metal-ceramic package guarantees high reliability.

FEATURES

- Class AB operation
- Internally matched to 50(ohm) system
- High output power
P1dB=50W (TYP.) @f=4.4 – 5.0GHz
- High power gain
GLP=10.5dB (TYP.) @f=4.4 – 5.0GHz
- High power added efficiency
PAE=40% (TYP.) @f=4.4 – 5.0GHz

APPLICATION

- Radio Link

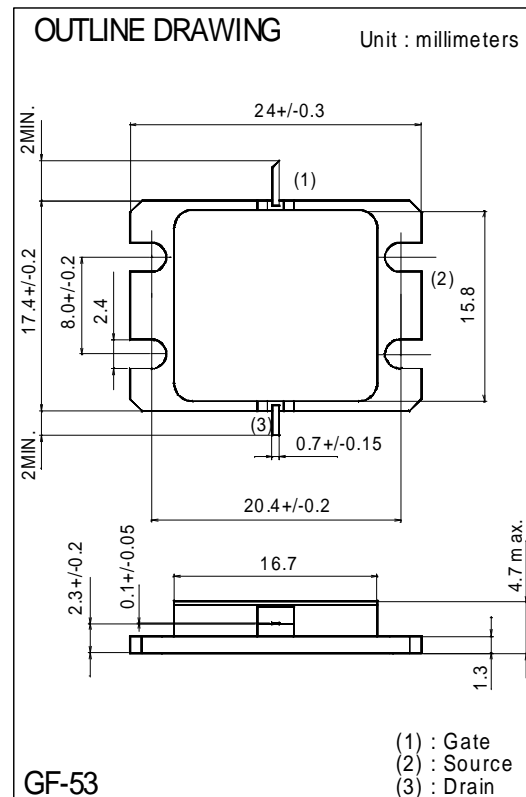

RECOMMENDED BIAS CONDITIONS

- VDS=10V • ID=9.8A • RG=10ohm

Absolute maximum ratings (Ta=25°C)

Symbol	Parameter	Ratings	Unit
VGDO	Gate to drain breakdown voltage	-20	V
VGSO	Gate to source breakdown voltage	-10	V
IGR	Reverse gate current	-130	mA
IGF	Forward gate current	168	mA
PT *1	Total power dissipation	166	W
Tch	Channel temperature	175	°C
Tstg	Storage temperature	-65 to +175	°C

*1 : Tc=25°C

Keep Safety first in your circuit designs!

Mitsubishi Electric Corporation puts the maximum effort into making semiconductor products better and more reliable, but there is always the possibility that trouble may occur with them. Trouble with semiconductors may lead to personal injury, fire or property damage. Remember to give due consideration to safety when making your circuit designs, with appropriate measure such as (i) placement of substitutive, auxiliary circuits, (ii) use of non-flammable material or (iii) prevention against any malfunction or mishap.

Electrical characteristics (Ta=25°C)

Symbol	Parameter	Test conditions	Limits			Unit
			Min.	Typ.	Max.	
VGS(off)	Gate to source cut-off voltage	VDS=3V, ID=168mA	-1	-	-4	V
P1dB	Output power at 1dB gain compression	VDS=10V, ID(RF off)=9.8A	46	47	-	dBm
GLP	Linear Power Gain	f=4.4 – 5.0GHz	9.5	10.5	-	dB
ID	Drain current		-	11	-	A
PAE	Power added efficiency		-	40	-	%
Rth(ch-c) *2	Thermal resistance	delta Vf method	-	0.8	0.9	°C/W

*2 : Channel-case

MGFC47A4450 TYPICAL CHARACTERISTICS

GLP vs. f

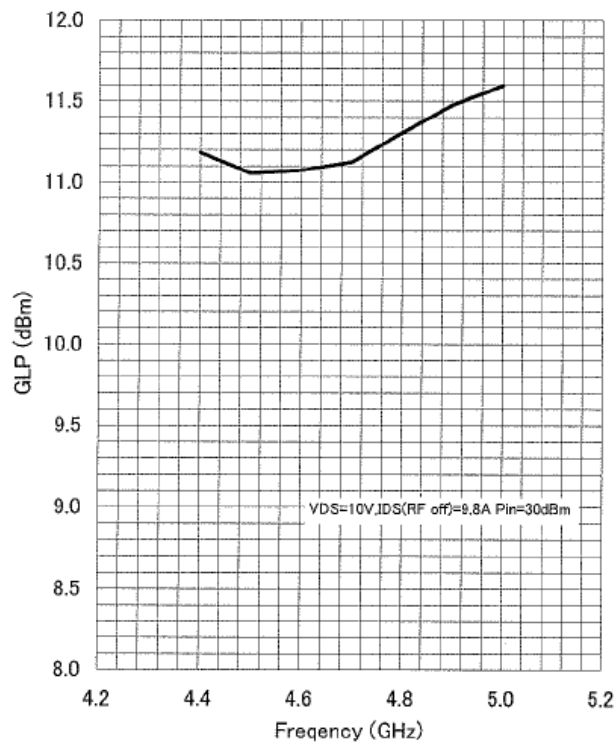

P1dB vs. f

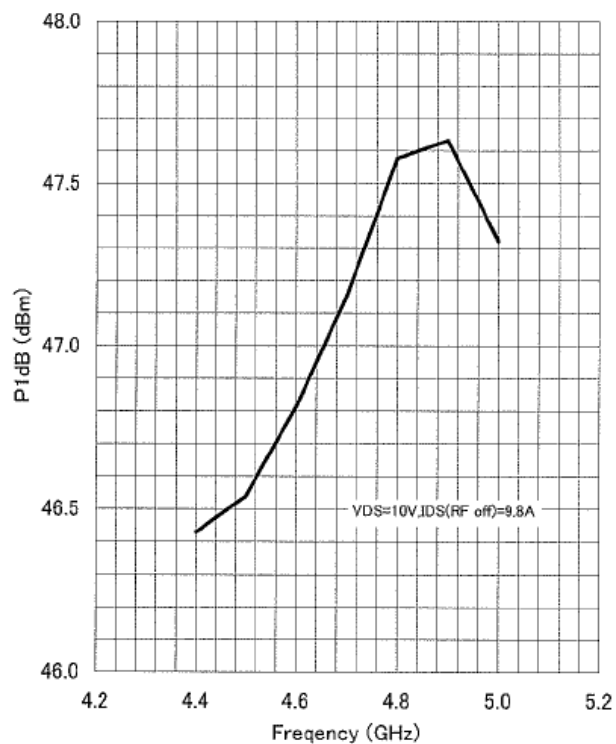

Pout , PAE vs. Pin

f = 4.4GHz

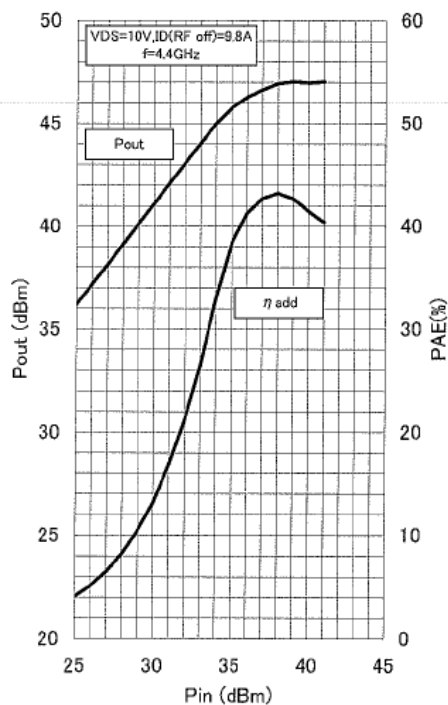

f = 4.7GHz

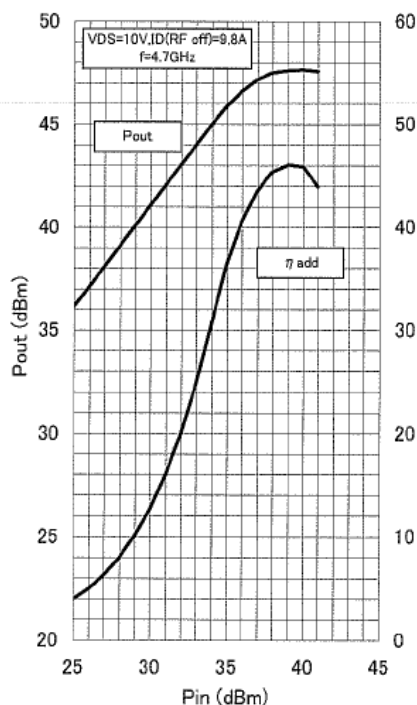

f = 5.0GHz

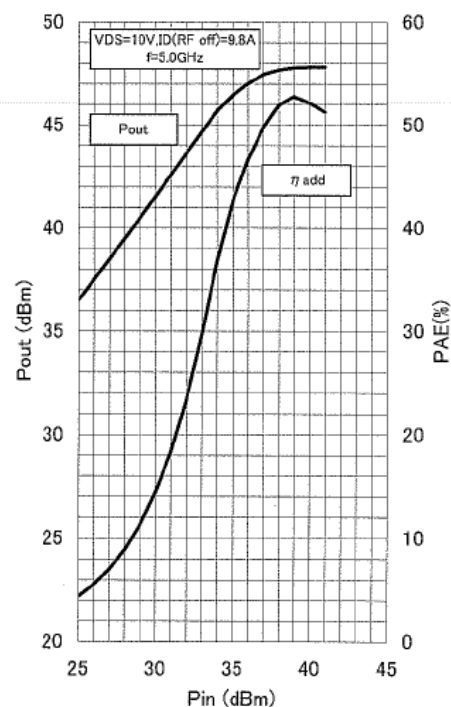

< C band internally matched power GaAs FET >

MGFC47A4450

4.4 – 5.0 GHz BAND / 50W

MGFC47A4450 S-parameters(Ta=25deg.C , VDS=10(V),IDS=8(A))

f (GHz)	S Parameters(TYP.)							
	S11		S21		S12		S22	
	MAG.	ANG(deg.)	[MAG]	[ANG]	[MAG]	[ANG]	[MAG]	[ANG]
4.20	0.776	24.3	2.862	177.9	0.034	126.1	0.269	57.6
4.25	0.745	14.8	3.067	168.4	0.039	113.5	0.234	47.0
4.30	0.707	3.9	3.276	158.5	0.044	102.5	0.199	36.2
4.35	0.663	-7.9	3.475	148.0	0.049	90.3	0.166	21.3
4.40	0.615	-21.0	3.654	137.2	0.055	78.5	0.130	3.7
4.45	0.567	-35.2	3.836	126.1	0.060	66.1	0.103	-20.4
4.50	0.513	-51.0	3.971	114.6	0.065	54.5	0.086	-49.2
4.55	0.465	-68.2	4.092	102.9	0.070	42.4	0.080	-83.3
4.60	0.421	-87.1	4.162	91.1	0.074	30.3	0.086	-114.7
4.65	0.381	-107.9	4.190	79.1	0.077	18.1	0.099	-143.6
4.70	0.354	-130.1	4.178	67.2	0.081	6.9	0.117	-166.6
4.75	0.334	-153.4	4.126	55.5	0.082	-4.8	0.136	172.9
4.80	0.327	-176.8	4.033	43.7	0.084	-15.6	0.156	155.5
4.85	0.331	160.4	3.921	32.5	0.085	-26.5	0.178	138.1
4.90	0.341	139.1	3.784	21.4	0.086	-37.4	0.204	122.1
4.95	0.360	120.3	3.643	10.7	0.086	-48.3	0.231	107.3
5.00	0.394	103.0	3.514	0.2	0.086	-58.6	0.262	93.9
5.05	0.436	86.8	3.366	-10.6	0.085	-68.9	0.295	80.8
5.10	0.482	71.3	3.204	-21.4	0.083	-79.5	0.333	68.9
5.15	0.526	56.9	3.026	-32.0	0.080	-89.8	0.369	57.6
5.20	0.571	43.7	2.844	-42.4	0.078	-99.9	0.412	47.2

This S-Parameter data show measurements performed on each single-ended FET

Keep safety first in your circuit designs!

Mitsubishi Electric Corporation puts the maximum effort into making semiconductor products better and more reliable, but there is always the possibility that trouble may occur with them. Trouble with semiconductors may lead to personal injury, fire or property damage. Remember to give due consideration to safety when making your circuit designs, with appropriate measures such as (i) placement of substitutive, auxiliary circuits, (ii) use of non-flammable material or (iii) prevention against any malfunction or mishap.

Notes regarding these materials

- These materials are intended as a reference to assist our customers in the selection of the Mitsubishi semiconductor product best suited to the customer's application; they do not convey any license under any intellectual property rights, or any other rights, belonging to Mitsubishi Electric Corporation or a third party.
- Mitsubishi Electric Corporation assumes no responsibility for any damage, or infringement of any third-party's rights, originating in the use of any product data, diagrams, charts, programs, algorithms, or circuit application examples contained in these materials.
- All information contained in these materials, including product data, diagrams, charts, programs and algorithms represents information on products at the time of publication of these materials, and are subject to change by Mitsubishi Electric Corporation without notice due to product improvements or other reasons. It is therefore recommended that customers contact Mitsubishi Electric Corporation or an authorized Mitsubishi Semiconductor product distributor for the latest product information before purchasing a product listed herein.
The information described here may contain technical inaccuracies or typographical errors. Mitsubishi Electric Corporation assumes no responsibility for any damage, liability, or other loss rising from these inaccuracies or errors.
Please also pay attention to information published by Mitsubishi Electric Corporation by various means, including the Mitsubishi Semiconductor home page (<http://www.MitsubishiElectric.com/>).
- When using any or all of the information contained in these materials, including product data, diagrams, charts, programs, and algorithms, please be sure to evaluate all information as a total system before making a final decision on the applicability of the information and products. Mitsubishi Electric Corporation assumes no responsibility for any damage, liability or other loss resulting from the information contained herein.
- Mitsubishi Electric Corporation semiconductors are not designed or manufactured for use in a device or system that is used under circumstances in which human life is potentially at stake. Please contact Mitsubishi Electric Corporation or an authorized Mitsubishi Semiconductor product distributor when considering the use of a product contained herein for any specific purposes, such as apparatus or systems for transportation, vehicular, medical, aerospace, nuclear, or undersea repeater use.
- The prior written approval of Mitsubishi Electric Corporation is necessary to reprint or reproduce in whole or in part these materials.
- If these products or technologies are subject to the Japanese export control restrictions, they must be exported under a license from the Japanese government and cannot be imported into a country other than the approved destination.
Any diversion or re-export contrary to the export control laws and regulations of Japan and/or the country of destination is prohibited.
- Please contact Mitsubishi Electric Corporation or an authorized Mitsubishi Semiconductor product distributor for further details on these materials or the products contained therein.