

No.M04-446E0
DC JACK FOR P.C.B.
(center pin : 0.65 φ mm)
JSAJ 1 (DC 3.15V Max)

EIAJ RC5320A 電圧区分 1

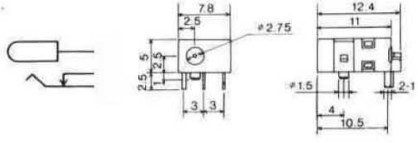

No.M04-700A0
DC JACK FOR P.C.B.
(center hole : 1.05 φ mm)
JSBJ 4 (DC 10.5V ~13.5V)

EIAJ RC5320A 電圧区分 4

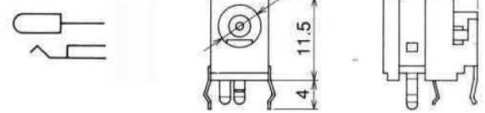

No.M04-477A0

EIAJ RC5320A 電圧区分 1

DC JACK FOR P.C.B. (center pin : 0.65 φ mm)
JSAJ 1 (DC 3.15V Max)

www.datasheet4u.com

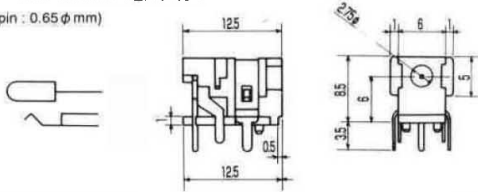

No.M04-390DJ

EIAJ RC5320A 電圧区分 4

DC JACK FOR P.C.B.
(center hole : 1.05 φ mm)
JSBJ 4 (DC 10.5V ~13.5V)

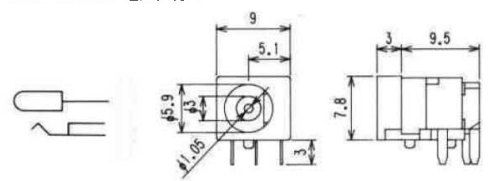

No.M04-595A0
DC JACK FOR P.C.B. (center pin : 0.65 φ mm)
JSAJ 1 (DC 3.15V Max)

EIAJ RC5320A 電圧区分 1

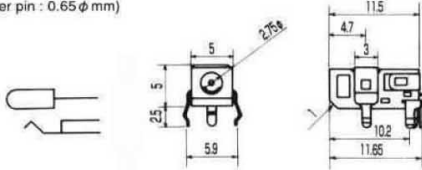

No.M05-532A0
DC JACK FOR P.C.B.
(center hole : 1.45 φ mm)
JSBJ 5 (DC 13.5V ~18V)

EIAJ RC5320A 電圧区分 5

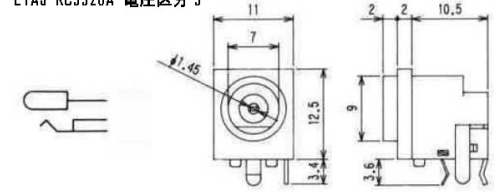

No.M04-339A0

EIAJ RC5320A 電圧区分 2

DC JACK FOR P.C.B. (center pin : 1.65 φ mm I.D. : 4.4 φ mm)
JSAJ 2 (DC 3.15V ~6.3V)

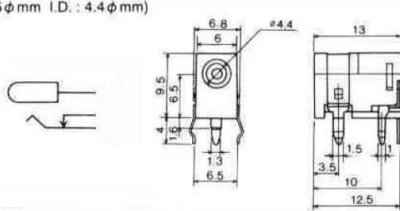

No.M04-730A0
DC JACK FOR P.C.B. (center pin : 1.65 φ mm I.D. : 4.4 φ mm)
JSAJ 2 (DC 3.15V ~6.3V)

EIAJ RC5320A 電圧区分 2

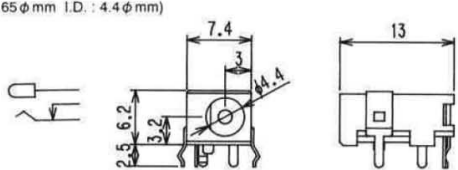

CHASSIS Mtg. DC JACK

No.MJ-10

(center pin : 2 φ mm)

No.MJ-11

(center pin : 2.35 φ mm)

No.MJ-12 EIAJ RC5320A 電圧区分 2
(center pin : 1.65 φ mm I.D. : 4.4 φ mm)
JSAJ 2 (DC 3.15V ~6.3V)

No.MJ-13 EIAJ RC5320A 電圧区分 3
(center pin : 1.65 φ mm I.D. : 5.15 φ mm)
JSAJ 3 (DC 6.3V ~10.5V)

No.MJ-19 EIAJ RC5320A 電圧区分 4
(center hole : 1.05 φ mm)
JSBJ 4 (DC 10.5V ~13.5V)

No.MJ-20 EIAJ RC5320A 電圧区分 5
(center hole : 1.45 φ mm)
JSBJ 5 (DC 13.5V ~18V)



No.M04-260DJ

EIAJ RC5320A 電圧区分 2

DC JACK FOR P.C.B. (center pin : 1.65 φ mm I.D. : 4.4 φ mm)
JSAJ 2 (DC 3.15V ~6.3V)

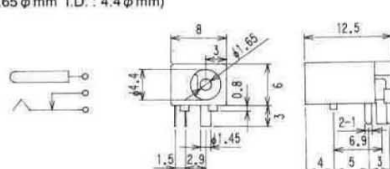

No.M04-440A0
DC JACK FOR P.C.B.
(center pin : 1.65 φ mm I.D. 5.15 φ mm)
JSAJ 3 (DC 6.3V ~10.5V)

EIAJ RC5320A 電圧区分 3

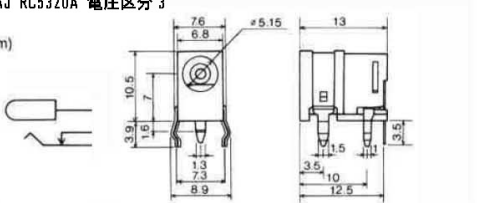

No.M04-533B0

EIAJ RC5320A 電圧区分 3

DC JACK FOR P.C.B.
(center pin : 1.65 φ mm I.D. 5.15 φ mm)
JSAJ 3 (DC 6.3V ~10.5V)

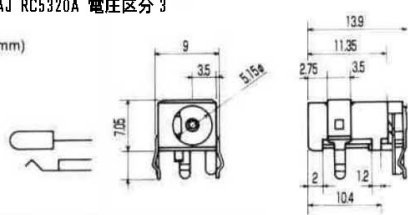

No.M04-754A0
DC JACK FOR P.C.B.
(center pin : 1.65 φ mm I.D. : 5.15 φ mm)
JSAJ 3 (DC 6.3V ~10.5V)

EIAJ RC5320A 電圧区分 3

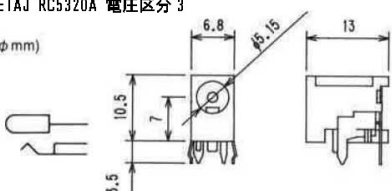

No.MJ-14

(5.5 φ × 2.1 φ mm)

No.MJ-15

(5.5 φ × 2.5 φ mm)

No.MJ-16 EIAJ RC5320A 電圧区分 1
(center pin : 0.65 φ mm)
JSAJ 1 (DC 3.15V Max)

No.MJ-17 EIAJ RC5320A 電圧区分 2
(center pin : 1.65 φ mm
I.D. : 4.4 φ mm)
JSAJ 2 (DC 3.15V ~6.3V)

No.MJ-18 EIAJ RC5320A 電圧区分 3
(center pin : 1.65 φ mm
I.D. : 5.15 φ mm)
JSAJ 3 (DC 6.3V ~10.5V)

No.MJ-99
(center pin : 1.3 φ mm
I.D. : 3.4 φ mm)

No.MJ-99/3.8
(center pin : 1.3 φ mm
I.D. : 3.8 φ mm)



No.MJ-21AM

PANEL MOUNT DC JACK (Center Pin : 2 φ mm)

No.MJ-22AM

PANEL MOUNT DC JACK (Center Pin : 2.35 φ mm)

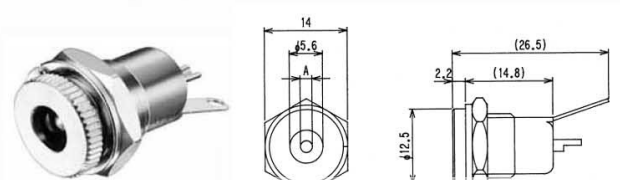

No.MJ-179

PANEL MOUNT DC JACK
(Center Pin : 2.0 mm)
Net Weight : 2 gr.

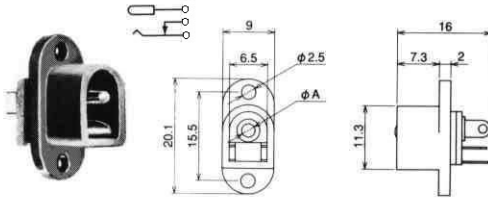
**No.MJ-180**

PANEL MOUNT DC JACK
(Center Pin : 2.35 mm)
Net Weight : 2 gr.

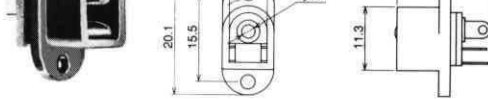
**No.MJ-21**

CHASSIS Mtg.DC JACK
(Center Pin : 2 φ mm)

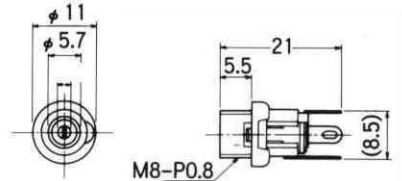
**No.MJ-22**

CHASSIS Mtg.DC JACK
(Center Pin : 2.35 φ mm)

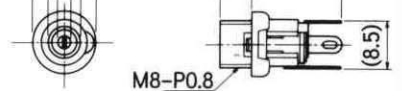
**No.MJ-179P**

DC JACK FOR P.C.
(Center Pin : 2.0 mm)
Net Weight : 1.6 gr.

www.datasheet4u.com

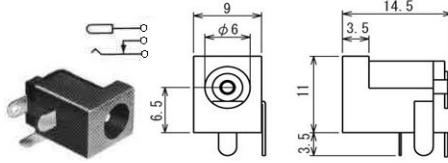
**No.MJ-180P**

DC JACK FOR P.C.
(Center Pin : 2.35 mm)

**No.MJ-181M**

(Center Pin : 2 mm)

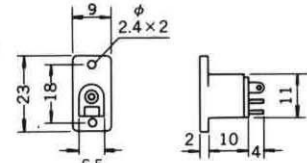
**No.MJ-182M**

(Center Pin : 2.35mm)
Net Weight : 2 gr.

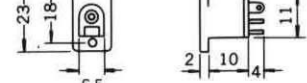
**No.MJ-065M**

DC JACK SCREW TYPE
(Center Pin : 2.95mm)

**No.MJ-196P**

DC JACK INSERT TYPE (Center Pin : 2.0 mm)
FOR P.C.
Net Weight : 1.5 gr.

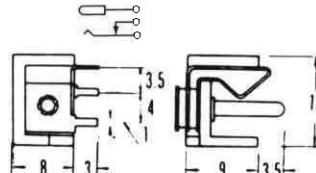
**No.MJ-197P**

DC JACK INSERT TYPE
(Center Pin : 2.35 mm)
FOR P.C.
Net Weight : 1.5 gr.

**No.MJ-181MS**

DC JACK SCREW TYPE
(Center Pin : 2mm)
Net Weight : 3 gr.

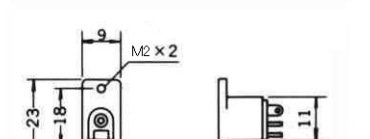
**No.MJ-182MS**

DC JACK SCREW TYPE
(Center Pin : 2.35mm)
Net Weight : 3 gr.

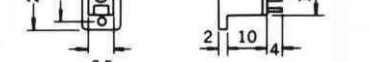
**No.MJ-196**

DC JACK INSERT TYPE
(Center Pin : 2.0 mm)
Net Weight : 2 gr.

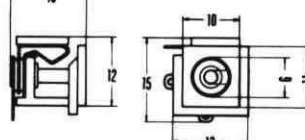
**No.MJ-197**

DC JACK INSERT TYPE
(Center Pin : 2.35 mm)
Net Weight : 2 gr.

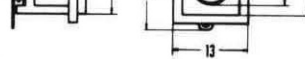
**No.MJ-196E**

DC JACK INSERT TYPE
(Center Pin : 2.0 mm)

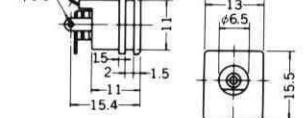
**No.MJ-197E**

DC JACK INSERT TYPE
(Center Pin : 2.35 mm)

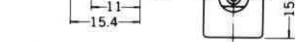
**No.MJ-179LE**

DC JACK
(Center Pin : 2.0 mm)

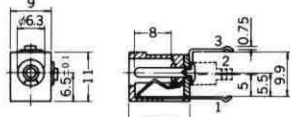
**No.MJ-180LE**

DC JACK
(Center Pin : 2.35 mm)

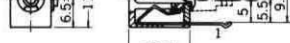
**No.MJD-P6**

(Center Pin : 2.0mm)
Net Weight : 2 gr.

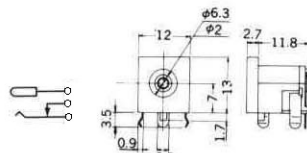
**No.MJ-83**

(Center Pin : 1.3mm)

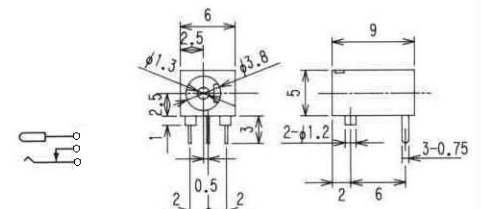
**No.MJ-25N**

Miniature DC JACK(Center Pin : 1 φ mm)

No.MJ-25N1

Miniature DC JACK(Center Pin : 1.3 φ mm)

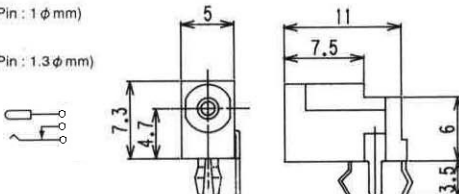
**No.MJ-82-1**

(Center Pin : 1.3mm)
Net Weight : 1.5 gr.

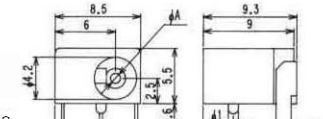
**No.MJ-82-2**

(Center Pin : 1 mm)
Net Weight : 1.5 gr.

**No.MX-408BL**

(Center Pin : 2.0mm)

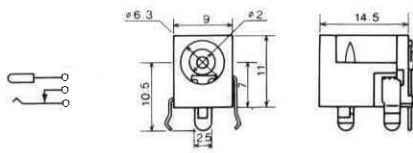

PANEL MOUNT DC JACKS

No.MJ-40

PANEL MOUNT DC JACK (Center Pin : 2 φ mm)

No.MJ-41

PANEL MOUNT DC JACK (Center Pin : 2.35 φ mm)

No.MJ-42

PANEL MOUNT DC JACK (Center Pin : 1.65 φ mm I.D. : 4.4 φ mm)

JSAJ 2 (DC 3.15V~6.3V)

No.MJ-43

PANEL MOUNT DC JACK (Center Pin : 1.65 φ mm I.D. : 5.15 φ mm)

JSAJ 3 (DC 6.3V~10.5V)

No.MJ-44

PANEL MOUNT DC JACK (Center Pin : 1.3 φ mm I.D. : 3.4 φ mm)

No.MJ-45

PANEL MOUNT DC JACK (Center Pin : 1.3 φ mm I.D. : 3.8 φ mm)

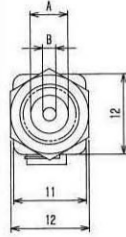
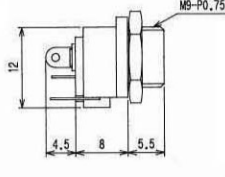

DC INLINE JACK

No.MJ-077N

(5.5 φ × 2.1 φ mm)

No.MJ-078N

(5.5 φ × 2.5 φ mm)

No.MJ-095N

(center pin : 0.65 φ mm)

JSAJ 1 (DC 3.15VMax)

No.MJ-096N

(center pin : 1.65 φ mm

I.D. : 4.4 φ mm)

JSAJ 2 (DC 3.15V~6.3V)

No.MJ-097N

(center pin : 1.65 φ mm

I.D. : 5.15 φ mm)

JSAJ 3 (DC 6.3V~10.5V)

No.MJ-099N

(center pin : 1.3 φ mm

I.D. : 3.4 φ mm)

No.MJ-099N/3.8

(center pin : 1.3 φ mm

I.D. : 3.8 φ mm)

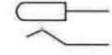
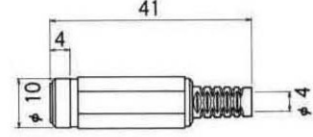

DC PLUG & JACK FOR EIAJ STANDARD No.RC-5322

No.MJ-300J

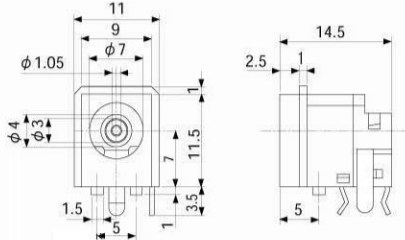

No.MP206

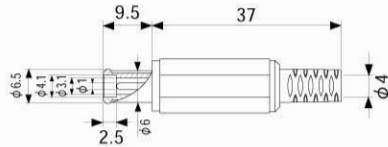

SNAP-IN DC JACKS

No.MJ60 (Center pin: 2 φ mm)

No.MJ61 (Center pin: 2.35 φ mm)

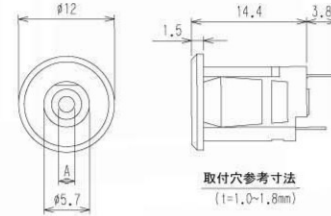

取付穴参考寸法
(1=1, 0~1, 8mm)

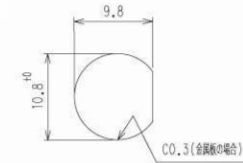

LOCKABLE DC SOCKETS & PLUGS

No.MJ-179LR

LOCKABLE DC SOCKET FOR P.C.B. (Center Pin : 2 φ mm)
TO MATE WITH MP-121CR

No.MJ-180LR

LOCKABLE DC SOCKET FOR P.C.B. (Center Pin : 2.35 φ mm)
TO MATE WITH MP-122CR

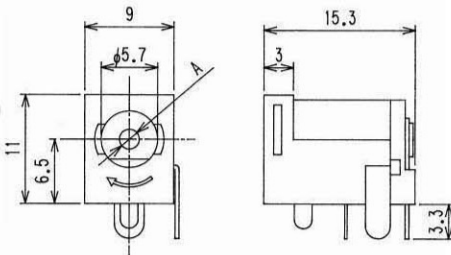
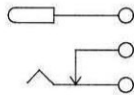

DC-PLUG WITH LOCKING DETENT

No.MP-121AR

TO MATE WITH MJ-179R & MJ-10LR
(DC1.2V 0.5A)

No.MP-122AR

TO MATE WITH MJ-180LR & MJ-11LR
(DC1.2V 1A)

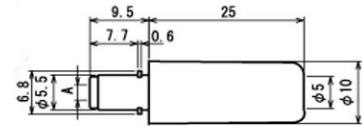

No.MJ10LR

LOCKABLE DC SOCKET FOR PANEL MOUNT (Center pin : 2 φ mm)
TO MATE WITH MP-121CR OR MP121MR

No.MJ11LR

LOCKABLE DC SOCKET FOR PANEL MOUNT (Center pin : 2.35 φ mm)
TO MATE WITH MP-122CR OR MP-122MR

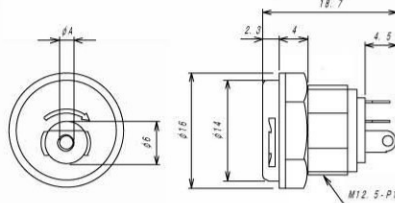

	A
MJ10LR	φ2.0
MJ11LR	φ2.35



No.MP-121MR (5.5 φ mm × 2.1 φ mm)

DC PLUG WITH LOCKING DETENT FOR MOLDING
TO MATE WITH MJ179LR OR MJ10LR

No.MP-122MR (5.5 φ mm × 2.5 φ mm)

DC PLUG WITH LOCKING DETENT FOR MOLDING
TO MATE WITH MJ180LR OR MJ11LR

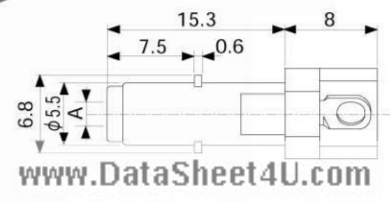

DC EXTENTION CABLE

L=1800mm



www.DataSheet4U.com

Available Product Line

MODEL No.	JACK TYPE (mm)	RATING
MC-2376	$\phi 5.5 \times \phi 2.1$	12.0V DC 0.5A
MC-2377	$\phi 5.5 \times \phi 2.5$	12.0V DC 0.5A
MC-5327	$\phi 4.0 \times \phi 1.7$ JSAJ2	6.3V DC 2A
MC-5328	$\phi 4.75 \times \phi 1.7$ JSAJ3	10.5V DC 2A

DC INLINE JACK FOR MOLDING

No.MJ-23

($5.5 \phi \times 2.1 \phi$ mm)

No.MJ-24

($5.5 \phi \times 2.5 \phi$ mm)

No.MJ-28

(center pin : 1.65ϕ mm I.D. : 4.4ϕ mm)
JSAJ 2 (DC 3.15V~6.3V)

No.MJ-29

(center pin : 1.65ϕ mm I.D. : 5.15ϕ mm)
JSAJ 3 (DC 6.3V~10.5V)

