

**MPC SERIES**

**Low ESR, High Ripple Current, Rectangular Type**

**◆FEATURES**

- For snubber circuit.
- Reliability is excellent because these capacitors provide self-healing.
- High isolation and low loss of polypropylene film used.
- RoHS compliance.



**◆SPECIFICATIONS**

Category Temperature Range	-40°C~+85°C
Rated Voltage	630Vdc, 1200Vdc
Capacitance	0.1μF~2.2μF
Capacitance Tolerance	±5%(J), ±10%(K)
tanδ	0.002Max (1KHz 25°C±5°C)
Voltage Proof	Between the terminals : Rated Voltage x 1.75 10s
	Between the terminal and case : 2000Vdc 10s
Insulation Resistance	10000 Ω·F (20°C 60s 500Vdc)
Case	PBT·PPS Resin
Filling Resin	Epoxy Resin

**◆OUTLINE**

(mm)

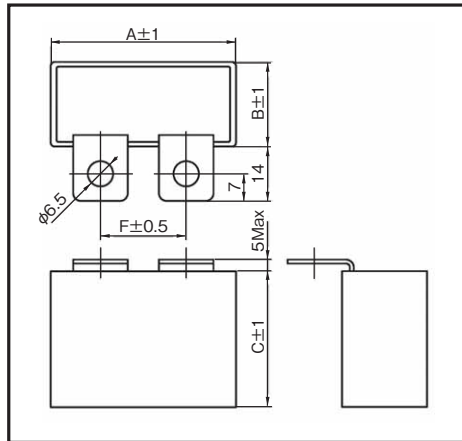

**◆PART NUMBER**

□□□  
Rated Voltage

MPC  
Series

□□□  
Capacitance

□  
Capacitance Tolerance

R99  
Option

L□  
Terminal Code

{ F=22:L2 }  
{ F=28:L8 }

**◆ STANDARD SIZE**

□ : Capacitance Tolerance    \*\* : Terminal Code

Rated Voltage	Cap(μF)	Cap Tolerance(%)	Dimensions (mm)				Permissible Current (Arms/10kHz)	Part No.
			A	B	C	F		
630 Vdc	0.1	J (±5%) K (±10%)	37	19	32.5	22	1.2	630MPC104□R99L2
	0.22		37	24	37	22	3.1	630MPC224□R99L2
	0.47		37	24	37	22	4.8	630MPC474□R99L2
	0.68		37	24	37	22	5.5	630MPC684□R99L2
	1.0		48	22	35	22, 28	5.5	630MPC105□R99L**
	2.2		58	26	40	22, 28	9.1	630MPC225□R99L**
1200 Vdc	0.1	J (±5%) K (±10%)	37	19	32.5	22	1.2	121MPC104□R99L2
	0.22		37	24	37	22	3.1	121MPC224□R99L2
	0.47		48	24	38	22, 28	4.4	121MPC474□R99L**
	0.68		58	26	40	22, 28	4.6	121MPC684□R99L**
	1.0		58	30	44	22, 28	7.0	121MPC105□R99L**

•Different capacitance and rated voltage item is available. For details, please consult our sales offices.