

MS21073 Nutplate Series Specifications

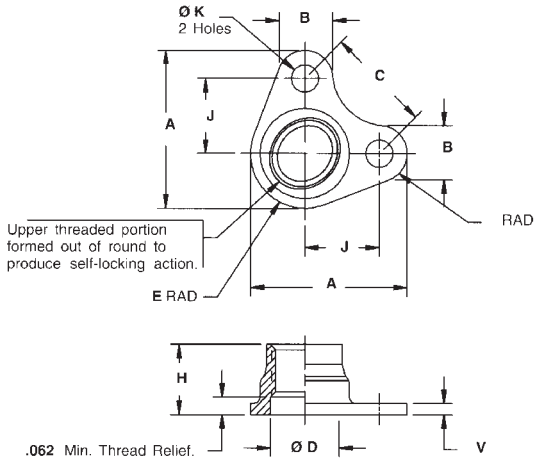

MATERIAL: Carbon steel per AMS 5085 (UNS G10500)

FINISH: Cadmium plate per QQ-P-416, Type II, Class 2 and Kaylube molybdenum disulfide dry film lubricant per MIL-L-460010

PERFORMANCE: MIL-N-25027

| Part Number | Thread MIL-S-8879 | A Max | B Ref | C ±.002 | D Min | E Ref | H Max | J ±.005 | K +.005 -0.000 | V Ref | Approx Weight Lbs/100 |
|-------------|-------------------|-------|-------|---------|-------|-------|-------|---------|----------------|-------|-----------------------|
| MS21073-04 | .1120-32 UNJC-3B | .448 | .220 | .287 | - | .125 | .130 | .203 | .098 | .025 | .09 |
| MS21073-06 | .1280-32 UNJC-3B | .457 | .220 | .308 | - | .125 | .145 | .218 | .098 | .032 | .13 |
| MS21073-08 | .1640-32 UNJC-3B | .497 | .220 | .331 | .168 | .125 | .215 | .234 | .098 | .032 | .17 |
| MS21073-3 | .1900-32 UNJF-3B | .526 | .220 | .354 | .194 | .156 | .220 | .250 | .098 | .032 | .22 |
| MS21073-4 | .2500-28 UNJF-3B | .603 | .220 | .398 | .254 | .203 | .281 | .281 | .098 | .040 | .37 |
| MS21073-5 | .3125-24 UNJF-3B | .757 | .270 | .508 | .317 | .250 | .328 | .359 | .130 | .050 | .63 |

MS21075 Nutplate Series Specifications

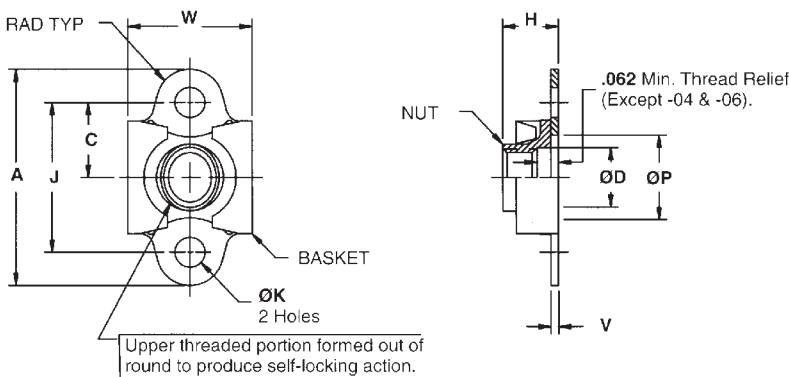

MATERIAL: C1050 carbon steel per AMS 5085 (UNS G10500). Heat Treat -Rc 49, maximum

FINISH: Cadmium plate per QQ-P-416, Type II, Class 2 and Kaylube molybdenum disulfide dry film lubricant per MIL-L-460010

FLOATABILITY: .030 min radially from center

| Part Number | Thread MIL-S-8879 | A Max | C ±.010 | D Min | H Max | J ±.004 | K +.005 -0.000 | P Ref | V Ref | W Max | Approx Weight Lbs/10 |
|-------------|-------------------|-------|---------|-------|-------|---------|----------------|-------|-------|-------|----------------------|
| MS21075-04 | .1120-40 UNJC-3B | .651 | .208 | - | .153 | .408 | .098 | .164 | .020 | .315 | .25 |
| MS21075-06 | .1380-32 UNJC-3B | .682 | .223 | - | .171 | .439 | .098 | .190 | .020 | .357 | .25 |
| MS21075-08 | .1640-32 UNJC-3B | .707 | .239 | .168 | .250 | .470 | .098 | .214 | .025 | .367 | .28 |
| MS21075-3 | .1900-32 UNJF-3B | .739 | .255 | .194 | .250 | .502 | .098 | .240 | .025 | .416 | .30 |
| MS21075-4 | .2500-28 UNJF-3B | .801 | .286 | .254 | .281 | .564 | .098 | .300 | .032 | .500 | .49 |
| MS21075-5 | .3125-24 UNJF-3B | 1.01 | .364 | .317 | .328 | .720 | .130 | .375 | .032 | .581 | - |