



Allen Electric Connector Sales, inc.



TM

MS3450 WALL MOUNT RECEPTACLE

SHELL SIZE	A MAX	B ±.005	C ±.032	D ±.005	E MAX
------------	-------	---------	---------	---------	-------

SHELL SIZE	A MAX	B ±.005	C ±.032	D ±.005
------------	-------	---------	---------	---------

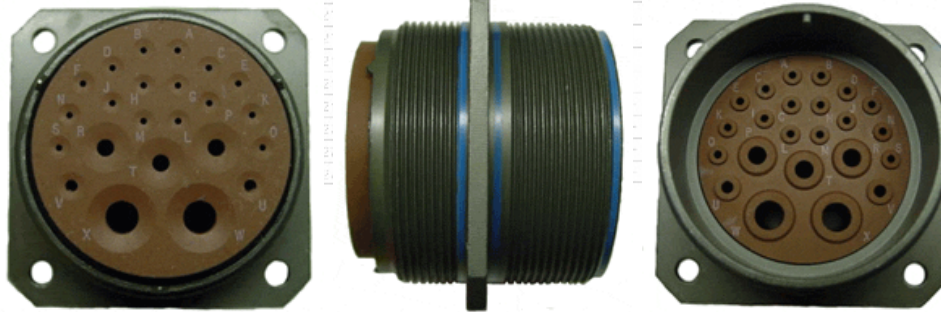

T DIA 4 HOLES
POLARIZING KEY

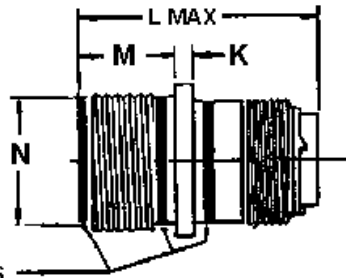
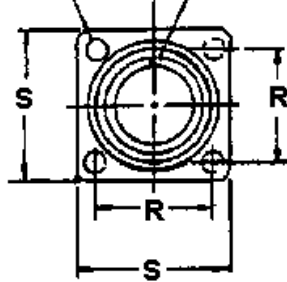

FOR PANEL CUTOUT SEE MS3452

BLUE STRIPE 3 PLACES

SIZE	K ±.015	L MAX		M +.031 -.000	N +.000 -.062	R T, P CL-CL	S ±.031	T +.010 -.005	
		SIZE 12 & 16 CONTACTS	SIZE 0, 4 & 8 CONTACTS					CLASS L U, W	CLASS K
8S	.083	2.031	-	.562	.532	.594	.875	.120	.150
10S	.083	2.051	-	.562	.656	.719	1.000	.120	.150
10SL	.083	2.051	-	.562	.656	.719	1.000	.120	.150
12S	.083	2.031	-	.562	.782	.812	1.094	.120	.150
12	.083	2.125	-	.750	.782	.812	1.094	.120	.150
14S	.083	2.031	-	.562	.906	.906	1.188	.120	.150
14	.083	2.125	-	.750	.906	.906	1.188	.120	.150
16S	.083	2.031	-	.562	1.032	.969	1.281	.120	.150
16	.083	2.125	2.500	.750	1.032	.969	1.281	.120	.150
18	.125	2.125	2.500	.750	1.158	1.062	1.375	.120	.150
20	.125	2.125	2.500	.750	1.282	1.156	1.500	.120	.177
22	.125	2.125	2.500	.750	1.406	1.250	1.625	.120	.177
24	.125	2.125	2.500	.812	1.532	1.375	1.750	.147	.177
28	.125	2.125	2.500	.812	1.782	1.562	2.000	.147	.177
32	.125	2.125	2.500	.875	2.032	1.750	2.250	.173	.209
36	.125	2.125	2.500	.875	2.282	1.938	2.500	.173	.209

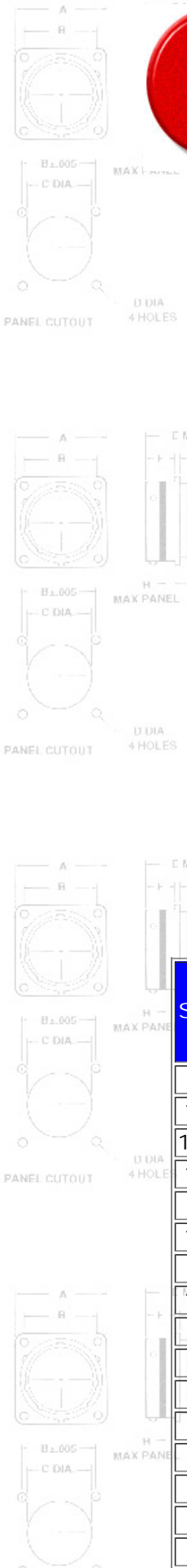

SHELL SIZE	A MAX	B ±.005	C ±.032	D ±.005
8	828	564	568	120
10	954	719	585	120
12	1047	812	564	120
14	1151	906	969	120
16	1234	969	1115	120
18	1328	1062	1236	120
20	1418	1156	1365	120
22	1528	1250	1486	120
24	1708	1375	1615	147

SHELL SIZE	A MAX	B ±.005	C ±.032	D ±.005
8	828	564	568	120
10	954	719	585	120
12	1047	812	564	120
14	1151	906	969	120
16	1234	969	1115	120
18	1328	1062	1236	120
20	1418	1156	1365	120
22	1528	1250	1486	120
24	1708	1375	1615	147

A MAX	B ±.005	C ±.032	D ±.005
828	564	568	120
954	719	585	120
1047	812	564	120
1151	906	969	120
1234	969	1115	120
1328	1062	1236	120
1418	1156	1365	120
1528	1250	1486	120
1708	1375	1615	147

40	2.125	2.125	2.500	.875	2.532	2.188	2.750	.173	.209
----	-------	-------	-------	------	-------	-------	-------	------	------

[MIL-DTL-5015 Insert Contacts, Service Rating & Clocking Positions](#)
[MIL-DTL-5015 Insert Arrangements](#)

MILITARY PART NUMBERING SYSTEM

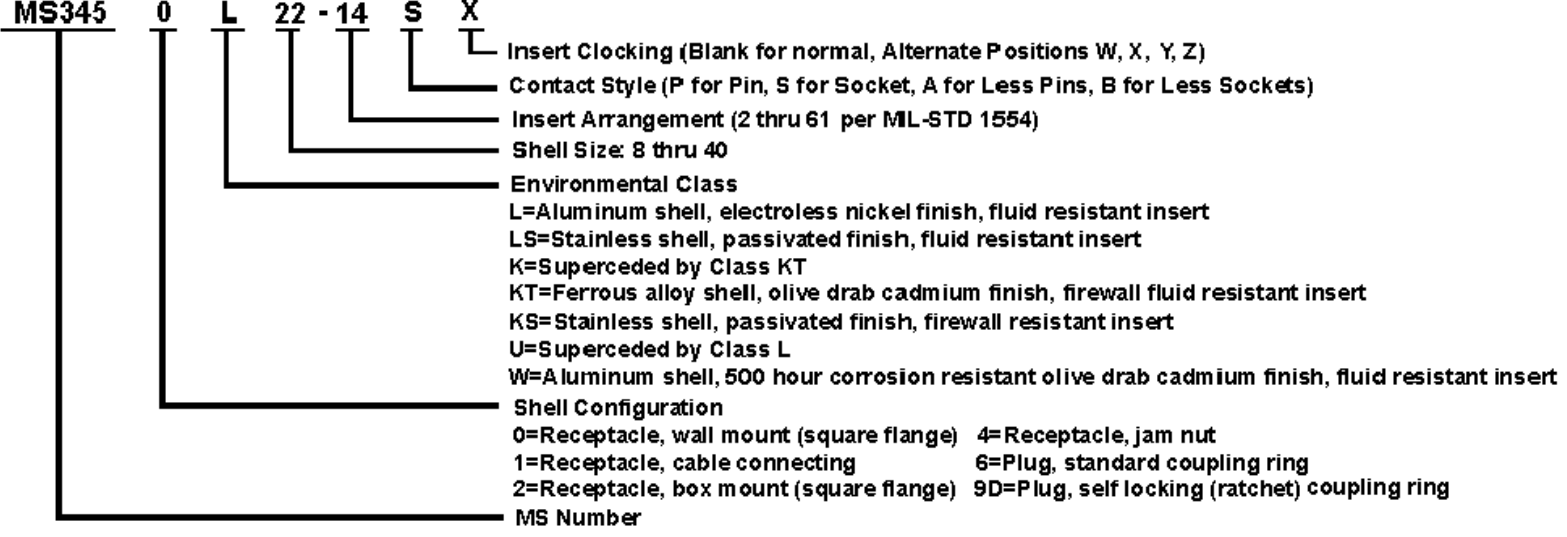

For pricing and availability, please fill out our RFQ form



If you need any other information, please [E-Mail aecs@aecsinc.com](mailto:aecs@aecsinc.com)

phone (703) 425-3815 fax (703) 425-3814

We look forward to hearing from you!



A Woman Owned Small Business, CAGE Code 07BG6

Copyright © 2008 Allen Electric Connector Sales, Inc. All Rights Reserved.