

Genuine Aircraft Hardware Co.

Washers Aircraft

NAS1149 Series, [REDACTED]

See next page for Crossover Chart

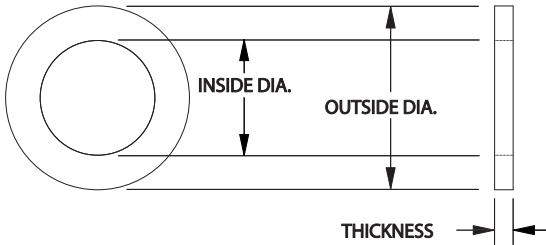

NAS1149 F 0332 P

BASIC # _____
 MATERIAL CODE _____
 SIZE & THICKNESS _____
 FINISH CODE _____

MATERIAL SPECIFICATION	CODE	FINISH SPECIFICATION (color)	CODE
300 STAINLESS, (75 KSI MIN UTS) .032 thru .090	C	PASSIVATE per QQ-P-35 (plain)	R
301 STAINLESS, (125 KSI MIN UTS) .016 ONLY	C	PASSIVATE per QQ-P-35 (plain)	R
2024 T3 ALUMINUM (58 KSI MIN UTS)	D	CHEMICAL TREAT per MIL-C-5541 Class 3, Conductive (gold)	J
2024 T3 ALUMINUM (58 KSI MIN UTS)	D	ANODIZE per MIL-A-8625 Class 2, non conductive (gray)	K
2024 T3 ALUMINUM (58 KSI MIN UTS)	D	NONE. (natural appearance of material)	H
A 286 HIGH TEMP STAINLESS, (160 KSI MIN UTS)	E	CADMIUM PLATE per QQ-P-416, Type II Class 2, (gold)	P
A 286 HIGH TEMP STAINLESS, (160 KSI MIN UTS)	E	PASSIVATE per QQ-P-35 (plain)	R
1020 CARBON STEEL, (55 KSI MIN UTS)	F	CADMIUM PLATE per QQ-P-416, Type II Class 2, (gold)	P
4130 ALLOY STEEL, (90 KSI MIN UTS)	G	CADMIUM PLATE per QQ-P-416, Type II Class 2, (gold)	P

Important Note: When asking for washers to fit most screws, see nominal I.D.s that start with (#) / For bolts see fractional I.D.'s
 I.E. a 3/8" bolt does NOT USE a #6 washer Many washers are ordered incorrectly such as when ordering as a washer that will fit a #4 bolt instead of a 1/4" bolt.

Fastener Type	NOMINAL INSIDE DIA.	INSIDE DIA. + or - .010	OUTSIDE DIA. +.020, -.005	SIZE AND THICKNESS NUMBER			
				.016 Thick	.032 Thick	.063 Thick	.090 Thick
SCREWS	# 2	.099	0.25	N216	N232		
	# 3	.105	.250	N316	N332		
	# 4	.125	.312	N416	N432		
	# 5	.140	.438	N516	N532	N542 (.042 Thickness)	
	# 6	.149	.375	N616	N632		
	# 8	.174	.375	N816	N832		
	# 9	.188	.500	N949 (.049 Thickness)			
	# 10 or 3/16	.203	.438	0316	0332	0363	
	# 11	.234	.625	N1165 (.065 Thickness)			
	1/4	.265	.500	0416	0432	0463	
	BOLTS	5/16	.328	.562	0516	0532	0563
3/8		.390	.625	0616	0632	0663	
7/16		.453	.750	0716	0732	0763	
1/2		.515	.875	0816	0832	0863	
9/16		.578	1.062	0916	0932	0963	
5/8		.640	1.188	1016	1032	1063	
3/4		.765	1.312	1216	1232		1290
7/8		.890	1.500	1416	1432		1490
1"		1.015	1.750	1616	1632		1690
1 1/16		1.078	1.812	1716	1732		1790
1 1/8		1.140	1.875	1816	1832		1890
1 1/4	1.265	2.000	2016	2032		2090	

Cross Reference Chart

AN960 to NAS1149 Washers

ORDER BY AN960 or NAS1149 #; we will supply the AN960s until depleted.

SEE PREVIOUS PAGE FOR PART NUMBER BREAKDOWN

OLD AN960 DASH NUMBER	NEW NAS1149 SIZE NUMBER	OLD AN960 DASH NUMBER	NEW NAS1149 SIZE NUMBER	OLD AN960 DASH NUMBER	NEW NAS1149 SIZE NUMBER	OLD AN960 DASH NUMBER	NEW NAS1149 SIZE NUMBER
AN960- 2	NAS1149F N232P	AN960C 2	NAS1149C N232R	AN960JD 2	NAS1149D N232J	AN960KD 2	NAS1149D N232K
AN960- 2L	NAS1149F N216P	AN960C 2L	NAS1149C N216R	AN960JD 2L	NAS1149D N216J	AN960KD 2L	NAS1149D N216K
AN960- 3	NAS1149F N332P	AN960C 3	NAS1149C N332R	AN960JD 3	NAS1149D N332J	AN960KD 3	NAS1149D N332K
AN960- 3L	NAS1149F N316P	AN960C 3L	NAS1149C N316R	AN960JD 3L	NAS1149D N316J	AN960KD 3L	NAS1149D N316K
AN960- 4	NAS1149F N432P	AN960C 4	NAS1149C N432R	AN960JD 4	NAS1149D N432J	AN960KD 4	NAS1149D N432K
AN960- 4L	NAS1149F N416P	AN960C 4L	NAS1149C N416R	AN960JD 4L	NAS1149D N416J	AN960KD 4L	NAS1149D N416K
AN960- 5	NAS1149F N542P	AN960C 5	NAS1149C N542R	AN960JD 5	NAS1149D N542J	AN960KD 5	NAS1149D N542K
AN960- 6	NAS1149F N632P	AN960C 6	NAS1149C N632R	AN960JD 6	NAS1149D N632J	AN960KD 6	NAS1149D N632K
AN960- 6L	NAS1149F N616P	AN960C 6L	NAS1149C N616R	AN960JD 6L	NAS1149D N616J	AN960KD 6L	NAS1149D N616K
AN960- 8	NAS1149F N832P	AN960C 8	NAS1149C N832R	AN960JD 8	NAS1149D N832J	AN960KD 8	NAS1149D N832K
AN960- 8L	NAS1149F N816P	AN960C 8L	NAS1149C N816R	AN960JD 8L	NAS1149D N816J	AN960KD 8L	NAS1149D N816K
AN960- 9	NAS1149F N949P	AN960C 9	NAS1149C N949R	AN960JD 9	NAS1149D N949J	AN960KD 9	NAS1149D N949K
AN960- 10	NAS1149F 0363P	AN960C 10	NAS1149C 0363R	AN960JD 10	NAS1149D 0363J	AN960KD 10	NAS1149D 0363K
AN960- 10L	NAS1149F 0332P	AN960C 10L	NAS1149C 0332R	AN960JD 10L	NAS1149D 0332J	AN960KD 10L	NAS1149D 0332K
				AN960JD 10LL	NAS1149D 0316J	AN960KD 10LL	NAS1149D 0316K
AN960- 11	NAS1149F N1165P	AN960C 11	NAS1149C N1165R	AN960JD 11	NAS1149D N1165J	AN960KD 11	NAS1149D N1165K
AN960- 416	NAS1149F 0463P	AN960C 416	NAS1149C 0463R	AN960JD 416	NAS1149D 0463J	AN960KD 416	NAS1149D 0463K
AN960- 416L	NAS1149F 0432P	AN960C 416L	NAS1149C 0432R	AN960JD 416L	NAS1149D 0416J	AN960KD 416L	NAS1149D 0416K
AN960- 516	NAS1149F 0563P	AN960C 516	NAS1149C 0563R	AN960JD 516	NAS1149D 0563J	AN960KD 516	NAS1149D 0563K
AN960- 516L	NAS1149F 0532P	AN960C 516L	NAS1149C 0532R	AN960JD 516L	NAS1149D 0516J	AN960KD 516L	NAS1149D 0516K
AN960- 616	NAS1149F 0663P	AN960C 616	NAS1149C 0663R	AN960JD 616	NAS1149D 0663J	AN960KD 616	NAS1149D 0663K
AN960- 616L	NAS1149F 0632P	AN960C 616L	NAS1149C 0632R	AN960JD 616L	NAS1149D 0616J	AN960KD 616L	NAS1149D 0616K
AN960- 616LL	NAS1149F 0616P	AN960C 616LL	NAS1149C 0616R	AN960JD 616LL	NAS1149D 0616J	AN960KD 616LL	NAS1149D 0616K
AN960- 716	NAS1149F 0763P	AN960C 716	NAS1149C 0763R	AN960JD 716	NAS1149D 0763J	AN960KD 716	NAS1149D 0763K
AN960- 716L	NAS1149F 0732P	AN960C 716L	NAS1149C 0732R	AN960JD 716L	NAS1149D 0716J	AN960KD 716L	NAS1149D 0716K
				AN960JD 716LL	NAS1149D 0716J	AN960KD 716LL	NAS1149D 0716K
AN960- 816	NAS1149F 0863P	AN960C 816	NAS1149C 0863R	AN960JD 816	NAS1149D 0863J	AN960KD 816	NAS1149D 0863K
AN960- 816L	NAS1149F 0832P	AN960C 816L	NAS1149C 0832R	AN960JD 816L	NAS1149D 0816J	AN960KD 816L	NAS1149D 0816K
AN960- 916	NAS1149F 0963P	AN960C 916	NAS1149C 0963R	AN960JD 916	NAS1149D 0963J	AN960KD 916	NAS1149D 0963K
AN960- 916L	NAS1149F 0932P	AN960C 916L	NAS1149C 0932R	AN960JD 916L	NAS1149D 0916J	AN960KD 916L	NAS1149D 0916K
AN960- 1016	NAS1149F 1063P	AN960C 1016	NAS1149C 1063R	AN960JD 1016	NAS1149D 1063J	AN960KD 1016	NAS1149D 1063K
AN960- 1016L	NAS1149F 1032P	AN960C 1016L	NAS1149C 1032R	AN960JD 1016L	NAS1149D 1016J	AN960KD 1016L	NAS1149D 1016K
AN960- 1216	NAS1149F 1290P	AN960C 1216	NAS1149C 1290R	AN960JD 1216	NAS1149D 1290J	AN960KD 1216	NAS1149D 1290K
AN960- 1216L	NAS1149F 1232P	AN960C 1216L	NAS1149C 1232R	AN960JD 1216L	NAS1149D 1216J	AN960KD 1216L	NAS1149D 1216K
AN960- 1416	NAS1149F 1490P	AN960C 1416	NAS1149C 1490R	AN960JD 1416	NAS1149D 1490J	AN960KD 1416	NAS1149D 1490K
AN960- 1416L	NAS1149F 1432P	AN960C 1416L	NAS1149C 1432R	AN960JD 1416L	NAS1149D 1416J	AN960KD 1416L	NAS1149D 1416K
AN960- 1616	NAS1149F 1690P	AN960C 1616	NAS1149C 1690R	AN960JD 1616	NAS1149D 1690J	AN960KD 1616	NAS1149D 1690K
AN960- 1616L	NAS1149F 1632P	AN960C 1616L	NAS1149C 1632R	AN960JD 1616L	NAS1149D 1616J	AN960KD 1616L	NAS1149D 1616K
AN960- 1716	NAS1149F 1790P	AN960C 1716	NAS1149C 1790R	AN960JD 1716	NAS1149D 1790J	AN960KD 1716	NAS1149D 1790K
AN960- 1716L	NAS1149F 1732P			AN960JD 1716L	NAS1149D 1716J	AN960KD 1716L	NAS1149D 1716K
AN960- 1816	NAS1149F 1890P	AN960C 1816	NAS1149C 1890R	AN960JD 1816	NAS1149D 1890J	AN960KD 1816	NAS1149D 1890K
AN960- 1816L	NAS1149F 1832P			AN960JD 1816L	NAS1149D 1816J	AN960KD 1816L	NAS1149D 1816K
AN960- 2016	NAS1149F 2090P	AN960C 2016	NAS1149C 2090R	AN960JD 2016	NAS1149D 2090J	AN960KD 2016	NAS1149D 2090K
AN960- 2016L	NAS1149F 2032P			AN960JD 2016L	NAS1149D 2016J	AN960KD 2016L	NAS1149D 2016K