

Part No.: NET-3631/32AS-11

Features:

- 0.36 INCH DIGIT HEIGHT.
- LOW CURRENT OPERATION.
- EASY MOUNTING ON P.C. BOARDS OR SOCKETS.
- I.C. COMPATIBLE.
- MECHANICALLY RUGGED.
- STANDARD: BLACK FACE,WHITE SEGMENT.
- RoHS COMPLIANT

Descriptions:

The Super Bright Red source color devices are made with Gallium Aluminum Arsenide Red Light Emitting Diode

Package Dimensions & Internal Circuit Diagram

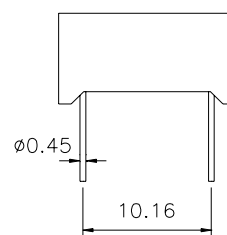
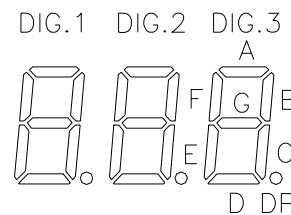
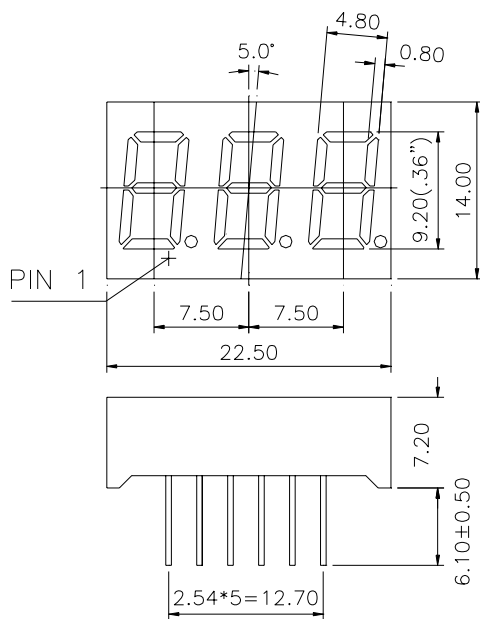

NET-3631AS

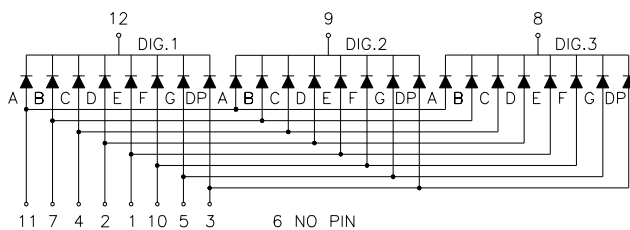

NET-3632AS

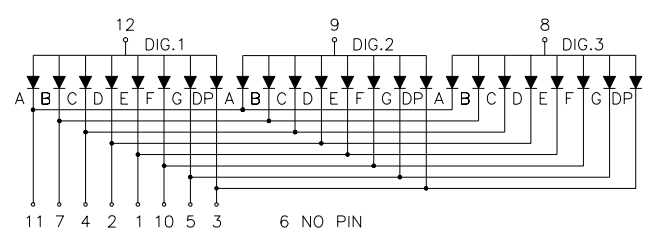

Notes:

1. All dimensions are in millimeters(inches), Tolerance is ± 0.25 (0.01") unless otherwise noted.
2. Specifications are subject to change without notice.

Absolute maximum ratings (Ta = 25°C)

Parameter	Symbol	Test Condition	Value		Unit
			Min.	Max.	
Reverse Voltage	V _R	I _R = 30 μ A	5	--	V
Forward Current	I _F	----	----	30	mA
Power Dissipation	P _d	----	----	100	mW
Pulse Current	I _{peak}	Duty=0.1mS, 1kHz	----	150	mA
Operating Temperature	T _{opr}	----	-40	+85	°C
Storage Temperature	T _{str}	----	-40	+85	°C

Electrical and optical characteristics (Ta = 25°C)

Parameter	Symbol	Test Condition	Values			Unit
			Min.	Typ.	Max.	
Forward Voltage	V _F	I _F =20mA	----	1.8	2.3	V
Reverse Current	I _R	V _R =5V	----	----	30	μ A
Dominate Wavelength	λ _d	I _F =20mA	----	640	----	nm
Peak Wavelength	λ _p	I _F =20mA	----	660	----	nm
Spectral Line half-width	Δ λ	I _F =20mA	----	20	----	nm
Luminous Intensity	I _v	I _F =10mA	----	3500	----	ucd

Typical electrical/optical characteristic curves:

