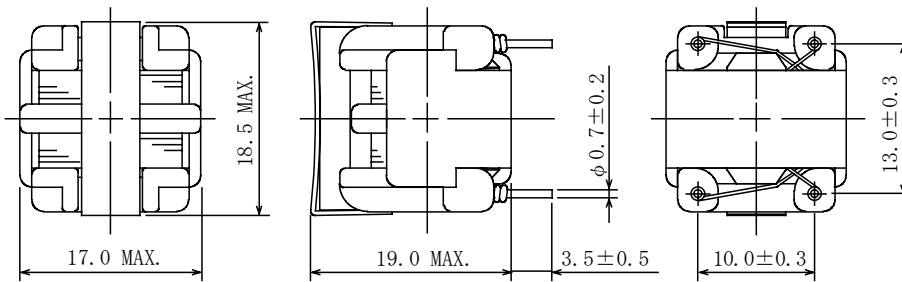

**Type: PFD1617**
**◆ Product Description**

- 18.5×17.0mm Max.(L×W), 19.0mm Max. Height .
- Inductance range: 0.63mH~87mH
- Rated current range: 0.125A~1.71A
- In addition to the standard versions of parameters shown here, custom designs are available to meet your exact requirements.

[www.DataSheet4U.com](http://www.DataSheet4U.com)
**◆ Feature**

- Safety standard conformance such as UL.
- Ideally used in TV, VCRs, OA devices.
- RoHs Compliance

**◆ Dimensions (mm)**

- \* Dimension does not include solder used on coil.
- \* Terminal pitch is measured at the base(not from tip of the pin)

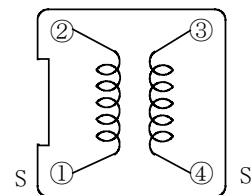
**◆ Schematics (Bottom)**

"S" is winding start.

**◆ Specification**

Part Name	Stamp	Inductance (mH) (Min.) (1-2) and (4-3) at 1 kHz	Inductance (μH) at 1 kHz (Max.)	Inductance (Min.)(1-4) (2-3 To Be Short) at 1 kHz	D.C.R.(Ω) (Max.) at 20°C (1-2) and(4-3)	Rated current (50/60Hz) (mA) (1-4) (2-3 To Be Short) ※1
PFD1617NP-B631	B631	0.63	19	37 μH	0.112	1710
PFD1617NP-B102	B102	1.0	30	65 μH	0.19	1260
PFD1617NP-B172	B172	1.7	51	105 μH	0.33	1025
PFD1617NP-B432	B432	4.3	129	256 μH	0.69	670
PFD1617NP-B762	B762	7.6	228	453 μH	1.19	525
PFD1617NP-B123	B123	12	360	727 μH	1.85	400
PFD1617NP-B173	B173	17	510	1.0mH	2.75	300
PFD1617NP-B303	B303	30	600	1.8mH	4.70	235
PFD1617NP-B483	B483	48	960	2.9mH	7.58	175
PFD1617NP-B873	B873	87	1740	5.3mH	13.8	125

※1. Rated current: The AC current at which the temperature rise is Δt=40°C.(Ta=20°C).