

PSW27, PSW28, PSW29 Series

Pressure & vacuum switches
Compact, rugged, pre-fixed setpoint

**INSTRUCTION
SHEET**

M4070-0504

*Shop online at: omega.com e-mail: info@omega.com
For latest product manuals: omegamanual.info*

Installation instructions for OMEGA PSW27, PSW28 & PSW29 Series: Pressure and vacuum switches, compact, rugged, pre-fixed setpoint.

General

These reliable, compact single pole switches are used in pressure and vacuum applications where moderate accuracy is sufficient. The fixed setpoint is factory set.

Additional Information

Temperature Range: -10 to 75°C (14 to 167°F)

Setpoint Accuracy: +/- 10% at 70°F. *Note: pressure settings may change over the temperature range.*

Pressure Connection:

PSW27: 1/8" NPT male.

PSW28: Center spout for 1/8" ID tubing. Provided with 9/16-18 mounting nut.

PSW29: Radial spout for 1/8" ID tubing.

Approvals: UL recognized, CSA certified, microswitches bear the ENEC & CE Mark.

PSW27 Series

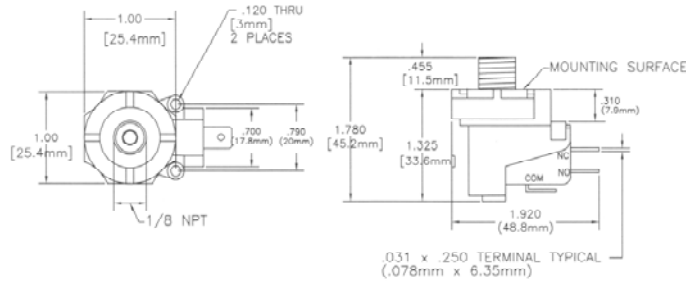

Mounting Instructions

PSW27 series come with a 1/8 NPT male pressure connection with a 9/16 threaded mounting, and nut is included.

Electrical/Pneumatic Specification for PSW27 Series Pressure Switches

Model No.	Fixed Setpoint	Proof Pressure	SPDT Switch Rating
PSW27-1P	1 psig	30 psig	10 amps (resistive)
PSW27-2P	2 psig	50 psig	21 amps (resistive)
PSW27-5P	5 psig	50 psig	21 amps (resistive)
PSW27-10P	10 psig	50 psig	21 amps (resistive)
PSW27-20P	20 psig	50 psig	21 amps (resistive)
PSW27-30P	30 psig	80 psig	21 amps (resistive)
PSW27-40P	40 psig	80 psig	21 amps (resistive)
PSW27-50P	50 psig	80 psig	21 amps (resistive)

Electrical/Pneumatic Specifications for PSW27V Vacuum Switches

Model No.	Fixed Setpoint	Proof Pressure	SPDT Switch Rating
PSW27V-25W	25" WC Vac	300" WC Vac	10 amps (resistive)
PSW27V-30W	30" WC Vac	300" WC Vac	10 amps (resistive)
PSW27V-40W	40" WC Vac	300" WC Vac	21 amps (resistive)
PSW27V-50W	50" WC Vac	300" WC Vac	21 amps (resistive)
PSW27V-75W	75" WC Vac	350" WC Vac	21 amps (resistive)
PSW27V-100W	100" WC Vac	350" WC Vac	21 amps (resistive)
PSW27V-150W	150" WC Vac	350" WC Vac	21 amps (resistive)
PSW27V-200W	200" WC Vac	350" WC Vac	21 amps (resistive)

PSW28 Series

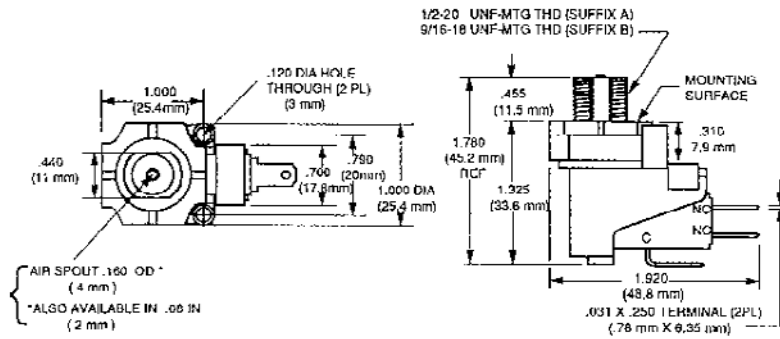

Mounting Instructions

PSW28 Series come with a center spout for 1/8" ID tubing, with a 9/16 mounting thread and tube lock nut included.

Electrical/Pneumatic Specifications for PSW28 Pressure Series

Model No.	Fixed Setpoint	Proof Pressure	SPDT Switch Rating
PSW28-1P	1 psig	30 psig	10 amps (resistive)
PSW28-2P	2 psig	50 psig	21 amps (resistive)
PSW28-5P	5 psig	50 psig	21 amps (resistive)
PSW28-10P	10 psig	50 psig	25 amps (resistive)
PSW28-20P	20 psig	50 psig	25 amps (resistive)
PSW28-30P	30 psig	80 psig	25 amps (resistive)
PSW28-40P	40 psig	80 psig	25 amps (resistive)
PSW28-50P	50 psig	80 psig	25 amps (resistive)

Electrical/Pneumatic Specifications for PSW28V Vacuum Series

Model No.	Fixed Setpoint	Proof Pressure	SPDT Switch Rating
PSW28V-25W	25" WC Vac	300" WC Vac	10 amps (resistive)
PSW28V-30W	30" WC Vac	300" WC Vac	10 amps (resistive)
PSW28V-40W	40" WC Vac	300" WC Vac	21 amps (resistive)
PSW28V-50W	50" WC Vac	300" WC Vac	21 amps (resistive)
PSW28V-75W	75" WC Vac	350" WC Vac	21 amps (resistive)
PSW28V-100W	100" WC Vac	350" WC Vac	21 amps (resistive)

PSW29 Series

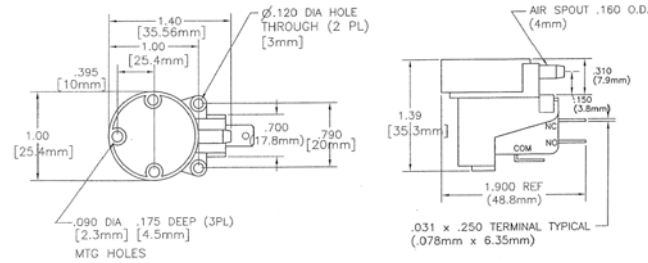

Mounting Instructions

Radial spout for 1/8" ID tubing. Through hole legs for mounting bolt.

Electrical/Pneumatic Specifications for PSW29 Pressure series

Model No.	Fixed Setpoint	Proof Pressure	SPDT Switch Rating
PSW29-1P	1 psig	30 psig	10 amps (resistive)
PSW29-2P	2 psig	50 psig	21 amps (resistive)
PSW29-5P	5 psig	50 psig	21 amps (resistive)
PSW29-10P	10 psig	50 psig	21 amps (resistive)
PSW29-20P	20 psig	50 psig	21 amps (resistive)
PSW29-30P	30 psig	50 psig	21 amps (resistive)

Materials of Construction (All Series)

Body	Acetal
Diaphragm	EPDM (Ethylene-Propylene Diene Monomer) <i>The EPDM diaphragm should not be used with petroleum products. Specificity Nitrile for these applications.</i>
Hysteresis (Dead Band)	Pressure switches: approximately 25% of the setpoint. Vacuum switches: approximately 30% of the setpoint.
Electrical Connection	6.35mm (0.25") standard "Slide-On" male terminals
Proof Pressure	See table.
Media Compatibility	Air, water and many other fluids and gases that are compatible with EPDM & Acetal. <i>Note: Mineral Oil and similar fluids are not compatible with EPDM. Request Nitrile diaphragm.</i>
Overall Dimensions	46 x 51 x 26 mm (approximately 1.75" x 2" x 1")
Weight	6 g (0.2 oz)
Listings	UL Recognized & CSA Certified



OMEGAnet® Online Service www.omega.com	Internet e-mail info@omega.com
---	---

Servicing North America:

USA: One Omega Drive, Box 4047
Stamford CT 06907-0047
Tel: (203) 359-1660 FAX: (203) 359-7700
e-mail: info@omega.com

Canada: 976 Bergar
Laval (Quebec) H7L 5A1, Canada
Tel: (514) 856-6928 FAX: (514) 856-6886
e-mail: info@omega.ca

For immediate technical or application assistance:

USA and Canada: Sales Service: 1-800-826-6342 / 1-800-TC-OMEGA®
Customer Service: 1-800-622-2378 / 1-800-622-BEST®
Engineering Service: 1-800-872-9436 / 1-800-USA-WHEN®
TELEX: 996404 EASYLINK: 62968934 CABLE: OMEGA

Mexico: En Español: (001) 203-359-7803 e-mail: espanol@omega.com
FAX: (001) 203-359-7807 info@omega.com.mx

Servicing Europe:

Benelux: Postbus 8034, 1180 LA Amstelveen, The Netherlands
Tel: +31 (0)20 3472121 FAX: +31 (0)20 6434643
Toll Free in Benelux: 0800 0993344
e-mail: sales@omegaeng.nl

Czech Republic: Frystatska 184, 733 01 Karviná, Czech Republic
Tel: +420 (0)59 6311899 FAX: +420 (0)59 6311114
Toll Free: 0800-1-66342 e-mail: info@omegashop.cz

France: 11, rue Jacques Cartier, 78280 Guyancourt, France
Tel: +33 (0)1 61 37 2900 FAX: +33 (0)1 30 57 5427
Toll Free in France: 0800 466 342
e-mail: sales@omega.fr

Germany/Austria: Daimlerstrasse 26, D-75392 Deckenpfronn, Germany
Tel: +49 (0)7056 9398-0 FAX: +49 (0)7056 9398-29
Toll Free in Germany: 0800 639 7678
e-mail: info@omega.de

United Kingdom: One Omega Drive, River Bend Technology Centre
ISO 9002 Certified Northbank, Irlam, Manchester
M44 5BD United Kingdom
Tel: +44 (0)161 777 6611 FAX: +44 (0)161 777 6622
Toll Free in United Kingdom: 0800-488-488
e-mail: sales@omega.co.uk

It is the policy of OMEGA to comply with all worldwide safety and EMC/EMI regulations that apply. OMEGA is constantly pursuing certification of its products to the European New Approach Directives. OMEGA will add the CE mark to every appropriate device upon certification.

The information contained in this document is believed to be correct, but OMEGA Engineering, Inc. accepts no liability for any errors it contains, and reserves the right to alter specifications without notice. **WARNING:** These products are not designed for use in, and should not be used for, human applications.

WARRANTY/DISCLAIMER

OMEGA ENGINEERING, INC. warrants this unit to be free of defects in materials and workmanship for a period of **13 months** from date of purchase. OMEGA's WARRANTY adds an additional one (1) month grace period to the normal **one (1) year product warranty** to cover handling and shipping time. This ensures that OMEGA's customers receive maximum coverage on each product.

If the unit malfunctions, it must be returned to the factory for evaluation. OMEGA's Customer Service Department will issue an Authorized Return (AR) number immediately upon phone or written request. Upon examination by OMEGA, if the unit is found to be defective, it will be repaired or replaced at no charge. OMEGA's WARRANTY does not apply to defects resulting from any action of the purchaser, including but not limited to mishandling, improper interfacing, operation outside of design limits, improper repair, or unauthorized modification. This WARRANTY is VOID if the unit shows evidence of having been tampered with or shows evidence of having been damaged as a result of excessive corrosion; or current, heat, moisture or vibration; improper specification; misapplication; misuse or other operating conditions outside of OMEGA's control. Components which wear are not warranted, including but not limited to contact points, fuses, and triacs.

OMEGA is pleased to offer suggestions on the use of its various products. However, OMEGA neither assumes responsibility for any omissions or errors nor assumes liability for any damages that result from the use of its products in accordance with information provided by OMEGA, either verbal or written. OMEGA warrants only that the parts manufactured by it will be as specified and free of defects. OMEGA MAKES NO OTHER WARRANTIES OR REPRESENTATIONS OF ANY KIND WHATSOEVER, EXPRESS OR IMPLIED, EXCEPT THAT OF TITLE, AND ALL IMPLIED WARRANTIES INCLUDING ANY WARRANTY OF MERCHANTABILITY AND FITNESS FOR A PARTICULAR PURPOSE ARE HEREBY DISCLAIMED. LIMITATION OF LIABILITY: The remedies of purchaser set forth herein are exclusive, and the total liability of OMEGA with respect to this order, whether based on contract, warranty, negligence, indemnification, strict liability or otherwise, shall not exceed the purchase price of the component upon which liability is based. In no event shall OMEGA be liable for consequential, incidental or special damages.

CONDITIONS: Equipment sold by OMEGA is not intended to be used, nor shall it be used: (1) as a "Basic Component" under 10 CFR 21 (NRC), used in or with any nuclear installation or activity; or (2) in medical applications or used on humans. Should any Product(s) be used in or with any nuclear installation or activity, medical application, used on humans, or misused in any way, OMEGA assumes no responsibility as set forth in our basic WARRANTY/DISCLAIMER language, and, additionally, purchaser will indemnify OMEGA and hold OMEGA harmless from any liability or damage whatsoever arising out of the use of the Product(s) in such a manner.

RETURN REQUESTS / INQUIRIES

Direct all warranty and repair requests/inquiries to the OMEGA Customer Service Department. BEFORE RETURNING ANY PRODUCT(S) TO OMEGA, PURCHASER MUST OBTAIN AN AUTHORIZED RETURN (AR) NUMBER FROM OMEGA'S CUSTOMER SERVICE DEPARTMENT (IN ORDER TO AVOID PROCESSING DELAYS). The assigned AR number should then be marked on the outside of the return package and on any correspondence.

The purchaser is responsible for shipping charges, freight, insurance and proper packaging to prevent breakage in transit.

PATENT NOTICE: U. S. Pat. No. 6,074,089; 5,465,838 / Canada 2,228,333; 2,116,055 / UK GB 2,321,712 / Holland 1008153 / Israel 123052 / France 2 762 908 / EPO 0614194. Other patents pending.

FOR **WARRANTY** RETURNS, please have the following information available BEFORE contacting OMEGA:

1. Purchase Order number under which the product was PURCHASED,
2. Model and serial number of the product under warranty, and
3. Repair instructions and/or specific problems relative to the product.

FOR **NON-WARRANTY** REPAIRS, consult OMEGA for current repair charges. Have the following information available BEFORE contacting OMEGA:

1. Purchase Order number to cover the COST of the repair,
2. Model and serial number of the product, and
3. Repair instructions and/or specific problems relative to the product.

OMEGA's policy is to make running changes, not model changes, whenever an improvement is possible. This affords our customers the latest in technology and engineering.

OMEGA is a registered trademark of OMEGA ENGINEERING, INC.

© Copyright 2004 OMEGA ENGINEERING, INC. All rights reserved. This document may not be copied, photocopied, reproduced, translated, or reduced to any electronic medium or machine-readable form, in whole or in part, without the prior written consent of OMEGA ENGINEERING, INC.