

SERVICE MANUAL

STEREO TURNTABLE SYSTEM

SPECIFICATIONS

| | |
|-------------------|-----------------------------------|
| Motor | DC servo motor |
| Drive system | Belt drive |
| Speed | 33-1/3 rpm, 45 rpm |
| Wow & flutter | 0.25% (WRMS) |
| S/N ratio | 45 dB (DIN-B) |
| Cartridge type | VM type |
| Stylus | AIWA AN-11 |
| Output level | 200 mV (2.5 mV/sw. OFF) |
| Dimensions | Approx. 360 × 97 × 358 mm (w/h/d) |
| Weight | Approx. 2.4 kg net |
| Power requirement | 230 V AC, 50 Hz |
| Power consumption | 3 watts |

Design and specifications subject to change without notice.

This Service Manual is the "Revision Publishing" and replaces "Simple Manual"
PX-E860<EZST>(S/M Code No.09-993-322-0T1).

ADJUSTMENT

1. Auto Return Adjustment.

Test Record (HP - 4005)

| Adjustment | Count |
|-------------|--------|
| Auto Return | 9 - 12 |

2. Auto Lead-in Adjustment.

Test Record (HT - 5 side1)

| Adjustment | Disk Size | Count |
|--------------|-----------|---------|
| Auto Lead-in | 30cm | 13 - 17 |
| | 17cm | 13 - 16 |

3. Phono Motor Speed Adjustment.

Test Record (HP - 4005)

| | |
|-------|--------|
| 33rpm | 3000Hz |
| 45rpm | 3000Hz |

4. Switch Adjustment.

- (1). Fix tonearm on armrest, remove bottom cover.
- (2). Turn the switch adj. screw so that the plastic tip touches the center position of leaf switch.
- (3). Turn the copper screw so that the gap between two contact point on the leaf switch is from 0.35mm to 0.8mm.

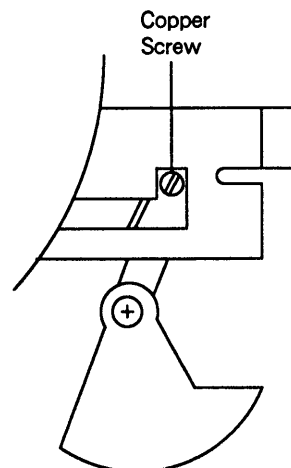
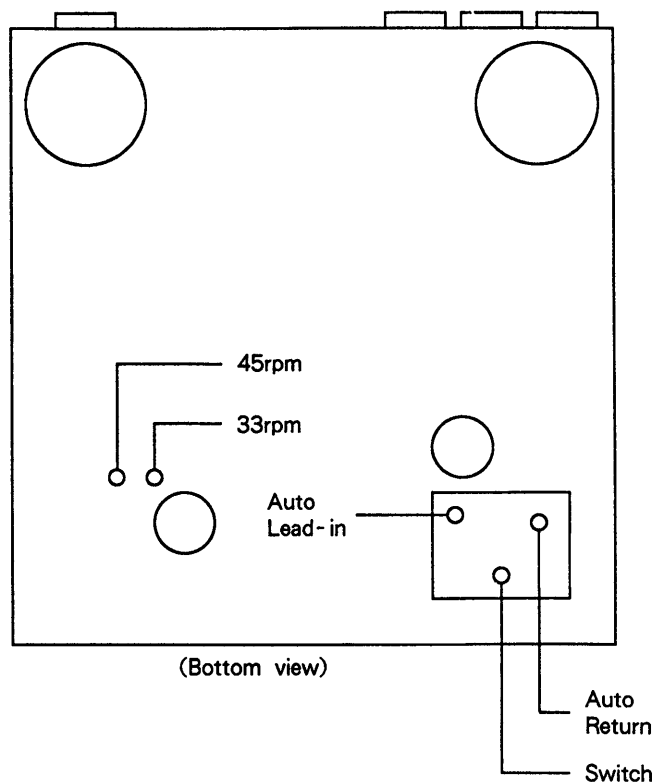

PRACTICAL SERVICE FIGURE

< Turntable Section >

Wow & flutter : Less than 0.23% (WRMS)

< Cartridge Section >

Stylus trip : 0.6mil

Stylus pressure : 3.5g

Output voltage : 127~262mV

ELECTRICAL MAIN PARTS LIST

DESCRIPTIONで判断できない物は "REFERENCE NAME LIST" を参照してください。
If can't understand for Description please kindly refer to "REFERENCE NAME LIST".

| REF. NO | PART NO. | KANRI NO. | DESCRIPTION |
|---------|----------|-----------|-------------|
|---------|----------|-----------|-------------|

IC

| | | | |
|--|----------------|-----------|--|
| | 87-027-683-010 | IC,TA7325 | |
|--|----------------|-----------|--|

DIODE

| | | | |
|--|----------------|--------------|--|
| | 87-001-783-080 | DIODE,1N4002 | |
|--|----------------|--------------|--|

PRE AMP C.B

| | | | |
|-------|----------------|---------------|--|
| | S8-E27-BK0-190 | SIGNAL WIRE | |
| C102 | 87-015-995-810 | CAP,E 4.7-50V | |
| C104 | 87-010-412-010 | CAP,E 10-25V | |
| C107 | 87-015-995-810 | CAP,E 4.7-50V | |
| C202 | 87-015-995-810 | CAP,E 4.7-50V | |
| C204 | 87-010-412-010 | CAP,E 10-25V | |
| C207 | 87-015-995-810 | CAP,E 4.7-50V | |
| C301 | 87-010-564-010 | CAP,E 100-16V | |
| C302 | 87-010-564-010 | CAP,E 100-16V | |
| SW101 | S3-PXE-900-280 | SLIDE SWITCH | |

POWER C.B

| | | | |
|----|----------------|--------------------|--|
| C1 | 87-010-237-010 | CAP,E 1000UF/16V M | |
|----|----------------|--------------------|--|

ACCESSORIES LIST

DESCRIPTIONで判断できない物は "REFERENCE NAME LIST" を参照してください。
If can't understand for Description please kindly refer to "REFERENCE NAME LIST".

| REF. NO | PART NO. | KANRI NO. | DESCRIPTION |
|---------|----------|-----------|-------------|
|---------|----------|-----------|-------------|

| | | | |
|---|----------------|--------------------------------|--|
| 1 | S0-0H2-000-160 | ADAPTOR 45RPM | |
| 2 | S8-60E-1C7-500 | INSTRUCTION BOOK(PXE860EZ)<EZ> | |
| 2 | SE-860-KC7-530 | INSTRUCTION BOOK(PXE860K)<K> | |
| 2 | SE-860-UC7-520 | INSTRUCTION BOOK(PXE860U)<U> | |
| 3 | SX-E85-5E6-050 | INSTRUCTION BOOK<EZ> | |

WIRING

1 2 3 4 5 6 7

A
B
C
D
E
F
G
H
I
J

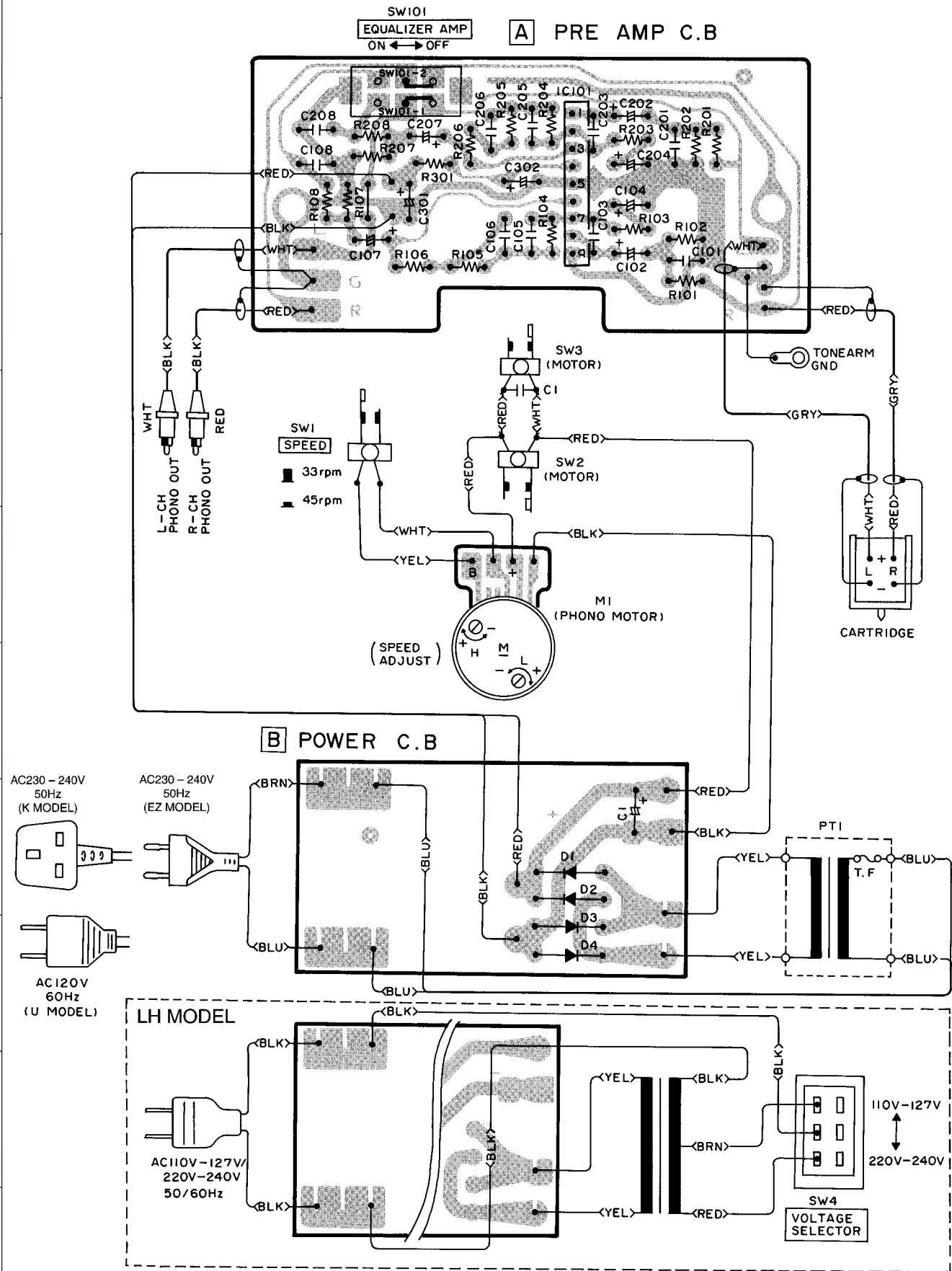

SCHEMATIC DIAGRAM

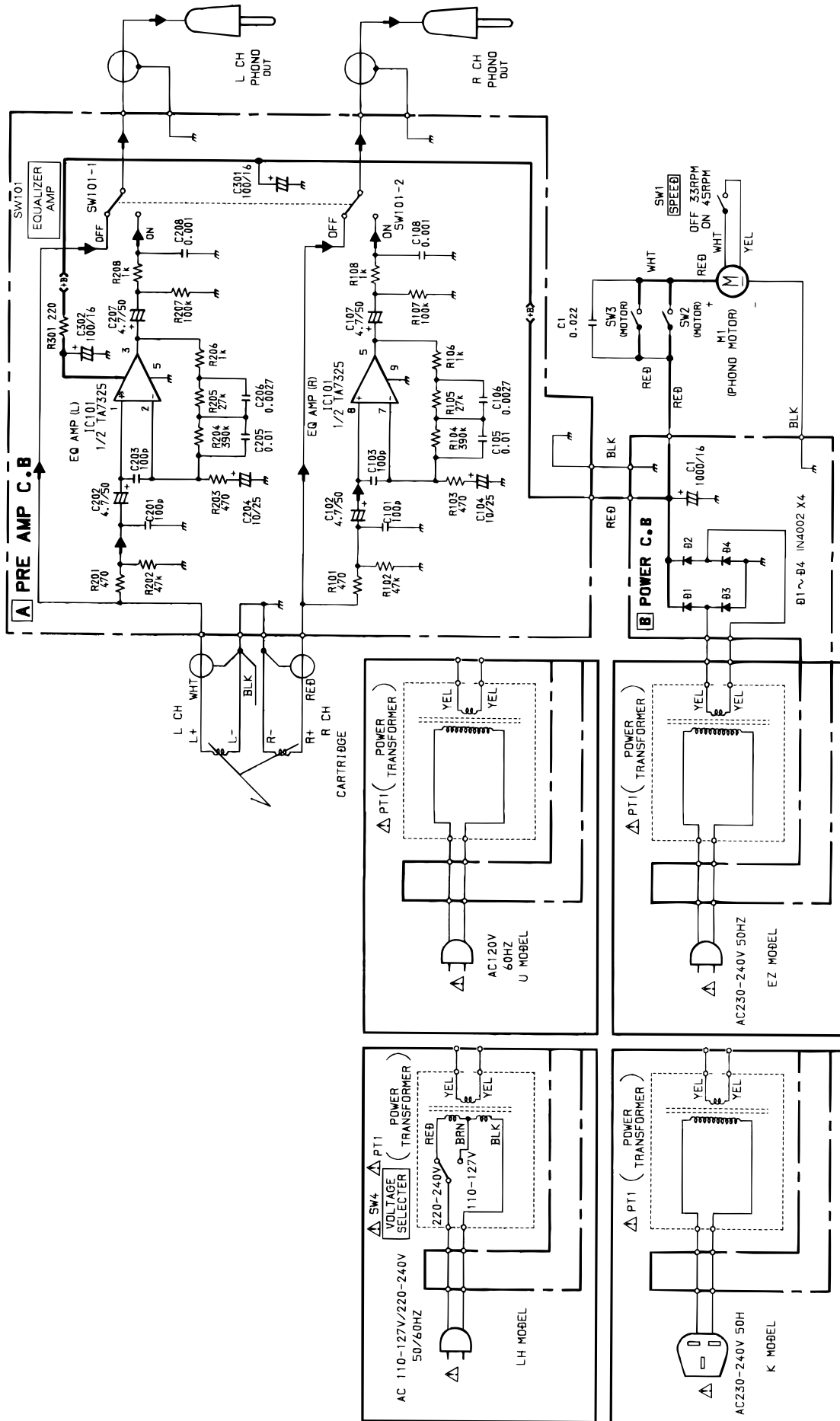

MECHANICAL EXPLODED VIEW 1/1

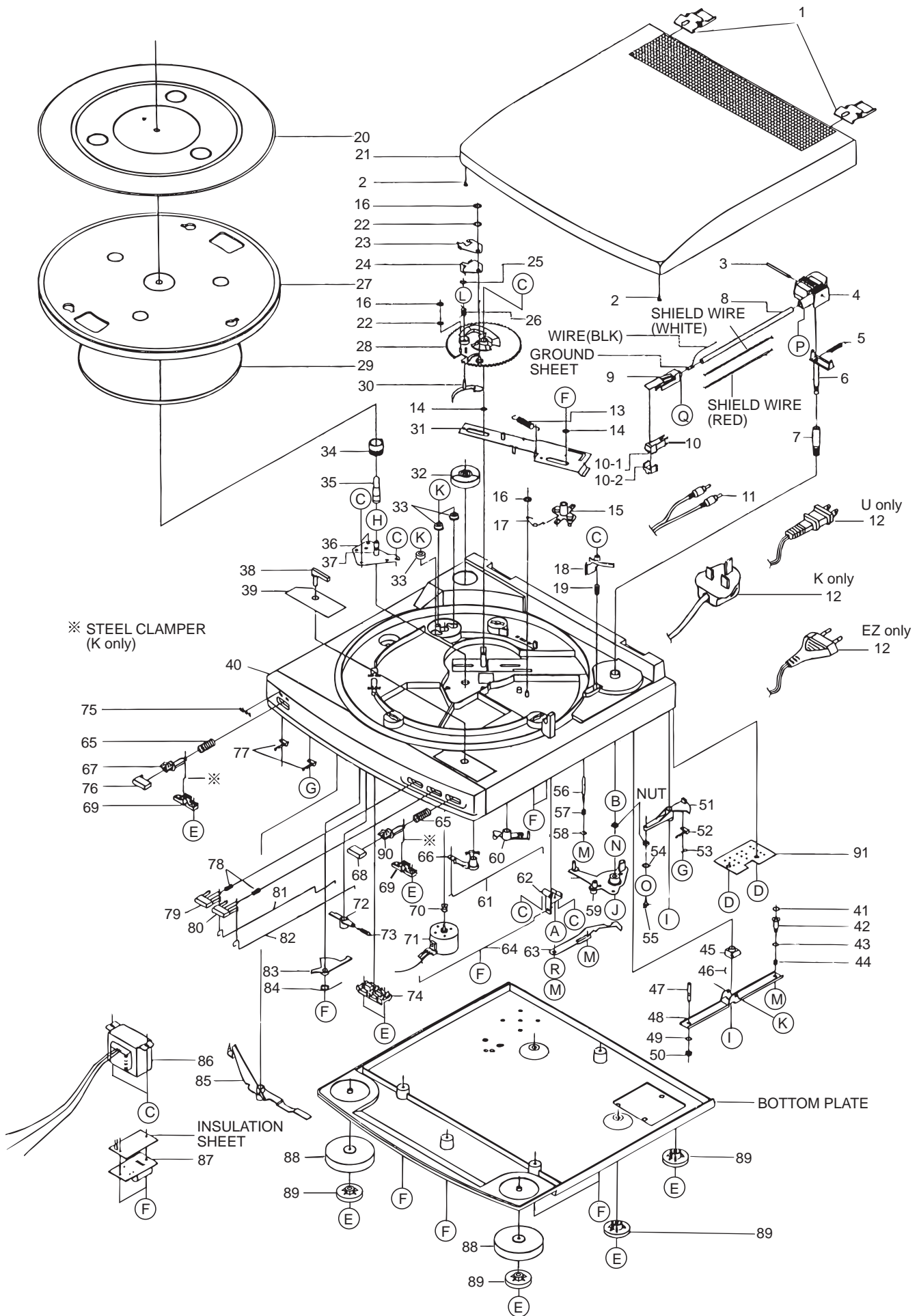

MECHANICAL MAIN PARTS LIST 1/1

DESCRIPTIONで判断できない物は "REFERENCE NAME LIST" を参照してください。
 If can't understand for Description please kindly refer to "REFERENCE NAME LIST".

| REF. NO | PART NO. | KANRI NO. | DESCRIPTION | REF. NO | PART NO. | KANRI NO. | DESCRIPTION |
|--------------------|----------------|----------------|-----------------------------|---------|----------------|----------------|-----------------------------|
| 1 | S0-3B6-000-260 | | HINGE ASS'Y | 67 | S0-0B6-001-390 | | KNOB SHAFT |
| 2 | S4-B60-002-6A0 | | FOOT FOR DUST COVER(PXE850) | 68 | SP-EX8-509-000 | | CUE, KNOB(PXE860) |
| 3 | S0-SL2-4F1-180 | | PIN (FOR TONEARM SET) | 69 | S0-0F7-002-590 | | KNOB SET |
| 4 | S0-SL2-4F2-310 | | STONE ARM SET | 70 | S0-0L1-001-330 | | PULLEY |
| 5 | S3-SL2-4F0-830 | | SPRING | 71 | S0-1H7-030-380 | | MOTOR MMI-6T2RWK |
| 6 | S3-SL2-4F0-560 | | ROTARY SHAFT ASSY | 72 | S0-SL2-4F2-400 | | PENDULUM(S) |
| 7 | S0-SL2-4F1-070 | | STONE ARM SHAFT SET | 73 | S3-SL2-4F0-660 | | SPRING |
| 8 | S0-SL2-4F1-320 | | STONE ARM TUBE | 74 | S0-0B6-001-440 | | PRESS SET |
| 9 | S0-SL3-4F2-320 | | HEADSHELL | 75 | SP-XE8-508-500 | | DECORATIVE PLATE |
| 10 | S2-E27-BK0-480 | | CARTRIDGE(W/STYLUS) | 76 | S8-60L-HA8-970 | | SPEED KNOB(PXE860) |
| 10-1S1-E27-BK0-230 | | | STYLUS | 77 | S3-SL2-4F0-110 | | MICRO SWITCH |
| 10-2S0-0B6-011-800 | | | STYLUS COVER | 78 | S3-SL2-4F0-760 | | SPRING |
| 11 | S8-E27-BK0-190 | | SIGNAL WIRE | 79 | SP-XE8-508-980 | | START KNOB(PXE860) |
| 12 | S0-930-040-160 | | AC CORD(E)<EZ> | 80 | SP-XE8-508-990 | | CUT KNOB(PXE860) |
| ▲ | 12 | SH-MD5-00B-037 | AC CORD(K)<K> | 81 | SP-XE8-501-820 | | SPR |
| ▲ | 12 | SC-132-0FA-034 | AC CORD(U)<U> | 82 | SP-XE8-501-830 | | SPR |
| 13 | S3-SL2-4F0-670 | | SPRING | 83 | S0-SL2-4F2-340 | | PENDULUM(L) |
| 14 | S0-SL2-4F1-17A | | COPPER WASHER | 84 | S3-SL2-4F0-680 | | SPRING |
| 15 | S0-SL2-4F2-470 | | SELECT PLATE | 85 | S0-SL2-4F2-430 | | STATING SUPPORT |
| 16 | S0-6F2-000-130 | | CS WASHER (3M/M) | ▲ | 86 | S1-PXE-850-068 | POWER TRANS(EZ)<EZ> |
| 17 | S3-SL2-4F0-690 | | SPRING | ▲ | 86 | SP-XE8-50K-070 | POWER TRANS(K)<K> |
| 18 | S0-SL2-4F2-380 | | LIFTER | ▲ | 86 | SP-XE8-50U-067 | POWER TRANS(U)<U> |
| 19 | S0-3MD-260-590 | | SPRING | ▲ | 87 | _____ | POWER P.C.B Assy |
| 20 | S4-PXE-900-720 | | PLATTER MAT | 88 | S0-PXE-903-320 | | FOOT RING |
| 21 | SP-XE8-508-950 | | DUST COVER | 89 | S4-SL2-4F0-360 | | RUBBER FOOT |
| 22 | S6-SL2-4F0-570 | | WASHER METAL 3-10-0.5 | 90 | S8-60K-C18-060 | | CUE KNOB SHAFT BASE(PXE860) |
| 23 | S0-SL2-4F1-300 | | FRICTION LINK | 91 | _____ | | DUAL PREAMP P.C.B |
| 24 | S0-SL2-4F1-310 | | ACTUATING LINK | A | 87-741-072-410 | | SCREW,UT2+2.6-5 |
| 25 | S0-6B3-000-290 | | E-RING WASHER 1.5MM | B | S6-SL2-4F0-550 | | WASHER |
| 26 | S3-SL2-4F0-770 | | SPRING | C | 87-761-095-410 | | SCREW VFT2+3-8 |
| 27 | S0-0F7-002-280 | | PLATTER TARNTABULE | D | 87-751-095-410 | | SCREW VT2+3-8 |
| 28 | S0-SL2-4F2-480 | | CAM GEAR | E | 87-761-097-410 | | SCREW VFT2+3-12 |
| 29 | S4-PXE-900-760 | | BELT | F | 87-751-096-410 | | SCREW VT2+3-10 |
| 30 | S3-SL2-4F0-500 | | CAM GEAR CONTROL ASSY | G | 87-751-074-410 | | SCREW VT2+2.6-8 |
| 31 | S3-SL2-4F0-490 | | RETURN LINK ASS'Y | H | S2-SL2-4F0-930 | | SCREW |
| 32 | S0-0H2-000-160 | | ADAPTOR 45RPM | I | 87-761-096-410 | | SCREW VFT2+3-10 |
| 33 | S4-SL2-4F0-380 | | RUBBER FOOT FOR MOTOR | J | 87-481-097-410 | | SCREW VWS+3-12 |
| 34 | S0-SL2-4F2-440 | | SMALL GEAR | K | 87-481-103-410 | | SCREW VWS+3-24 |
| 35 | S2-PXE-900-090 | | PLATER SHAFT ASS'Y | L | S0-6F2-000-060 | | WASHER |
| 36 | S3-SL2-4F0-510 | | PLATE SHAFT SET ASY | M | S0-6F2-000-110 | | E-RING WASHER (3M/M) |
| 37 | S0-7B6-000-020 | | STEEL BALL | N | S0-6F2-000-120 | | E-RING WASHER (5M/M) |
| 38 | S0-SL2-4F2-360 | | SELECT RECORD KNOB | O | S6-SL2-4F0-580 | | WASHER |
| 39 | SP-EX8-508-500 | | DECORATIVE PLATE | P | 87-261-097-410 | | SCREW V+3-12 |
| 40 | S8-55L-HA8-940 | | BASE | Q | 87-261-074-410 | | SCREW,V+2.6-8 |
| 41 | S4-SL2-4F0-390 | | RUBBER CAP | R | S6-DP3-6F0-640 | | WASHER\ |
| 42 | S0-SL2-4F1-140 | | SHAFT | | | | |
| 43 | S6-SL2-4F0-560 | | WASHER METAL 5-8-0.5 | | | | |
| 44 | S3-SL2-4F0-780 | | SPRING | | | | |
| 45 | S0-SL2-4F2-410 | | LIFTER SET | | | | |
| 46 | S3-SL2-4F0-720 | | SPRING | | | | |
| 47 | S0-SL2-4F1-120 | | SHAFT | | | | |
| 48 | S3-SL2-4F0-520 | | CUEING LEVER ASSY | | | | |
| 49 | S0-6B3-000-390 | | SPRING WASHER METAL 3-5-1 | | | | |
| 50 | S1-A10-000-400 | | NUT | | | | |
| 51 | S0-SL2-4F2-390 | | FIEXING SWITCH SET | | | | |
| 52 | S3-SL2-4F0-160 | | SW,MICRO | | | | |
| 53 | _____ | | CONDENSOR | | | | |
| 54 | S0-6D2-000-510 | | SPRING WASHER METAL 3-6-1 | | | | |
| 55 | S0-SL2-4F1-130 | | SHAFT | | | | |
| 56 | S0-SL2-4F1-160 | | SHAFT | | | | |
| 57 | S3-SL2-4F0-790 | | SPRING | | | | |
| 58 | S0-6H2-000-190 | | WASHER METAL 3-5-1 | | | | |
| 59 | S0-SL2-4F2-420 | | STATING LEVER | | | | |
| 60 | S0-SL2-4F2-350 | | PENDULUM(M) | | | | |
| 61 | S0-3L1-001-030 | | SPRING | | | | |
| 62 | S0-0F7-002-720 | | OIL SHAFT SET | | | | |
| 63 | S0-SL2-4F1-260 | | CONTROL PLATE | | | | |
| 64 | SP-XE8-501-840 | | SPR, FOR CUE | | | | |
| 65 | S0-3B6-000-400 | | SPRING | | | | |
| 66 | S0-SL2-4F2-450 | | SELECTOR | | | | |

COLOR NAME TABLE

| Basic color symbol | Color | Basic color symbol | Color | Basic color symbol | Color |
|--------------------|--------|--------------------|--------------|--------------------|--------|
| B | Black | C | Cream | D | Orange |
| G | Green | H | Gray | L | Blue |
| N | Gold | P | Pink | R | Red |
| S | Silver | ST | Titan Silver | T | Brown |
| V | Violet | W | White | Y | Yellow |

| サービス技術ニュース | |
|------------|------|
| 番号 | 連絡内容 |
| G- - | |
| G- - | |
| G- - | |

アイワ株式会社 〒110 東京都台東区池之端1-2-11 ☎03 (3827) 3111 (代表)
AIWA CO.,LTD. 2-11, IKENOHATA 1-CHOME, TAITO-KU, TOKYO 110, JAPAN TEL:03 (3827) 3111