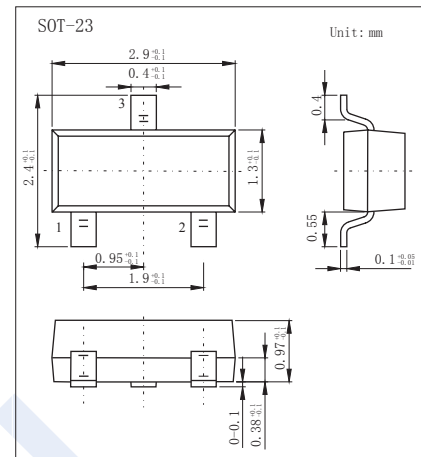
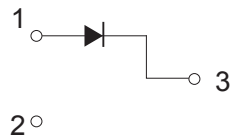

## Schottky Diodes

## RB491D (KB491D)

## ■ Features

- Small surface mounting type
- Low Forward Voltage
- Low Reverse Current
- High Reliability

■ Absolute Maximum Ratings  $T_a = 25^\circ\text{C}$ 

Parameter	Symbol	Rating	Unit
Peak Reverse Voltage	$V_{RRM}$	25	V
DC Reverse Voltage	$V_R$	20	
Mean Rectifying Current	$I_F$	1	A
Peak Forward Surge Current	$I_{FSM}$	3	
Junction Temperature	$T_J$	150	$^\circ\text{C}$
Storage Temperature range	$T_{stg}$	-55 to 150	

■ Electrical Characteristics  $T_a = 25^\circ\text{C}$ 

Parameter	Symbol	Test Conditions	Min	Typ	Max	Unit
Reverse breakdown voltage	$V_R$	$I_R = 100 \mu\text{A}$	25			V
Forward voltage	$V_F$	$I_F = 1\text{A}$			0.45	
Reverse voltage leakage current	$I_R$	$V_R = 20\text{V}$			200	$\mu\text{A}$

## ■ Marking

Marking	D2E
---------	-----