

Schottky Barrier Diode

RB501V-40

FEATURES

- High current rectifier schottky diode
- Low voltage; Low inductance
- For power supply

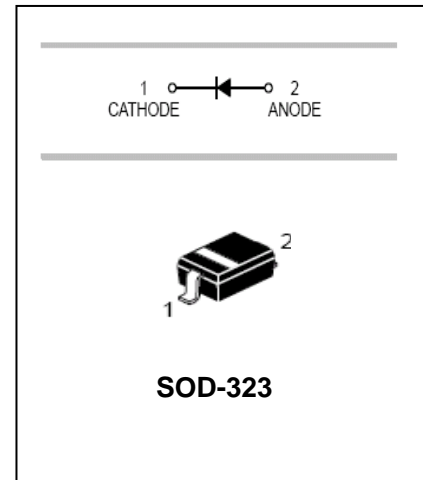

APPLICATIONS

- High frequency rectification

ORDERING INFORMATION

Type No.	Marking	Package Code
RB501V-40	4	SOD-323

MAXIMUM RATING @ Ta=25°C unless otherwise specified

Parameter	Symbol	Limits	Unit
Peak reverse voltage	V_{RM}	45	V
DC reverse voltage	V_R	40	V
Mean rectifying current	I_O	0.1	A
Peak forward surge current	I_{FSM}	1	A
Junction temperature	T_j	125	°C
Storage temperature	T_{stg}	-40 to+125	°C

ELECTRICAL CHARACTERISTICS @ Ta=25°C unless otherwise specified

Parameter	Symbol	Min.	Typ.	Max.	Unit	Conditions
Forward voltage	V_F			0.55 0.34	V	$I_F=100mA$ $I_F=10mA$
Reverse current	I_R			30	μA	$V_R=10v$
Capacitance between terminals	C_T		6		pF	$V_R=10V, f=1MHz$

Schottky Barrier Diode

RB501V-40

TYPICAL CHARACTERISTICS @ Ta=25°C unless otherwise specified

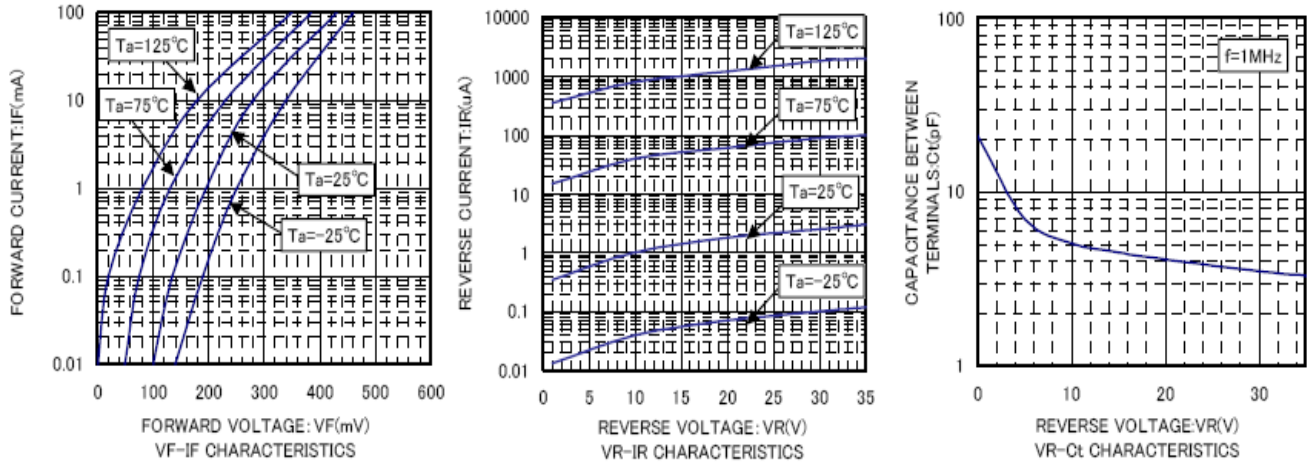

PACKAGE OUTLINE

Plastic surface mounted package

SOD-323

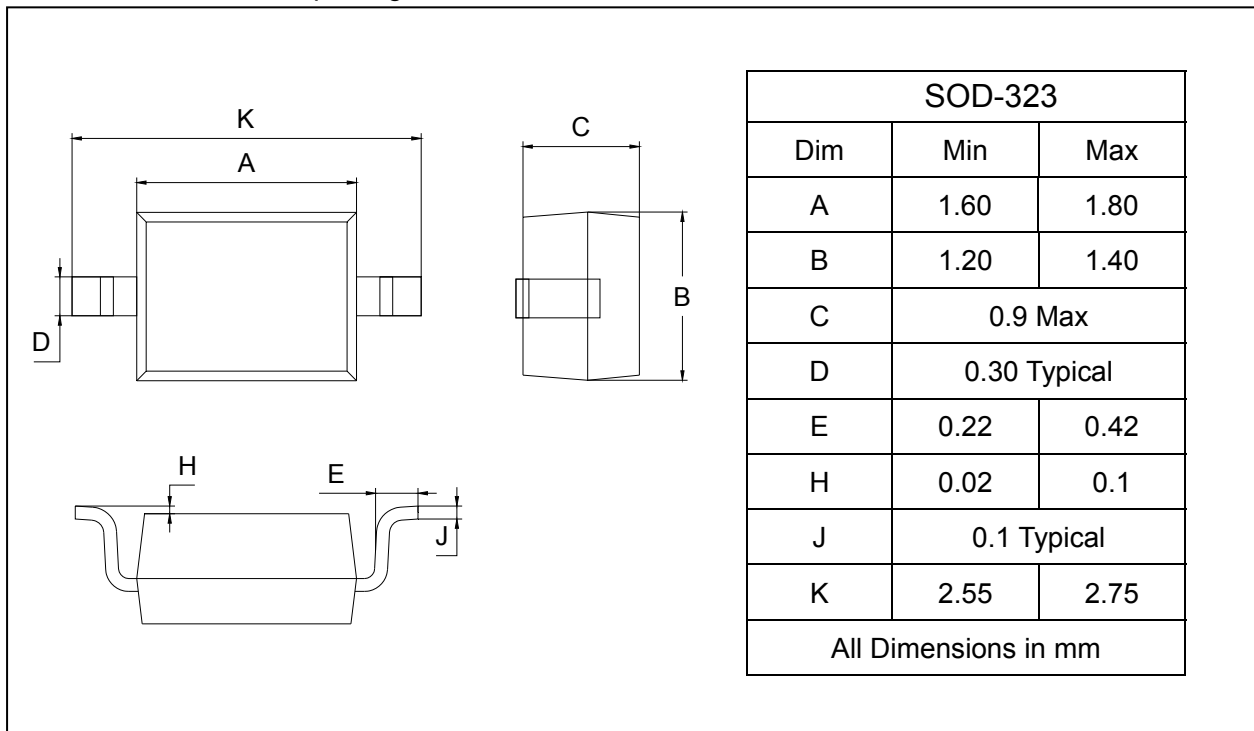

Schottky Barrier Diode

RB501V-40

SOLDERING FOOTPRINT

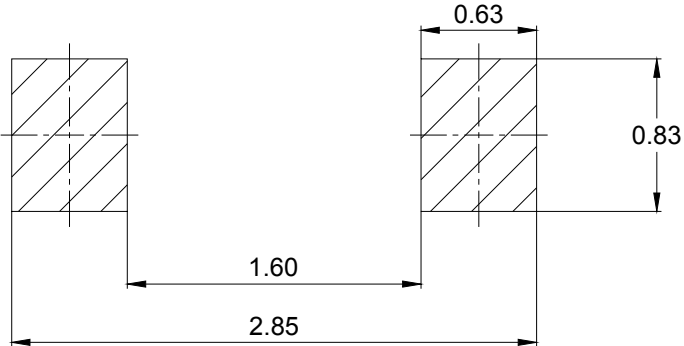

Unit : mm

PACKAGE INFORMATION

Device	Package	Shipping
RB501V-40	SOD-323	3000/Tape&Reel