

## SOD-523

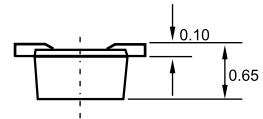
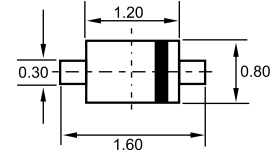

Dimensions in inches and (millimeters)

## FEATURES

- Small surface mounting type
- Low reverse current and low forward voltage
- High reliability

## Maximum Ratings and Electrical Characteristics, Single Diode @Ta=25°C

Parameter	Symbol	Limit	Unit
DC reverse voltage	$V_R$	30	V
Mean rectifying current	$I_O$	200	mA
Peak forward surge current	$I_{FSM}$	1	A
Power dissipation	$D_8$	150	mW
Thermal Resistance Junction to Ambient	$\theta_{JA}$	667	°C/W
Junction temperature	$T_j$	125	°C
Storage temperature	$T_{stg}$	-55~+150	°C

## Electrical Ratings @Ta=25°C

Parameter	Symbol	Min	Typ	Max	Unit	Conditions
Forward voltage	$V_F$			0.5	V	$I_F=200mA$
Reverse current	$I_R$			30	$\mu A$	$V_R=10V$

