

Schottky Barrier Diode

RB551V-30

FEATURES

- High current rectifier schottky diode
- Low voltage;Low inductance
- For power supply

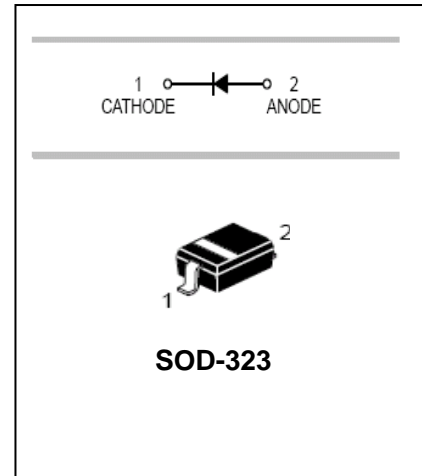

APPLICATIONS

- High frequency rectification

ORDERING INFORMATION

Type No.	Marking	Package Code
RB551V-30	D	SOD-323

MAXIMUM RATING @ Ta=25°C unless otherwise specified

Parameter	Symbol	Limits	Unit
Peak reverse voltage	V_{RM}	30	V
DC reverse voltage	V_R	20	V
Mean rectifying current	I_O	0.5	A
Peak forward surge current	I_{FSM}	2	A
Junction temperature	T_j	125	°C
Storage temperature	T_{stg}	-40 to +125	°C

ELECTRICAL CHARACTERISTICS @ Ta=25°C unless otherwise specified

Parameter	Symbol	Min.	Typ.	Max.	Unit	Conditions
Forward voltage	V_F			0.36 0.47	V	$I_F=100mA$ $I_F=500mA$
Reverse current	I_R			100	μA	$V_R=20v$

Schottky Barrier Diode

RB551V-30

TYPICAL CHARACTERISTICS @ Ta=25°C unless otherwise specified

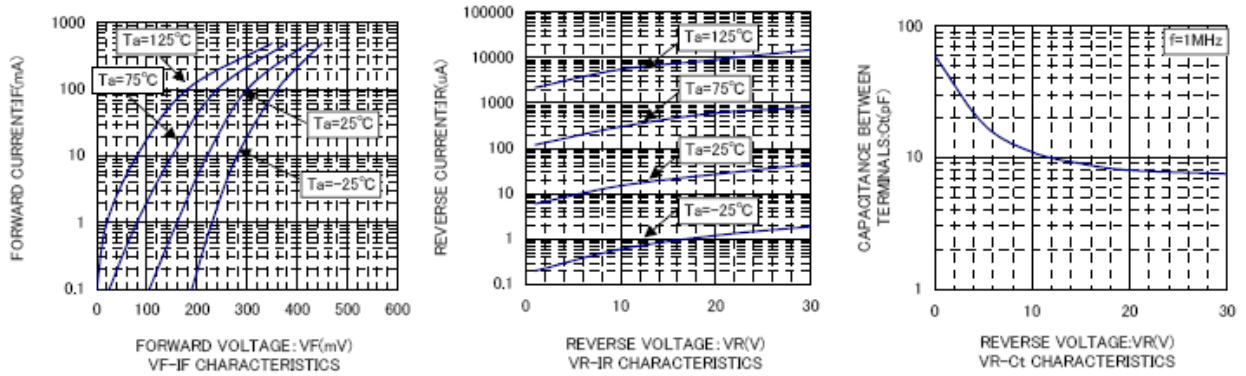

PACKAGE OUTLINE

Plastic surface mounted package

SOD-323

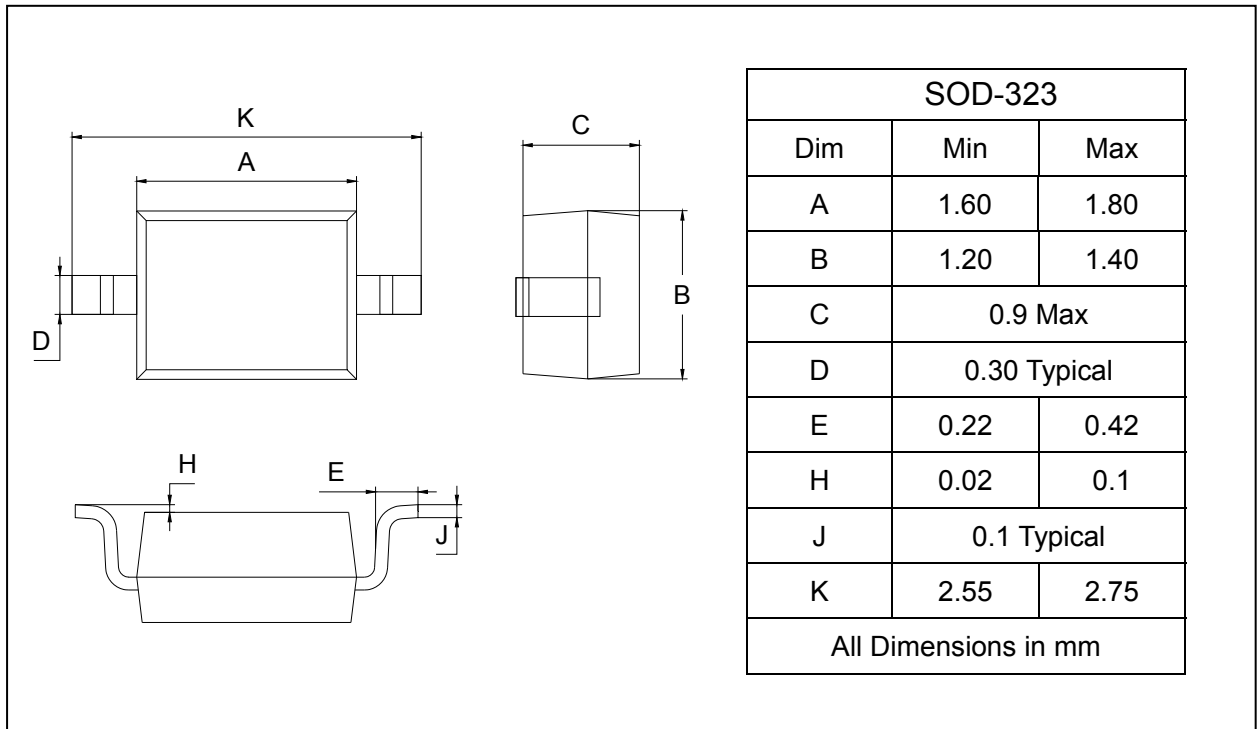

Schottky Barrier Diode

RB551V-30

SOLDERING FOOTPRINT

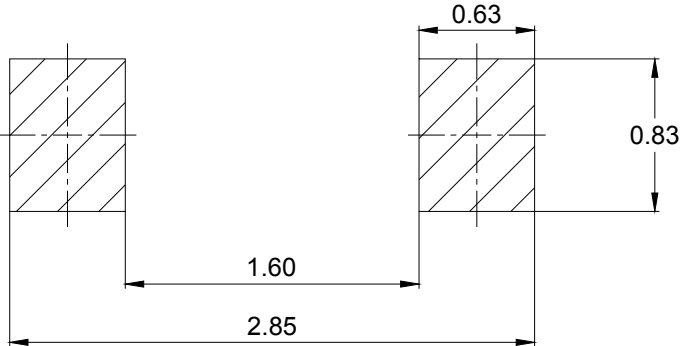

Unit : mm

PACKAGE INFORMATION

Device	Package	Shipping
RB551V-30	SOD-323	3000/Tape&Reel