



## SCHOTTKY BARRIER RECTIFIERS

### FEATURES

- High reliability
- Small mold type
- Super low IR

### MECHANICAL DATA

- Case: SOD-323FL
- Terminals: Solderable per MIL-STD-750, Method 2026
- Approx. Weight: 4.5mg / 0.00016oz

### PINNING

PIN	DESCRIPTION
1	Cathode
2	Anode

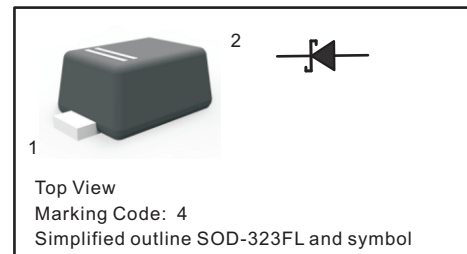

### Maximum Ratings and Electrical characteristics

Ratings at 25 °C ambient temperature unless otherwise specified.

Parameter	Symbols	RB578VAM100	Units
Peak Repetitive Reverse Voltage	$V_{RRM}$	100	V
DC Reverse Voltage	$V_R$	100	V
Maximum Average Forward Current at Ta=25°C	$I_O$	0.7	A
Peak Forward Surge Current, 8.3ms single half sine-wave superimposed on rated load (JEDEC method)	$I_{FSM}$	25	A
Maximum Instantaneous Forward Voltage	$V_F$	0.85 @ $I_F=0.7A$	V
Maximum DC Reverse Current at Rated DC Blocking Voltage	$I_R$	0.2 @ $V_R=100V$	uA
Storage and Operating Junction Temperature Range	$T_j, T_{stg}$	-55 ~ +125	°C



Fig.1 Forward Current Derating Curve

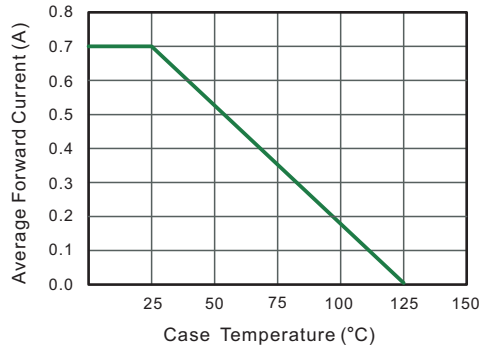

Fig.2 Typical Reverse Characteristics

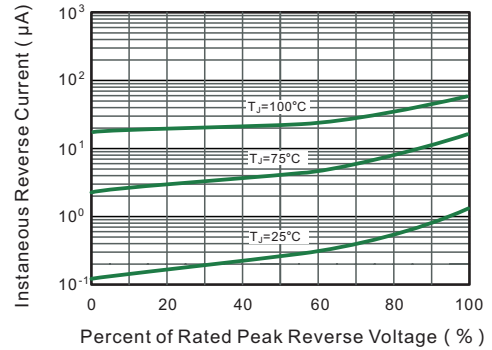

Fig.3 Typical Forward Characteristic

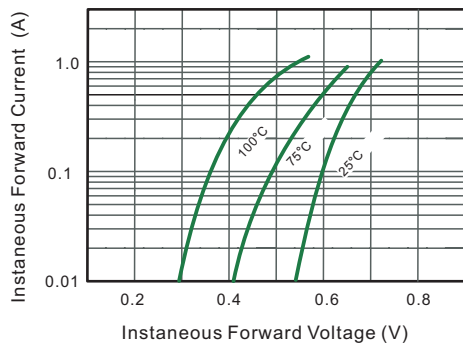

Fig.4 Typical Junction Capacitance

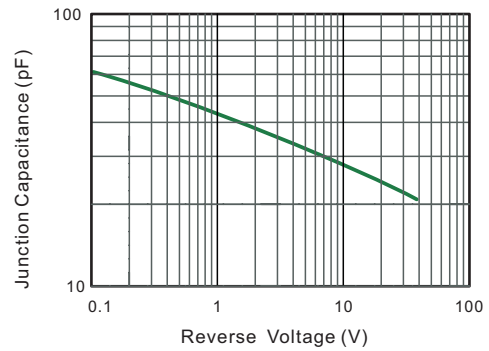
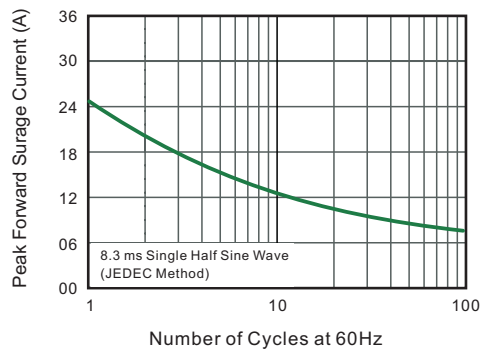

Fig.5 Maximum Non-Repetitive Peak Forward Surge Current





**PACKAGE OUTLINE**

Plastic surface mounted package; 2 leads

SOD-323FL

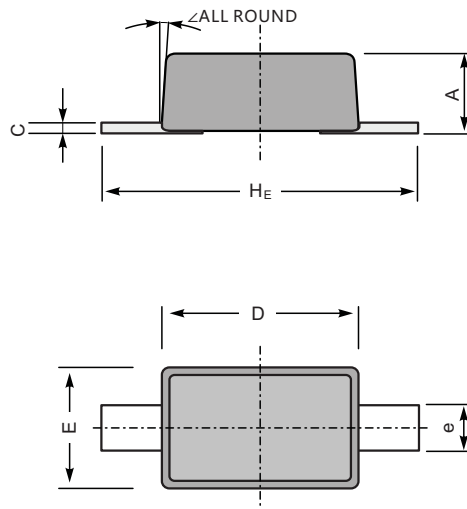

UNIT		A	C	D	E	e	H <sub>E</sub>	∠
mm	max	1.0	0.25	1.8	1.35	0.4	2.7	8°
	min	0.8	0.05	1.6	1.15	0.25	2.3	
mil	max	39	9.8	71	53	18	106	
	min	31	2.0	63	45	10	91	

**The recommended mounting pad size**

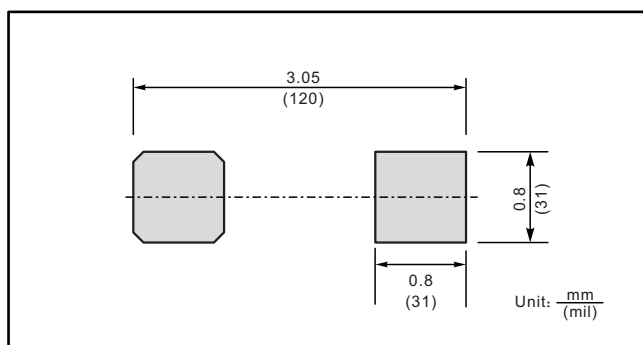

**Marking**

