

RC Series



Features

- Low cost
- Wide range of inductance
- High reliability

Product Identification

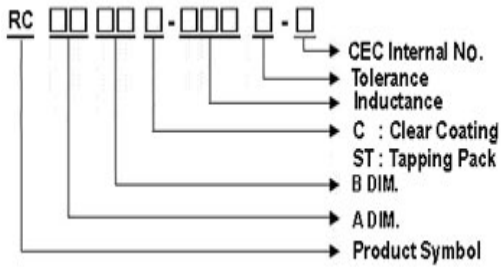

Electrical Parameters

Part Number	Inductance (mH)	Test Frequency (MHz)	Q Min	S.R.F (MHz) Min	D.C Resistance (W) Max	IDC (mA)
RC0508□-1R0K-N	1.0	7.96	30	155	0.186	1730
RC0508□-1R2K-N	1.2	7.96	30	145	0.15	1670
RC0508□-1R5K-N	1.5	7.96	30	130	0.16	1130
RC0508□-1R8K-N	1.8	7.96	30	115	0.17	1070
RC0508□-2R2K-N	2.2	7.96	30	105	0.19	1030
RC0508□-2R7K-N	2.7	7.96	30	95	0.21	960
RC0508□-3R3K-N	3.3	7.96	30	85	0.23	900
RC0508□-3R9K-N	3.9	7.96	30	80	0.25	860
RC0508□-4R7K-N	4.7	7.96	30	70	0.50	550
RC0508□-5R6K-N	5.6	7.96	30	65	0.55	530
RC0508□-6R8K-N	6.8	7.96	30	60	0.61	550
RC0508□-8R2K-N	8.2	7.96	30	55	0.88	480
RC0508□-100K-N	10	2.52	30	50	0.75	460
RC0508□-120K-N	12	2.52	30	48	0.82	460
RC0510 Series						
RC0510□-150K-N	15	2.52	30	45	0.83	430
RC0510□-180K-N	18	2.52	30	41	0.94	410
RC0510□-220K-N	22	2.52	30	35	1.20	390
RC0510□-270K-N	27	2.52	30	30	1.20	370
RC0510□-330K-N	33	2.52	30	32	1.30	370
RC0510□-390K-N	39	2.52	30	30	1.45	355
RC0512 Series						
RC0512□-470K-N	47	2.52	30	27	1.64	355
RC0512□-560K-N	56	2.52	30	24	1.75	320
RC0512□-680K-N	68	2.52	30	22	2.50	310
RC0512□-820K-N	82	2.52	30	20	3.50	290

Shapes and Dimensions

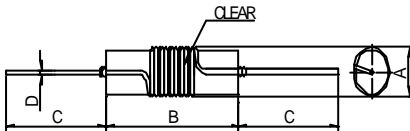

Dimension in mm

	RC0508	RC0510	RC0512
A	5 ⁺⁰		
B	8±0.5	10±0.5	12±0.5
C	25 ⁻⁰		
D	0.65∅		

- Note: lead-free
- CHILISIN uses UL tube on RC Series to avoid the damage when wave soldering.

- L.Q: HP4285+HP42851A
- SRF: HP4287A
- RDC: CHEN HWA502BC
- IDC: CHEN HWA CH1061+301A