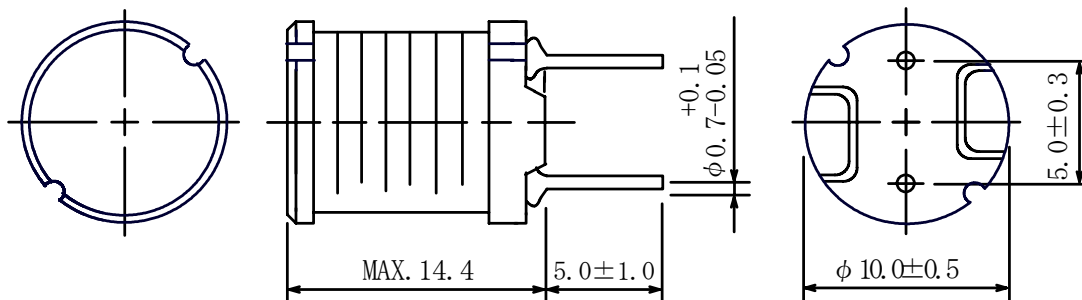

**Type: RCH-114**
**◆ Product Description**

- 10.5mm Max.  $\phi$ , 14.4mm Max. Height.
- Inductance Range:  $6.3 \mu\text{H} \sim 39\text{mH}$
- Rated current range:  $0.09 \sim 4.3\text{A}$
- In addition to the standard versions of inductors shown here, custom inductors are available to meet your exact requirements.

**◆ Feature**

- Magnetically unshielded construction.
- Ideally Used in Printers, LCD TV, DVD, Printer, Copy Machine, Mainboard of the compounding machines, etc as Power Supplies's Inductors or DC-DC Converter inductors.
- RoHS Compliance

**◆ Dimensions (mm)**

**Type: RCH-114**
**◆ Specification**

Part Name	Stamp	Inductance (Within) ※ 1	D.C.R.( $\Omega$ ) Max.(Typ.) at 20°C	Rated Current (A) ※2
RCH114NP-6R3MB	6R3	6.3 $\mu$ H $\pm$ 20 %	26m(20m)	4.3
RCH114NP-7R5MB	7R5	7.5 $\mu$ H $\pm$ 20 %	29m(22m)	4.2
RCH114NP-8R8MB	8R8	8.8 $\mu$ H $\pm$ 20 %	30m(23m)	4.1
RCH114NP-10 $\emptyset$ KB	100	10 $\mu$ H $\pm$ 10 %	33m(25m)	4.0
RCH114NP-12 $\emptyset$ KB	120	12 $\mu$ H $\pm$ 10 %	35m(27m)	3.9
RCH114NP-15 $\emptyset$ KB	150	15 $\mu$ H $\pm$ 10 %	39m(30m)	3.7
RCH114NP-18 $\emptyset$ KB	180	18 $\mu$ H $\pm$ 10 %	47m(36m)	3.5
RCH114NP-22 $\emptyset$ KB	220	22 $\mu$ H $\pm$ 10 %	51m(39m)	3.3
RCH114NP-27 $\emptyset$ KB	270	27 $\mu$ H $\pm$ 10 %	57m(44m)	3.1
RCH114NP-33 $\emptyset$ KB	330	33 $\mu$ H $\pm$ 10 %	64m(49m)	2.9
RCH114NP-39 $\emptyset$ KB	390	39 $\mu$ H $\pm$ 10 %	74m(57m)	2.7
RCH114NP-47 $\emptyset$ KB	470	47 $\mu$ H $\pm$ 10 %	83m(64m)	2.5
RCH114NP-56 $\emptyset$ KB	560	56 $\mu$ H $\pm$ 10 %	104m(80m)	2.3
RCH114NP-68 $\emptyset$ KB	680	68 $\mu$ H $\pm$ 10 %	117m(90m)	2.1
RCH114NP-82 $\emptyset$ KB	820	82 $\mu$ H $\pm$ 10 %	130m(100m)	1.9
RCH114NP-101KB	101	100 $\mu$ H $\pm$ 10 %	143m(110m)	1.7
RCH114NP-121KB	121	120 $\mu$ H $\pm$ 10 %	195m(150m)	1.5
RCH114NP-151KB	151	150 $\mu$ H $\pm$ 10 %	221m(170m)	1.4
RCH114NP-181KB	181	180 $\mu$ H $\pm$ 10 %	0.26(0.20)	1.3
RCH114NP-221KB	221	220 $\mu$ H $\pm$ 10 %	0.35(0.27)	1.2
RCH114NP-271KB	271	270 $\mu$ H $\pm$ 10 %	0.39(0.30)	1.1
RCH114NP-331KB	331	330 $\mu$ H $\pm$ 10 %	0.52(0.40)	1.0
RCH114NP-391KB	391	390 $\mu$ H $\pm$ 10 %	0.57(0.44)	0.92
RCH114NP-471KB	471	470 $\mu$ H $\pm$ 10 %	0.65(0.50)	0.84
RCH114NP-561KB	561	560 $\mu$ H $\pm$ 10 %	0.79(0.61)	0.75
RCH114NP-681KB	681	680 $\mu$ H $\pm$ 10 %	0.96(0.74)	0.69
RCH114NP-821KB	821	820 $\mu$ H $\pm$ 10 %	1.22(0.94)	0.62
RCH114NP-102KB	102	1.0 mH $\pm$ 10 %	1.6(1.3)	0.52
RCH114NP-122KB	122	1.2 mH $\pm$ 10 %	2.2(1.8)	0.46
RCH114NP-152KB	152	1.5 mH $\pm$ 10 %	2.5(2.0)	0.41
RCH114NP-182KB	182	1.8 mH $\pm$ 10 %	2.9(2.3)	0.36
RCH114NP-222KB	222	2.2 mH $\pm$ 10 %	3.2(2.6)	0.32
RCH114NP-272KB	272	2.7 mH $\pm$ 10 %	3.7(3.0)	0.29
RCH114NP-332KB	332	3.3 mH $\pm$ 10 %	5.0(4.0)	0.27
RCH114NP-392KB	392	3.9 mH $\pm$ 10 %	5.6(4.5)	0.25
RCH114NP-472KB	472	4.7 mH $\pm$ 10 %	7.4(5.9)	0.23
RCH114NP-562KB	562	5.6 mH $\pm$ 10 %	8.2(6.6)	0.21
RCH114NP-682KB	682	6.8 mH $\pm$ 10 %	11.9(9.5)	0.19
RCH114NP-822KB	822	8.2 mH $\pm$ 10 %	14(11)	0.17
RCH114NP-103KB	103	10 mH $\pm$ 10 %	16(13)	0.16
RCH114NP-123KB	123	12 mH $\pm$ 10 %	21(17)	0.15
RCH114NP-153KB	153	15 mH $\pm$ 10 %	24(19)	0.14
RCH114NP-183KB	183	18 mH $\pm$ 10 %	27(22)	0.13
RCH114NP-223KB	223	22 mH $\pm$ 10 %	34(27)	0.12
RCH114NP-273KB	273	27 mH $\pm$ 10 %	39(31)	0.11
RCH114NP-333KB	333	33 mH $\pm$ 10 %	51(41)	0.10
RCH114NP-393KB	393	39 mH $\pm$ 10 %	58(46)	0.09

※ 1: Measuring frequency : 6.3  $\mu$  H ~ 8.8  $\mu$  H at 7.96 MHz  
 10  $\mu$  H ~ 39 mH at 1.0 kHz

※ 2: Rated current: The DC current at which the inductance decreases 90% of its initial value or when  $\Delta t = 40^\circ\text{C}$ , whichever is lower ( $T_a = 20^\circ\text{C}$ )