



RF1301

499.250 MHz SAW Filter

- **Ideal Front-End Filter for European Wireless Receivers**
- **Low-Loss, Coupled-Resonator Quartz Design**
- **Simple External Impedance Matching**
- **Rugged TO39 Hermetic Package**
- **Complies with Directive 2002/95/EC (RoHS)**



The RF1301 is a low-loss, compact and economical surface-acoustic-wave (SAW) filter designed to provide front-end selectivity in 499.250 MHz receivers. Typical applications of these FSK receivers are wireless remote-control and security devices operating in Europe.

RFM's advanced SAW design and fabrication technology is utilized to achieve high performance and very low loss with simple external impedance matching (not included). Quartz construction provides excellent frequency stability over a wide temperature range.

Absolute Maximum Ratings

Rating	Value	Units
Incident RF Power	+13	dBm
DC Voltage Between Any Two Pins (Observe ESD Precautions)	±30	VDC
Case Temperature	-40 to +85	°C



Electrical Characteristics

Characteristic	Sym	Notes	Minimum	Typical	Maximum	Units
Nominal Frequency	f_C	2, 4, 5, 6		499.250		MHz
Insertion Loss	IL	3, 4, 7			4.0	dB
4 dB Passband	BW_3	2, 3, 4, 7	±30			kHz
3 dB Reject Band	BW_3	2, 3, 4, 7				kHz
Rejection	at $f_C \pm 1.50$ MHz	4			10	dB
	at $f_C \pm 6.0$ MHz				25	
	at $f_C \pm 50$ MHz					
Temperature	Operating Case Temperature	T_C	-40		+85	°C
	Turnover Temperature	T_O	15	25	40	°C
	Turnover Frequency	f_O		f_C		MHz
	Frequency Temperature Coefficient	FTC	3, 7, 8		0.032	ppm/°C ²
Frequency Aging	Absolute Value during the First Year	fAI		10		ppm/yr
External Impedance	Series Inductance	L		22		nH
	Shunt Capacitance	C	1, 7	5-18		pF
Lid Symbolization (in addition to Lot and/or Date Codes)			RFM RF1301			



CAUTION: Electrostatic Sensitive Device. Observe precautions for handling.

Notes:

1. Typical test circuit is shown for TO-39 RF filters.
2. Passband and reject bands are specified in reference to f_C .
3. All characteristics are specified over the operating temperature range and typical aging for 10 years.
4. Unless noted otherwise, all measurements are made with the filter installed in the specified test fixture. Note that insertion loss, bandwidth, and passband shape are dependent on the impedance matching component values and quality. Demonstration circuits are available for confirmation of device performance.
5. One or more of the following U.S. Patents apply: 4,454,488; 4,616,197; and other pending.
6. All equipment designs utilizing this product must be approved by the appropriate government agency prior to manufacture or sale.
7. The design, manufacturing process, and specifications of this device are subject to change without notice.
8. The turnover temperature, T_O , is the temperature of maximum (or turnover) frequency, f_O . The nominal frequency at any case temperature, T_C , outside the operating temperature range may be calculated from: $f = f_O [1 - FTC (T_O - T_C)^2]$.

Typical Filter Response

Typical filter responses are shown below. Illustrated frequencies and minimum rejection for LO and IMAGE are shown only for superhet receivers with 10.7 MHz IF.

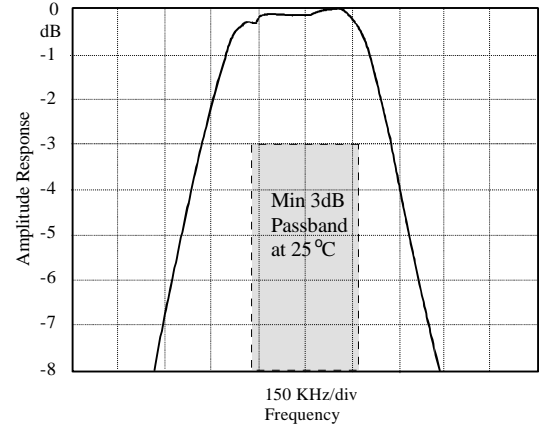
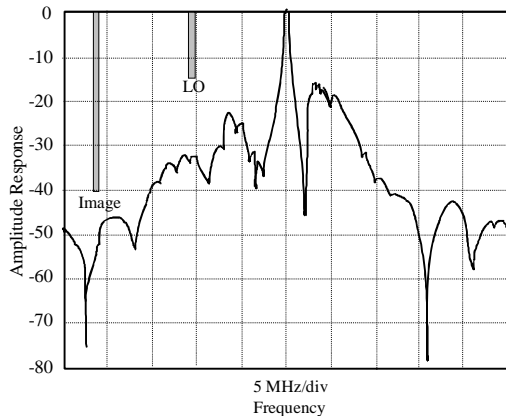

Electrical Connections

Pin	Connection
1	Input or Output
2	Output or Input
3	Case Ground

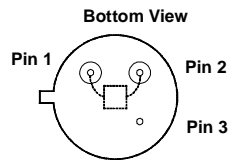

Case Design

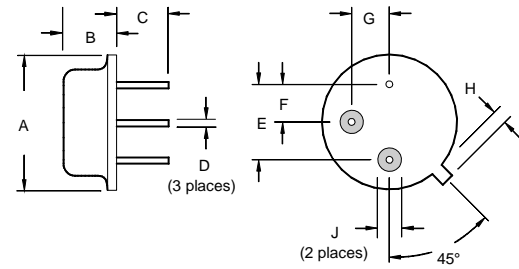

Typical Test Circuit

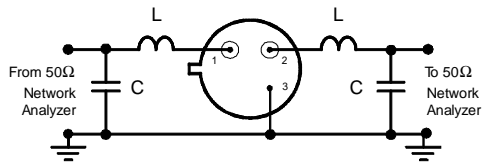

Dimensions	Millimeters		Inches	
	Min	Max	Min	Max
A		9.40		0.370
B		3.18		0.125
C	2.50	3.50	0.098	0.138
D	0.46 Nominal		0.018 Nominal	
E	5.08 Nominal		0.200 Nominal	
F	2.54 Nominal		0.100 Nominal	
G	2.54 Nominal		0.100 Nominal	
H		1.02		0.040
J	1.40		0.055	