

# Model RJ-13

www.DataSheet4U.com

## Single Turn Trimming Potentiometer 13mm Round, Cermet

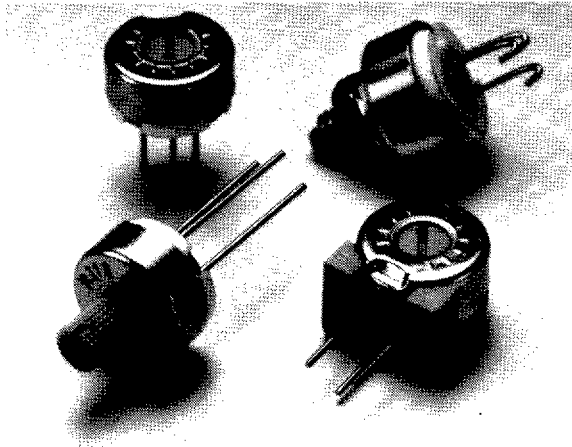

### Features

- Sealed to Allow for Automatic Processing
- Precious Metal Contact

### Part Number

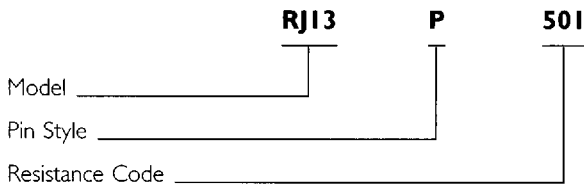

### Marking

Units Marked With Model Number, Resistance Code, and Date Code

### Packaging

Bulk Pack

Standard Resistance Values and Codes			
Ω	Code	Ω	Code
10	100	20 K	203
20	200	25 K	253
50	500	50 K	503
100	101	100 K	104
200	201	200 K	204
500	501	250 K	254
1 K	102	500 K	504
2 K	202	1 M	105
5 K	502	2 M	205
10 K	103	5 M	505

### SPECIFICATIONS

#### Electrical

Resistance Range	: 10 Ohms to 5 Meg. Ohms
Resistance Tolerance	: ± 10% Standard
Temp. Coeff. Of Resistance	: 50 Ohms to 2 Meg. ± 100 ppm/°C others ± 250 ppm/°C.
Power Rating	: 3/4 Watt at 70°C
Operating Voltage Max.	: 300 VDC or Power Rating, whichever is less.
Wiper Current Max.	: 100 mA or power rating, whichever is less.
Electrical Angle	: 230° Nominal.
Electrical Continuity	: Continuous over full mechanical range.
End Resistance	: 1% or 2 Ohms, whichever is greater.
Resolution	: Essentially infinite.
Contact Resistance Variation	: 1% or 3 Ohms, whichever is greater.
Operating Temp. Range	: -55°C to +125°C.
Insulation Resistance, Min.	: Min. 1000 Meg. at 500 VDC for 2 minutes.
Dielectric Strength	: 900 VAC rms, 1 minute, 1 milliamp max.

#### Mechanical

Mechanical Angle, Nominal	: 270° Nominal
Operating Torque	: 350 gram-cm (4.86 Oz-in.) max.
Stop Strength, Min.	: 1 Kilogram-cm max.
Terminal Strength, Min.	: 2 Kg
Rotational Life	: 200 cycles
	10 Ω to 200 Ω, ▲ R/R ≤ 0.5 Ω +3%
	500 Ω to 2 MΩ, ▲ R/R ≤ 0.5 Ω +2%

#### Environmental (MIL-R-22097)

<b>Thermal Shock:</b> (-65°C to 125°C)	▲ R/R ≤ 1.00% ▲ SS ≤ 1.00%
<b>Humidity:</b> (80 - 98% RH, 240 Hrs.)	▲ R/R ≤ 1.00%
<b>Mech. Shock:</b> (100 g)	▲ R/R ≤ 1.00% ▲ SS ≤ 1.00%
<b>Vibration:</b> (20 g, 10 to 2000 Hz.)	▲ R/R ≤ 1.00% ▲ SS ≤ 1.00%
<b>Low Temp. Operation:</b> (-55°C, 2 Hrs.)	▲ R/R ≤ 1.00% ▲ SS ≤ 2.00%
<b>High Temp. Exposure:</b> (125°C, 250 Hrs.)	▲ R/R ≤ 2.00% ▲ SS ≤ 2.00%
<b>Load Life:</b> (70°C, 0.75 W, 1000 Hrs.)	▲ R/R ≤ 2.00% ▲ SS ≤ 1.00%
<b>Soldering Heat:</b> (350°C, 3 Sec.)	▲ R/R ≤ 1.00%
<b>Immersion:</b>	Fluorocarbon, 24 Hrs., 100°C

# RJ-13

Single Turn Sealed Cermet

## RJ-13P Top Adjust

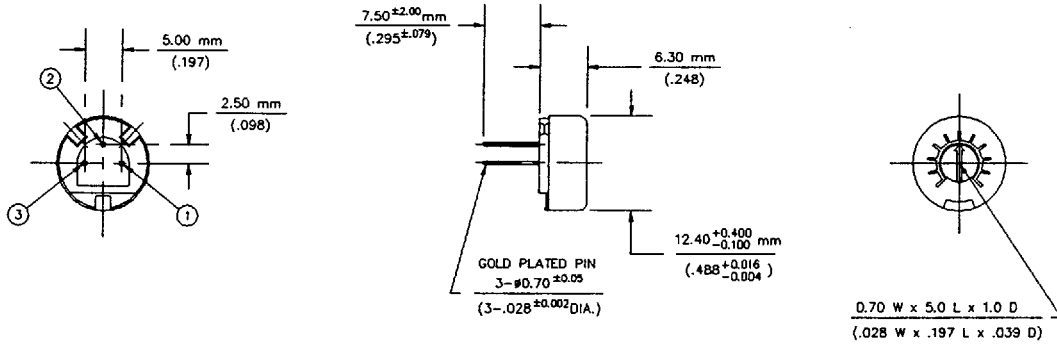

## RJ-13S Side Adjust

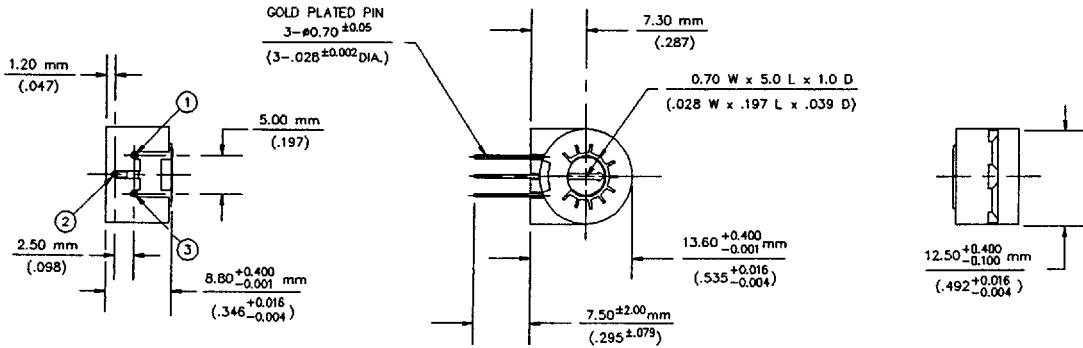

## RJ-13B Panel Mount

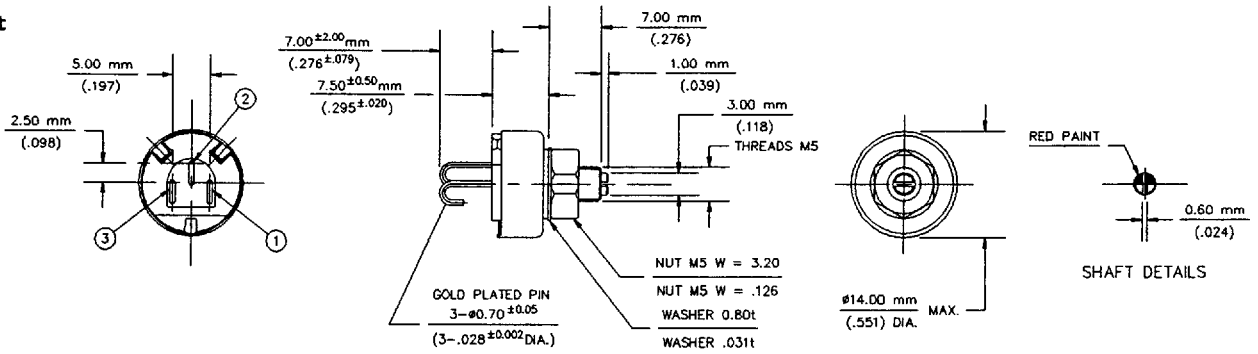

## RJ-13PR Top Adjust With Knob

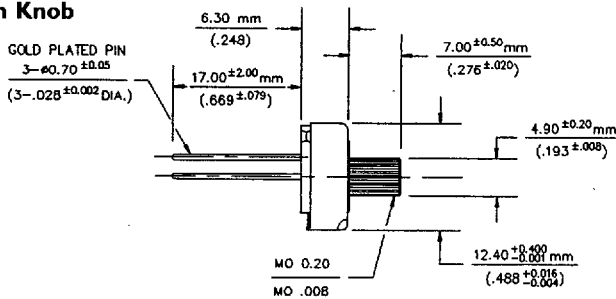

## RJ-13SR Side Adjust With Knob

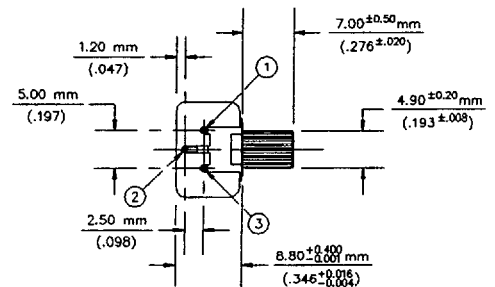

### Metric

- Dimensions are in millimeters (inches in parentheses are for reference only).
- Tolerances unless otherwise specified +/- 0.30 mm (+/- .012 inches).

