

## Rack LCD

### 15" 1U Rack Mount Adjustable Display

The Rm5101 is a 15" LCD display that saves rack space. Its unique design allows the user to adjust the angle of tilt from 0 to about 125 degrees.



### RM5101

#### Specifications

Display Area(mm)	304.1(H)x228.1(V) (15.0-inch diagonal)
Pixel Pitch	0.297(H)x0.297(V)
Number of Pixels	1024(H)x768(V)
Contrast Ratio	500:1(typ.)
Display Color	16.2M(6 bit+FRC)
Brightness(cd/m <sup>2</sup> )	250(typ.)
Input Signal	RGB Analog
I/O	Power:12V AC adapter(built-in) VGA:15-pin D-Sub Speaker-in(optional)
Power Consumption	25 Watts
Power Supply	AC 100-240V Universal
On-Screen Display	Contrast, Brightness, H/V Position, H/V Size, H-Scaling, Auto-adjust, Color Temp. (9300,6500, User), Red-Gain, Green-Gain, Blue-Gain,Gamma,Recall,Phase,Channel,OSD exit
Hot Key Control	OSD Hotkey
Temperature	0°C~50°C in operating; -20°C~60°C in storage
Humidity	10~85% in operating; 10-90% in storage

Rev.	Reasons	Revised Date
1.0	spec change	Nov-11-08
1.1	spec change	Dec-20-10

## Rack LCD

### Mechanical Drawing

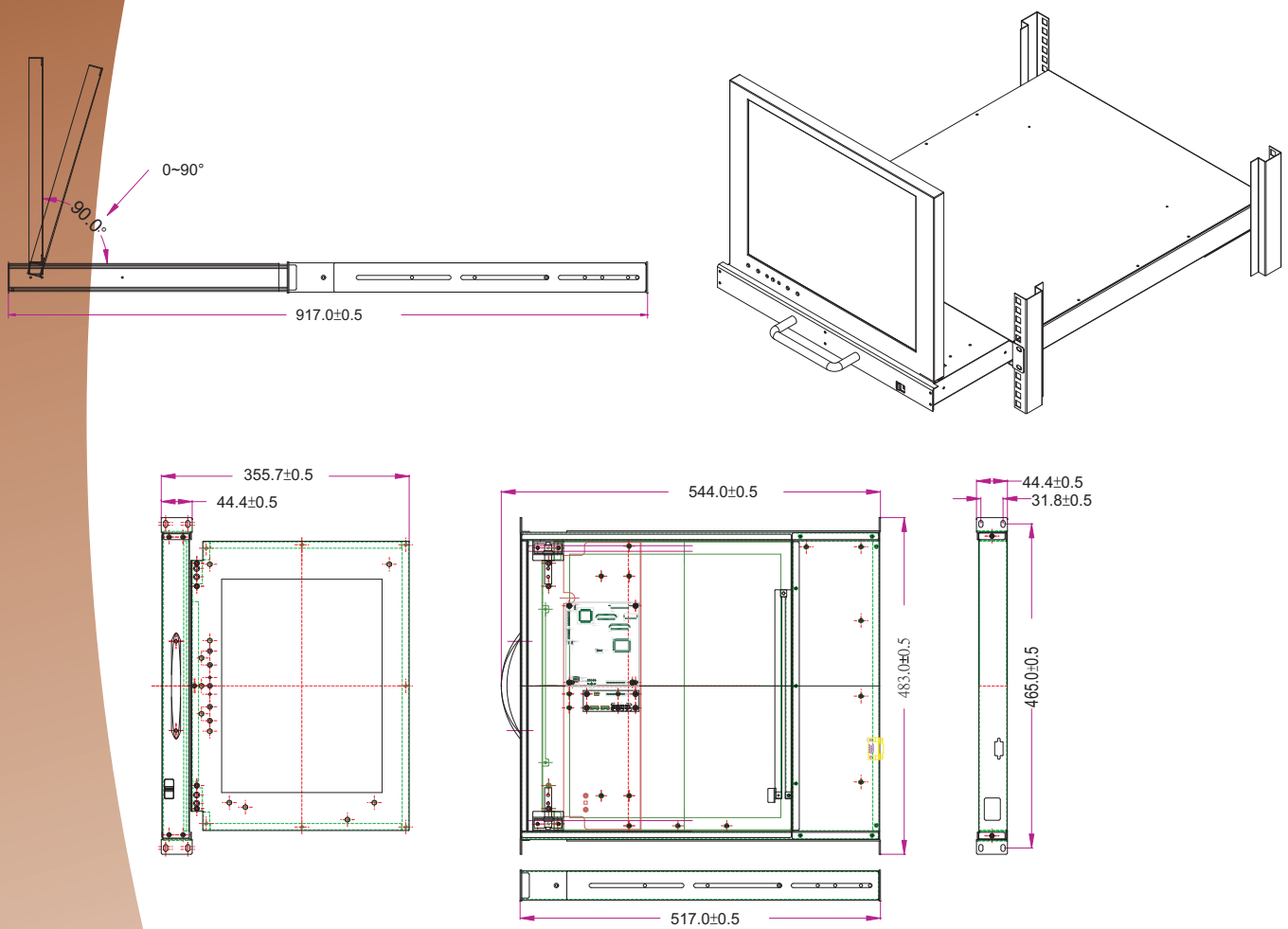

UNIT:mm

\* Note: this is a simplified drawing and some components are not marked in detail. Please contact our sales representative if you need further product information.